

RECORDED DELIVERY

RIBBLE VALLEY BOROUGH COUNCIL  
TREE PRESERVATION ORDER NO. 129

---

TO: Mr and Mrs Haworth

of: Throstle Croft, Saccary Lane, Mellor, Blackburn, Lancashire

NOTICE IS HEREBY GIVEN that on the 29 April 1993, The Ribble Valley Borough Council Tree Preservation Order No. 129 was made.

A certified copy of the enclosed Order and of the map referred to therein may be inspected during normal office hours at the Chief Executive's Department, Council Offices, Church Walk, Clitheroe BB7 2RA. A Statement of the Reasons for which the council think that the Order should be confirmed is also attached to this Notice.

Any objections or representations in respect of the Order may be in writing to the Chief Executive, Ribble Valley Borough Council, Council Offices, Church Walk, Clitheroe, BB7 2RA within twenty-eight days of the service of this Notice. Every objection or representation should specify the particular trees, groups of trees, or area of woodlands in respect of which the objection or representation is made and include a statement of the grounds of the objection in accordance with Regulation 7 of the Town and Country Planning (Tree Preservation Order) (Amendment) Regulations 1981, a copy of which is set out below:-

- 7.(1) Every objection or representation with respect to an Order shall be made in writing to The Authority and shall state the grounds thereof and the name of the Authority who made the Order and specify the particular trees, groups of trees, or woodlands in respect of which it is made.
- (2) An objection or representation shall be duly made if it complies with Paragraph (1) of this Regulation and is received by The Authority within twenty-eight days from the date of the service of the Notice of the making of the Order.

This Tree Preservation Order contains a direction under Section 201 of the Town and Country Planning Act 1990, the effect of which is as follows:-

If it appears to a local planning authority that a Tree Preservation Order proposed to be made by that Authority should take effect immediately without previous confirmation, they may include in the Order as made by them a direction that this section shall apply to the Order.

Notwithstanding Section 199 (1) of this Act, an Order which contains such a direction shall take effect provisionally on such date as may be specified therein and shall continue in force by virtue of this section until -

- (a) The expiration of a period of six months beginning with the date on which the Order is made; or
- (b) the date on which the Order is confirmed, or in the case of an Order which the Authority have decided not to confirm the date of the relevant committee meeting, whichever first occurs

DATED this 29 day of April 1993

Council Offices  
Church Walk  
CLITHEROE  
Lancashire

  
CHIEF EXECUTIVE

REASONS FOR SERVING THE ORDER

The woodland area included in the Tree Preservation Order was planted by the grandfather of Mr Haworth and has developed into a woodland of some amenity value.

PERSONS ON WHOM THIS ORDER IS SERVED

Mr and Mrs Haworth, Throstle Croft, Saccary Lane, Mellor, Blackburn, Lancashire

COPIES OF THE ORDER TO:

Lancashire County Council, Planning Department.  
The Forestry Commission's Conservator.  
The District Valuer.

Dated 29 April 1993

TOWN AND COUNTRY PLANNING ACT 1990

**TREE PRESERVATION ORDER**

relating to

WOODLAND AT THROSTLE CROFT  
SACCARY LANE  
MELLOR

TOWN AND COUNTRY PLANNING ACT 1990

Insert title  
of Order

THROSTLE CROFT, SACCARY LANE, MELLOR

**TREE PRESERVATION ORDER, 1993**

Insert name of  
Local Planning  
Authority

RIBBLE VALLEY BOROUGH COUNCIL

in this Order called "the authority", in pursuance of the powers conferred in that behalf by s 198-200 [and s 201]<sup>1</sup> of the Town and Country Planning Act 1990 [and s 300 of the Town and Country Planning Act 1990<sup>2</sup>], and subject to the provisions of the Forestry Acts 1967 and 1979, hereby make the following Order -

1. In this Order:-

"the Act" means the Town and Country Planning Act 1990;

"owner" means the owner in fee simple, either in possession or who has granted a lease or tenancy of which the unexpired portion is less than three years; lessee (including a sub-lessee) or tenant in possession, the unexpired portion of whose lease or tenancy is three years or more; and a mortgagee in possession; and

"the Secretary of State" means the [Secretary of State for the Environment] [Secretary of State for Wales].

2. Subject to the provisions of this Order and to the exemptions specified in the Second Schedule hereto, no person shall, except with the consent of the authority and in accordance with the conditions, if any, imposed on such consent, cut down, top, lop, uproot, wilfully damage or wilfully destroy or cause or permit the cutting down, topping lopping, uprooting, wilful damage or wilful destruction of any tree specified in the first Schedule hereto or comprised in a group of trees or in a woodland therein specified, the position of which trees, groups of trees and woodlands is defined in the manner indicated in the said First Schedule on the map annexed hereto<sup>3</sup> which map shall, for the purpose of such definition as aforesaid, prevail where any ambiguity arises between it and the specification in the said First Schedule.

3. An application for consent made to the authority<sup>4</sup> under Article 2 of this Order shall be in writing stating the reasons for making the application, and shall by reference if necessary to a plan specify the trees to which the application relates, and the operations for the carrying out of which consent is required.

4. (1) Where an application for consent is made to the authority under this Order, the authority may grant such consent either unconditionally, or subject to such conditions (including conditions requiring the replacement of any tree by one or more trees on the site or in the immediate vicinity thereof), as the authority may think fit, or may refuse consent:

Provided that where the application relates to any woodland specified in the First Schedule to this Order the authority shall grant consent so far as accords with the principles of good forestry, except where, in the opinion of the authority, it is necessary in the interests of amenity to maintain the special character of the woodland or the woodland character of the area, and shall not impose conditions on such consent requiring replacement or replanting.

(2) The authority shall keep a register of all applications for consent under this Order containing information as to the nature of the application, the decision of the authority thereon, any compensation awarded in consequence of such decision and any directions as to replanting of woodlands; and every such register shall be available for inspection by the public at all reasonable hours.

5. Where the authority refuse consent under this Order or grant such consent subject to conditions they may when refusing or granting consent certify in respect of any trees for which they are so refusing or granting consent that they are satisfied -

- (a) that the refusal or condition is in the interests of good forestry; or
- (b) in the case of trees, other than trees comprised in a group of trees or in a woodland, that the trees have an outstanding or special amenity value; or
- (c) in the case of trees which are comprised in a group of trees or in a woodland, that the group of trees or the woodland, as the case may be, has an outstanding or special amenity value,

but a certificate shall not be given in the case of trees falling within (c) above if the application in respect of them has been referred by the Forestry Commissioners under section 15(1)9b) or 15(2)(a) of the Forestry Act 1967.

6. (1) Where consent is granted under this Order to fell any part of a woodland other than consent for silvicultural thinning then unless -

- (a) such consent is granted for the purpose of enabling development to be carried out in accordance with a permission to develop land under Part III of the Act, or
- (b) the authority with the approval of the Secretary of State dispense with replanting,

the authority shall give to the owner of the land on which that part of the woodland is situated a direction in writing specifying the manner in which and the time within which he shall replant such land and where such a direction is given and the part is felled the owner shall, subject to the provision of this Order and s 204 of the Act, replant the said land in accordance with the direction.

(2). Any direction given under paragraph (1) of this Article may include requirements as to -

- (a) species;
- (b) number of trees per acre (hectare);
- (c) the erection and maintenance of fencing necessary for protection of the replanting;
- (d) the preparation of ground, draining, removal of brushwood, lop and top; and
- (e) protective measures against fire.

7. On imposing any condition requiring the replacement of any tree under Article 4 of the Order, or on giving a direction under Article 6 of this Order with respect to the replanting of woodlands, the authority shall if such condition or direction relates to land in respect of which bye-laws made by a water authority (now a water or sewerage undertaker pursuant to s 4 of the Water Act 1989 and "undertaker") since 31 March 1974, by any other authority (whose functions are now exercised by an undertaker) who at any time prior to 1 April 1974 exercised the functions in respect of which the bye-law was made, by a drainage board, or by the Greater London Council in the exercise of its functions in relation to maintenance, improvement or construction of watercourses or of drainage works, restrict or regulate the planting or trees, notify the applicant or the owner of the land, as the case may be, of the existence of such bye-laws and that any such condition or direction has effect subject to the requirements of an undertaker or the drainage board under those bye-laws and the condition or direction shall have effect accordingly.

8. The provisions set out in the Third Schedule to this Order, being provisions of Part III of the Act adapted and modified for the purposes of this Order, shall apply in relation thereto.

9. Subject to the provisions of this Order, any person who has suffered loss or damage in consequence of any refusal (including revocation or modification) of consent under this Order or of any grant of any such consent subject to conditions, shall, if he makes a claim on the authority within the time and in the manner prescribed by this Order, be entitled to recover from the authority compensation in respect of such loss or damage:

Provided that no compensation shall be payable in respect of loss or damage suffered by reason of such refusal or grant of consent in the case of any trees the subject of a certificate in accordance with Article 5 of this Order.

10. In assessing compensation payable under the last preceding Article account shall be taken of:

- (a) any compensation or contribution which has been paid whether to the claimant or any other person, in respect of the same trees under the terms of this or any other Tree Preservation Order under s 198-200 of the Act, or under the terms of any Interim Preservation Order made under section 8 of the Town and Country Planning (Interim Development) Act 1943, or any compensation which has been paid or which could have been claimed under any provision relating to the preservation of trees or protection of woodlands contained in an operative scheme under the Town and Country Planning Act 1932, and
- (b) any injurious affection to any land of the owner which would result from the felling of trees the subject of the claim.

11. (1) A claim for compensation under this Order shall be in writing and shall be made by serving it on the authority, such service to be effected by addressing the claim to the authority and leaving it at or sending it by post to the principal office of the authority.

(2) The time within which any such claim shall be made as aforesaid shall be a period of twelve months from the date of the decision of the authority, or of the Secretary of State, as the case may be, or where an appeal has been made to the Secretary of State against the decision of the authority, from the date of the decision of the Secretary of State on the appeal.

12. Any question of disputed compensation shall be determined in accordance with the provisions of section 205 of the Act.

13. [(1) The provisions of section 201 of the Act shall apply to this Order and the Order shall take effect on 29 day of April 1993

[(2) This Order shall apply to any tree specified in the First Schedule hereto, which is to be planted as mentioned therein, as from the time when that tree is planted.]<sup>6</sup>

NOTE: Any person contravening the provisions of this Order by cutting down, uprooting or wilfully destroying a tree, or by wilfully damaging, topping or lopping a tree in such a manner as to be likely to destroy it is guilty of an offence and liable on summary conviction to a fine not exceeding the prescribed sum<sup>7</sup> for twice the sum which appears to the court to be the value of the tree, whichever is the greater, or on indictment to a fine. The penalty for any other contravention of this Order is a fine not exceeding Level 4 on the standard scale<sup>8</sup> on summary conviction and, in the case of a continuing offence when the contravention is continued after conviction, a person is liable on summary conviction to an additional fine not exceeding £5 for every day on which the contravention is so continued.

If a tree is removed, uprooted or destroyed in contravention of an Order or, except in the case of a tree to which the Order applies as part of a woodland, is removed, uprooted or destroyed or dies at a time when its cutting down or uprooting is authorised only by section 198(6) of the Act relating to trees which are dying or dead or have become dangerous, it is the duty of the owner of the land, unless on his application the local planning authority dispense with the requirement, to plant another tree of appropriate size and species at the same place as soon as he reasonably can. Except in emergency, not less than 5 days previous notice of the removal, etc, should be given to the authority to enable the latter to decide whether or not to dispense with the requirement. In respect of trees in a woodland it is sufficient to replace the trees removed, uprooted or destroyed by planting the same number of trees either on or near the land on which the trees removed, uprooted or destroyed stood or on such other land as may be agreed between the authority and the owner of the land, and (in either case) in such places as may be designated by the authority.

**FIRST SCHEDULE**  
**TREES SPECIFIED INDIVIDUALLY\***  
(encircled in black on the map)

No. on Map	Description	Situation
NONE	NONE	NONE

**TREES SPECIFIED BY REFERENCES TO AN AREA\***  
(within a dotted black line on the map)

No. on Map	Description	Situation
NONE	NONE	NONE

**GROUPS OF TREES\***  
(within a broken black line on the map)

No. on Map	Description	Situation
NONE	NONE	NONE

**WOODLANDS\***  
(within a continuous black line on the map)

No. on Map	Description	Situation
W1	Woodland area consisting of beech, lime, cherry, maple, sycamore, ash, birch, whitebeam, hawthorne, oak, alder, rowan, holly, chestnut	Woodland at Throstle Croft, Saccary Lane, Mellor

\* The word "NONE" must be entered where necessary

**SECOND SCHEDULE**

This Order shall not apply so as to require the consent of the authority to

- (3) the cutting down of any tree on land which is subject to a forestry dedication covenant where
- (a) any positive covenants on the part of the owner of the land contained in the same deed as the forestry dedication covenant and at the time of the cutting down binding on the then owner of the land are fulfilled;
  - (b) the cutting down is in accordance with a plan of operations approved by the Forestry Commission under such deed.
- (4) the cutting down of any tree which is in accordance with a plan of operations approved by the Forestry Commission under a grant scheme under section 1 of the Forestry Act 1979 except a scheme which applies to a forestry dedication covenant.



- (5) the cutting down, uprooting, topping or lopping of a tree
- (a) by or at the request of the Post Office where the land on which the tree is situated is land which has been acquired for the purpose of the Post Office's undertaking and either works on such land cannot otherwise be carried out or the cutting down, uprooting, topping or lopping is for the purpose of securing safety in the operation of the undertaking; or the lopping in pursuance of the power conferred on any operator of a telecommunications code system by virtue of paragraph 19 of Schedule 2 to the Telecommunications Act 1984;
- (b) by or at the request of
- (i) a statutory undertaker or holder of a licence under section 6(1) of the Electricity Act 1989 where the land on which the tree is situated is operational land as defined by the Act and either works on such land cannot otherwise be carried out or the cutting down, uprooting, topping or lopping is for the purpose of securing safety in the operation of the undertaking;
- (ii) a licence holder within the meaning of Part I of the Electricity Act 1989, where such tree obstructs the construction by the licence holder of any electric line within the meaning of Part I of the said Act of 1989 or interferes or would interfere with the maintenance or working of any such line;
- (iii) a water authority established under the Water Act 1973, the functions of which have been transferred to a water or sewerage undertaker pursuant to section 4 of the Water Act 1989 (an "undertaker") or a drainage board constituted or treated as having been constituted under the Land Drainage Act 1976, where the tree interferes or would interfere with the exercise of any of the functions of such undertaker or drainage board in relation to the maintenance, improvement or construction of water courses or of drainage works;
- (iv) the Secretary of State for Defence, the Secretary of State for Transport, the civil Aviation Authority, or in relation to any airport managed by a company to which any property, rights or liabilities have been transferred in pursuance of a scheme made under section 1 or 15 of the Airports Act 1986, the person for the time being having the management of the airport, where in the opinion of such Secretary of State, Authority or person the tree obstructs the approach of aircraft to, or their departure from, any airport or hinders the safe and efficient use of aviation or defence technical installations;
- (c) where immediately required for the purpose of carrying out development authorised by the planning permission granted on an application made under Part III of the Act, or deemed to have been so granted for any of the purposes of that Part;
- (d) which is a fruit tree cultivated for fruit production growing or standing on land comprised in an orchard or garden;

[Where the trees are within the Thames catchment area]

[(e) in pursuance of the powers of the Thames Water Authority (the functions of which have been transferred to a water or sewerage undertaker pursuant to section 4 of the Water Act 1989) under section 105 of the Thames Conservancy Act 1932.]

### THIRD SCHEDULE

Provisions of the following parts of Part III of the Town and Country Planning Act 1990 as adapted and modified to apply to this Order.

75. (1) Without prejudice to the following provisions as to the revocation or modification of consents, any consent under the Order, including any direction as to replanting given by the authority on the granting of such consent, shall (except in so far as the consent otherwise provides), enure for the benefit of the land and of all persons for the time being interested in it.

77. Reference of applications to the Secretary of State.

(1) The Secretary of State may give directions to the authority requiring applications for consent under the Order to be referred to him instead of being dealt with by the authority.

(2) A direction under this section may relate either to a particular application or to applications of a class specified in the direction.

(3) Any application in respect of which a direction under this section has effect shall be referred to the Secretary of State accordingly.

(4) Where an application for consent under the Order is referred to the Secretary of State under this section, the provisions of Articles 4 and 5 of the Order shall apply as they apply to an application which falls to be determined by the authority.

(5) Before determining an application referred to him under this section the Secretary of State shall, if either the applicant or the authority wish, give each of them an opportunity of appearing before, and being heard by, a person appointed by the Secretary of State for the purpose.

(7) The decision of the Secretary of State on any application referred to him under this section shall be final.

78. Right to Appeal against decisions and failure to take such decisions -

(1) Where the authority refuses an application for consent under the Order or grants it subject to conditions, or where any certificate or direction is given by the authority, the applicant may by notice appeal to the Secretary of State.

(2) A person who has made an application for consent under the Order may also appeal to the Secretary of State if the authority has neither:

- (a) given notice to the applicant of their decision on the application; nor
- (b) given notice to him that the application has been referred to the Secretary of State in accordance with directions given under section 77;

within two months from the date of receipt of the application, or within such extended period as may at any time be agreed upon in writing between the applicant and the authority.

(4) The time prescribed for the service of such a notice must be:

- (a) 28 days from the date of notification of the decision, certificate or direction, as the case may be; or
- (b) in the case of an appeal under sub-section (2), 28 days from the end of the said period of two months or as the case may be, the extended period mentioned in that sub-section.

(5) For the purposes of the application of section 79(1) in relation to an appeal under sub-section (2), it shall be assumed that the authority decided to refuse the application in question.

79. Determination of appeals -

(1) On an appeal under section 78 from a decision, certificate or direction of the authority, the Secretary of State may

- (a) allow or dismiss the appeal, or
- (b) reverse or vary any part of the decision of the authority (whether the appeal relates to that part of it or not, or may cancel any certificate or cancel or vary any direction)

and may deal with the application as if it had been made to him in the first instance.

(2) Before determining an appeal under section 78, the Secretary of State shall, if either the appellant or the authority so wish, give to each of them an opportunity of appearing before, and being heard by, a person appointed by the Secretary of State for the purpose.

(5) The decision of the Secretary of State on any appeal under this section shall be final.

97. Power to revoke or modify the consent under the Order -

(1) If it appears to the authority that it is expedient to revoke or modify any consent under the Order granted on an application made under Article 3 of the Order, the authority may by Order revoke or modify the consent to such extent as they consider expedient.

(3) The power conferred by this section to revoke or modify a consent may be exercised at any time before the operations for which consent has been given have been completed.

(4) The revocation or modification of consent shall not affect so much of those operations as has been previously carried out.

98. Procedure for s 97 orders : opposed cases -

(1) Except as provided in sections 99 and 201 of the Act an Order under section 97 shall not take effect unless it is confirmed by the Secretary of State;

(2) Where an authority submits an Order to the Secretary of State for his confirmation they shall service notice on:

- (a) the owner of the land affected;
- (b) the occupier of the land affected; and
- (c) any other person who in their opinion will be affected by the Order.

(3) The notice shall specify that within a period of twenty-eight days from the service of the notice any person on who it is served may require the Secretary of State to give him an opportunity of appearing before, and being heard by, a person appointed by the Secretary of State for the purpose.

(4) If within the period of twenty-eight days such a person so requires, before the Secretary of State confirms the Order, he shall given such an opportunity both to him and the authority.

(6) The Secretary of State may confirm any such Order submitted to him either without modification or subject to such modifications as he considers expedient.

99. Procedure for s 97 order : unopposed cases

(1) This section applies where:

- (a) the authority have made an Order under section 97; and
- (b) the owner and the occupier of the land and all persons who in the authority's opinion will be affected by the Order have notified the authority in writing that they do not object to it.

(2) Where this section applies, instead of submitting the Order to the Secretary of State for confirmation the authority shall advertise the fact that the Order has been made, and the advertisement must specify:

- (a) the period within which persons affected by the Order may give notice to the Secretary of State that they wish for an opportunity of appearing before, and being heard by, a person appointed by the Secretary of State for the purpose; and
- (b) the period at the expiration of which, if no such notice is given to the Secretary of State, the Order may take effect by virtue of this section without being confirmed by the Secretary of State

(3) The authority shall also serve notice to the same effect on the persons mentioned in sub-section (1)(b).

(4) The period referred to in sub-section (2)(b) must not be less than 14 days from the expiration of the period referred to in sub-section (2)(a).

(6) The authority shall send a copy of any advertisement published under sub-section (2) to the Secretary of State not more than three days after the publication.

(7) If:

- (a) no person claiming to be affected by the Order has given notice to the Secretary of State under sub-section (2)(a) within the period referred to in that sub-section, and
- (b) the Secretary of State has not directed within that period that the Order be submitted to him for confirmation,

the Order shall take effect at the expiry of the period referred to in sub-section (2)(b), without being confirmed by the Secretary of State as required by section 98(1).

(8) This section does not apply to an Order revoking or modifying a consent granted or deemed to have been granted by the Secretary of State under this Part of Part VII.

Given under the Common Seal of the

RIBBLE VALLEY BOROUGH COUNCIL

the 29 April 1993,



Mayor

*for*

Chief Executive

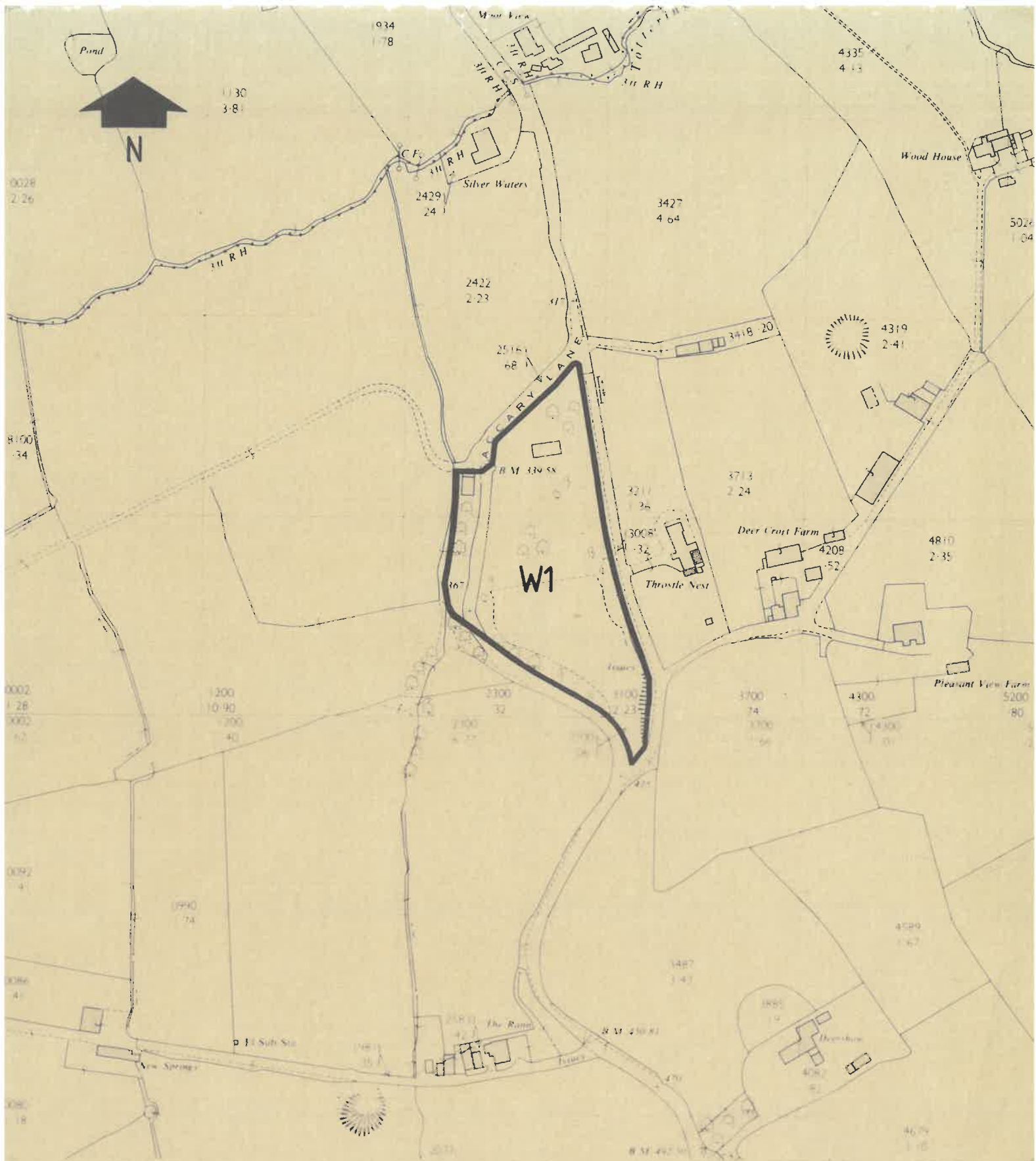

Ribble Valley Borough Council  
 Tree Preservation Order  
 Throstle Croft, Saccary Lane, Mellor.

scale  
 1 / 2500 th

drawing number  
 8:99:1

reference  
 DH

date  
 March 1993

Philip Bailey Dip. Arch., Dip.T.P. RIBA., MRTPI., MBIM. Director of Development  
 Ribble Valley Borough Council, Church Walk, Clitheroe, Lancs. BB7 2RA (STD 0200) 25111