

Form of Tree Preservation Order

Town and Country Planning Act 1990

The Langho 2022 Tree Preservation Order

The Ribble Valley Borough Council, in exercise of the powers conferred on them by section 198 of the Town and Country Planning Act 1990 make the following Order—

Citation

1. This Order may be cited as The Langho 2022 Tree Preservation Order dated 16 February 2022

Interpretation

- 2.— (1) In this Order “the authority” means the Ribble Valley Borough Council.
(2) In this Order any reference to a numbered section is a reference to the section so numbered in the Town and Country Planning Act 1990 and any reference to a numbered regulation is a reference to the regulation so numbered in the Town and Country Planning (Tree Preservation)(England) Regulations 2012.

Effect

- 3.— (1) Subject to article 4, this Order takes effect provisionally on the date on which it is made.
(2) Without prejudice to subsection (7) of section 198 (power to make tree preservation orders) or subsection (1) of section 200 (tree preservation orders: Forestry Commissioners) and, subject to the exceptions in regulation 14, no person shall—
 - (a) cut down, top, lop, uproot, wilfully damage, or wilfully destroy; or
 - (b) cause or permit the cutting down, topping, lopping, uprooting, wilful damage or wilful destruction of,
any tree specified in the Schedule to this Order except with the written consent of the authority in accordance with regulations 16 and 17, or of the Secretary of State in accordance with regulation 23, and, where such consent is given subject to conditions, in accordance with those conditions.

Application to trees to be planted pursuant to a condition

4. In relation to any tree identified in the first column of the Schedule by the letter “C”, being a tree to be planted pursuant to a condition imposed under paragraph (a) of section 197 (planning permission to include appropriate provision for preservation and planting of trees), this Order takes effect as from the time when the tree is planted.

Dated this 16th day of February 2022

Signed on behalf of the Ribble Valley Borough Council



.....
Mrs Nicola Hopkins, Director of Economic Development & Planning
Authorised by the Council to sign in that behalf

CONFIRMATION OF ORDER

This Order was confirmed by Ribble Valley Borough Council without modification on the 2nd day of May 2022

Signed on behalf of the Ribble Valley Borough Council



Mrs Nicola Hopkins, Director of Economic Development and Planning
Authorised by the Council to sign in that behalf]

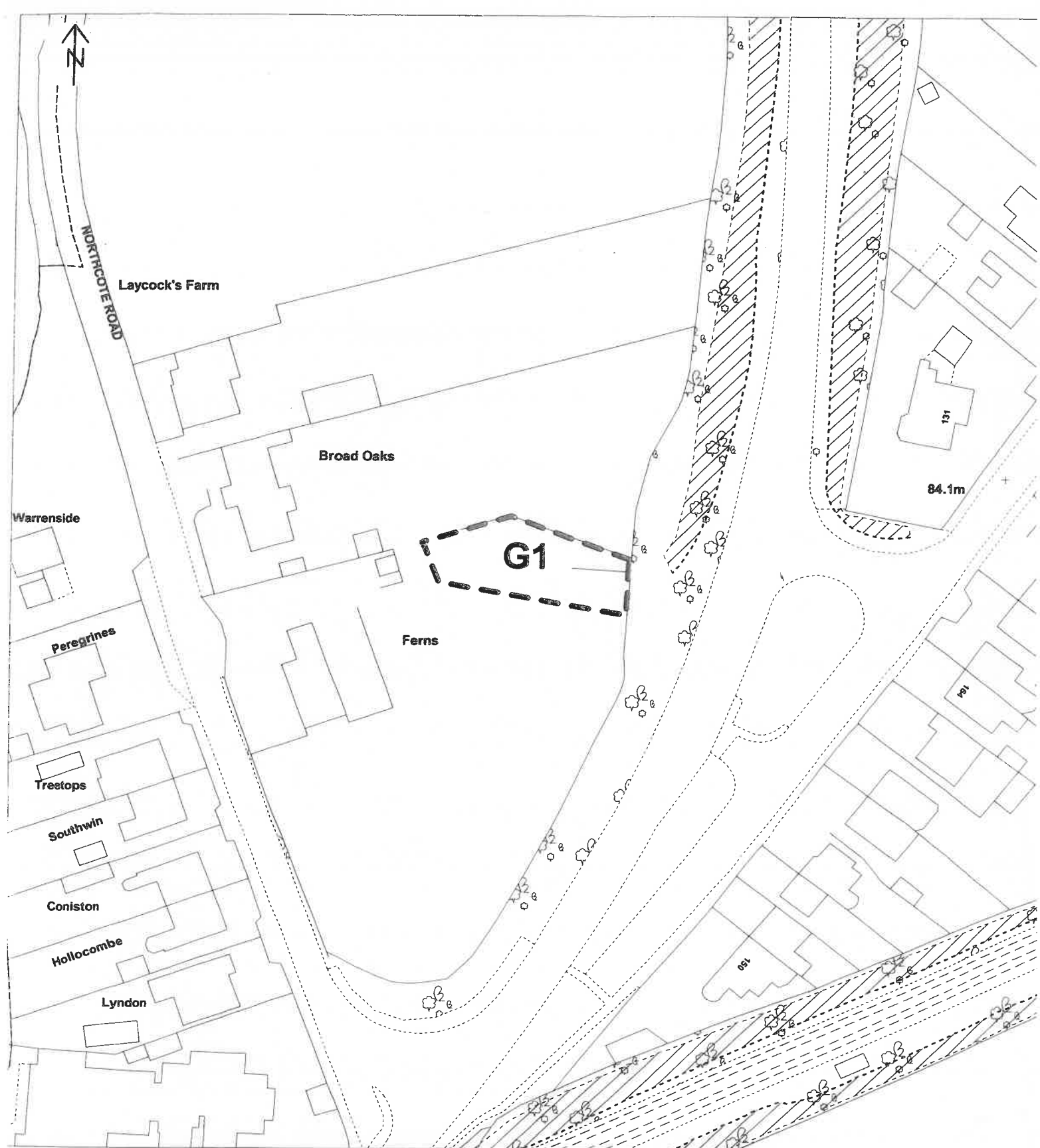

RIBBLE VALLEY BOROUGH COUNCIL TREE PRESERVATION ORDER NO./NOS. LANGHO 2022
TOWN & COUNTRY PLANNING ACT 1990
TOWN & COUNTRY PLANNING (TREES) REGULATIONS 2012

LOCATION: LAND SOUTH OF LAYCOCKS FARM
PARISH: LANGHO

OS SHEET: SD7034NE

© Crown Copyright. All rights reserved.
 Ribble Valley Borough Council. Licence No.100018641 15 February 2022
 For reference purposes only. No further copies may be made.

Scale 1:1000

SCHEDULE

Specification of trees

Trees specified individually

(encircled in black on the map)

<i>Reference on map</i>	<i>Description</i>	<i>Situation</i>
None	None	None

Trees specified by reference to an area

(within a dotted black line on the map)

<i>Reference on map</i>	<i>Description</i>	<i>Situation</i>
None	None	None

Groups of trees

(within a broken black line on the map)

<i>Reference on map</i>	<i>Description (including number of trees of each species in the group)</i>	<i>Situation</i>
G1	4 oak trees	On land south of Laycocks Farm, Langho

Woodlands

(within a continuous black line on the map)

<i>Reference on map</i>	<i>Description</i>	<i>Situation</i>
None	None	None