

## Form of Tree Preservation Order

Town and Country Planning Act 1990

[REDACTED]

The Ribble Valley Borough Council, in exercise of the powers conferred on them by section 198 of the Town and Country Planning Act 1990 make the following Order—

### Citation

1. This Order may be cited as Fir Tree House Tree Preservation Order 2021

### Interpretation

- 2.— (1) In this Order “the authority” means the Ribble Valley Borough Council.
- (2) In this Order any reference to a numbered section is a reference to the section so numbered in the Town and Country Planning Act 1990 and any reference to a numbered regulation is a reference to the regulation so numbered in the Town and Country Planning (Tree Preservation)(England) Regulations 2012.

### Effect

- 3.— (1) Subject to article 4, this Order takes effect provisionally on the date on which it is made.
- (2) Without prejudice to subsection (7) of section 198 (power to make tree preservation orders) or subsection (1) of section 200 (tree preservation orders: Forestry Commissioners) and, subject to the exceptions in regulation 14, no person shall—
  - (a) cut down, top, lop, uproot, wilfully damage, or wilfully destroy; or
  - (b) cause or permit the cutting down, topping, lopping, uprooting, wilful damage or wilful destruction of,any tree specified in the Schedule to this Order except with the written consent of the authority in accordance with regulations 16 and 17, or of the Secretary of State in accordance with regulation 23, and, where such consent is given subject to conditions, in accordance with those conditions.

### Application to trees to be planted pursuant to a condition

4. In relation to any tree identified in the first column of the Schedule by the letter “C”, being a tree to be planted pursuant to a condition imposed under paragraph (a) of section 197 (planning permission to include appropriate provision for preservation and planting of trees), this Order takes effect as from the time when the tree is planted.

Dated this 26<sup>th</sup> day of April 2021

Signed on behalf of the Ribble Valley Borough Council

[REDACTED] .....

Mrs Nicola Hopkins,  
Director of Economic Development and Planning

Authorised by the Council to sign in that behalf

**CONFIRMATION OF ORDER**

This Order was confirmed by Ribble Valley Borough Council without modification on the 8<sup>th</sup> Day of September 2021

*[Handwritten signature]*  
[Redacted] of the Ribble Valley Borough Council

*[Handwritten signature]*  
Mrs Nicola Hopkins,  
Director of Economic Development and Planning

Authorised by the Council to sign in that behalf

## SCHEDULE

### Specification of trees

#### Trees specified individually

(encircled in black on the map)

<i>Reference on map</i>	<i>Description</i>	<i>Situation</i>
T1	Sycamore	Fir Tree House, Chatburn

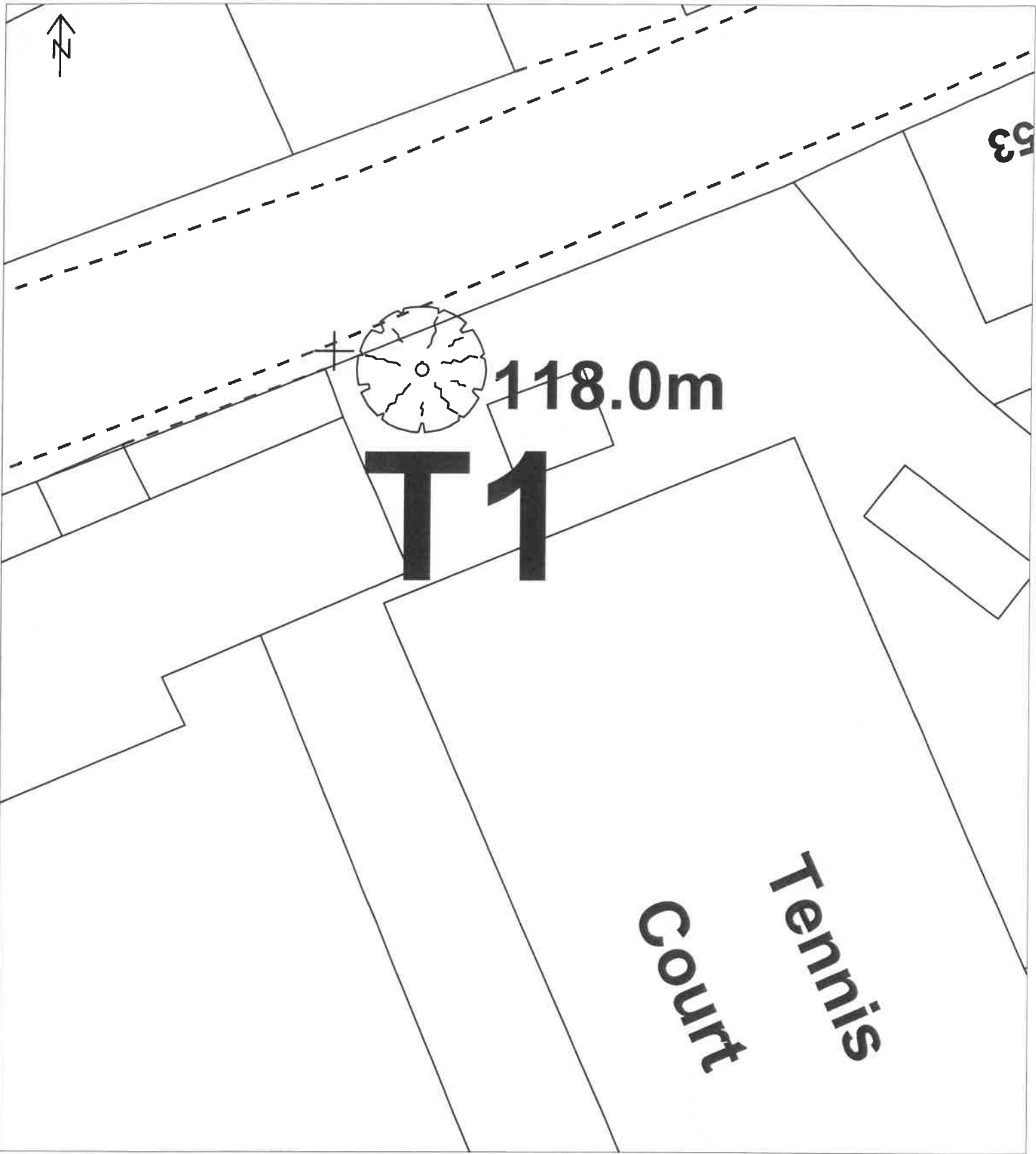

RIBBLE VALLEY BOROUGH COUNCIL    TREE PRESERVATION ORDER NO./NOS. 7/19/3/223  
TOWN & COUNTRY PLANNING ACT 1990  
TOWN & COUNTRY PLANNING (TREES) REGULATIONS 1999  
LOCATION: FIR TREE HOUSE  
PARISH:    CHATBURN  
OS SHEET: SD7744SW

7/19/3/222