

Philip Dagnall

A9 10

**From:** [REDACTED]  
**Sent:** 08 June 2017 12:20  
**To:** publicationreg19  
**Subject:** Representations to RVBC HEDDPD Reg19 consultation  
**Attachments:** Petre Fm, Langho final 8.6.17 call\_for\_sites\_form.pdf; Pimlico Rd final 8.6.17 call\_for\_sites\_form.pdf; RVBC Reg 19 final pol reps FD 8.6.17.pdf; Petre Farm Proposed scheme.pdf; Loc Plan Petre Farm Lamgho.pdf; \_Location\_Plan Pimlico Rd, Clitheroe.pdf

**Importance:** High

*re Clitheroe (Pimlico),*

Dear Sirs

Please find attached representations to the HEDDPD Reg 19 consultation on behalf of our client Frank Duffin. Also attached are plans showing the location of his land ( 1 site in Clitheroe and the other in Langho) and Call for Sites forms, (as we have only recently been instructed in this matter by Mr Duffin), and an indicative layout for the land at Langho.

Please confirm receipt & that these representations have been made in due time.

Regards

Jane Dickman

Director

## **Dickman Associates Ltd**

Chartered Town Planning and Development Consultants



Please consider the environment before printing this e-mail

This email (and any attachments) is intended for the named recipient only. If you are not the intended recipient, notify the sender immediately and destroy this email. This email may contain privileged and confidential information you must not copy, distribute or take action in reliance upon it.

Whilst all efforts are made to safeguard emails Dickman Associates Ltd cannot guarantee that this email and/or any attachments are virus free or compatible with your systems and does not accept liability in respect of viruses or computer problems experienced.

Any opinions or advice contained in this email/attachments are not necessarily those of Dickman Associates Ltd.

Dickman Associates Ltd Registered in England & Wales Registered No. 6874283; VAT No 152 2106 58



**RIBBLE VALLEY HOUSING AND ECONOMIC DEVELOPMENT**  
**REGULATION 18 ISSUES AND OPTIONS**  
**SUGGESTED SITE FOR CONSIDERATION AUGUST 2016**

RVBC are holding a 'call for sites' for housing, employment and retail land purposes as part of a consultation on the forthcoming Housing and Economic Development DPD.

**This form can be used to submit suggested housing sites, employment land sites and proposed retail sites to the Council.**

If you wish to submit a site as a potential option for allocation as part of this process, please complete this form and provide a location plan which enables the site and its boundaries to be identified clearly. Gaps in providing information could cause delay in assessing your site and its possible inclusion in the Housing and Economic Development DPD site consideration process. If you wish to provide any supplementary information in support of your responses, please append it to this questionnaire.

Please do not submit sites which:

- Already have planning permission or are under construction as these are already accounted for in the plan making process.
- In relation to housing are located in settlements where the residual housing requirement has already been met. The call for housing sites relates only to those settlements where a residual requirement remains. These settlements are:
  - Chatburn
  - Mellor
  - Wilpshire

Please use a separate form for each site.

Information provided on this questionnaire will be made public as it will form part of the evidence base to the Local Development Framework. We will not publish personal address and contact information and will hold your information in accord with the requirements of the Data Protection Act. All information provided will be available to the Inspector appointed by the Secretary of State to hold the Examination in Public.

**The suggestion of a site does not imply on the Council's part that it will agree that a site has potential for housing, employment or retail uses; or that planning permission would be forthcoming for housing, employment or retail uses; or that it will be allocated for development in any of the Council's Development Plan Documents.**

Please return this completed form along with a site plan and any further supporting information no later than 5pm Friday 7<sup>th</sup> October 2016 to:

Reg. 18 Issues and Options Call for Sites Consultation  
Regeneration and Housing  
Ribble Valley Borough Council  
Council Offices  
Church Walk  
Clitheroe  
BB7 2RA

<b>GENERAL INFORMATION</b>	
What type of development are you suggesting the site could be developed for? E.g. housing, employment B1 – B8, retail	Housing
Site suggested by: (main contact if further details required)	Name: [REDACTED] Address: [REDACTED]  Tel: [REDACTED] Email: [REDACTED]
What is your interest in the land?	Landowner's agent
Details of site owner: (if different from above)	Name: Frank Duffin Address: East Lancashire Property Company Ltd, The Farmhouse, Pickering Fold, off Rock Lane, Tockholes, Lancs, BB3 0LX
Is the owner aware the site has been suggested in this call for sites consultation?	<input checked="" type="checkbox"/> Yes/ <input type="checkbox"/> No
Location of site:	<i>Please write an address and attach a location plan with a clear site boundary which will enable the site to be readily identified:</i>  Land r/o 156 Pimlico Road, Clitheroe
Site area (in hectares or sq metres)	0.07ha
Current use of site	vacant land with hard standing
Is the site greenfield or previously developed?	PDL

Has planning permission ever been sought for development of the site?	(if yes, please provide details e.g. type and amount of development)  YES RVBC application No 3/2015/0785 for 6 flats with car parking refused Feb 2016 RVBC application No. 3/2005/1013 conversion of office block to 2 apartments & 5 new apartments . Approved Sept 2007
<b>OWNERSHIP MATTERS</b>	
Is the site in single or multiple ownership?	<input checked="" type="checkbox"/> Single <input type="checkbox"/> multiple
If multiple, how many owners?	n/a
Have all the owners expressed an intention sell the land for housing, employment or retail use?	n/a
Is the land controlled by a developer who intends to develop the land?	<input checked="" type="checkbox"/> Yes <input type="checkbox"/> No. If yes, please provide details
Are there any ransom strips, tenancies or operational requirements of landowners which would restrict development?	If yes, please provide details  No
<b>VIABILITY MATTERS</b>	
Has the economic viability of the site been assessed? If so, what was the outcome?	Please provide any supporting information  none as yet

Please explain why you consider the site to be economically viable (or not).	Within the Clitheroe settlement boundary and as suitable for housing it would be a viable site
Are there any abnormal costs/significant constraints that need to be overcome in developing this site?	Please provide details: No
How many developers would be involved in developing the site should planning permission be granted?	one
What would be a realistic timescale for developing the site	Start date: 2017 once planning granted End date: 2018
If this is a large site what would be a realistic projected build rate for the site? (e.g. estimated no. of dwellings per year if for housing or timescale from start to completion of phases of development)	n/a small site
<b>CAPACITY AND CONSTRAINT MATTERS</b>	
What is your estimate of the potential capacity of the site? (no. of dwellings/ overall m <sup>2</sup> if employment land / m <sup>2</sup> retail floorspace)	up to 7 apartment units as per 2007 approval
Are there any physical constraints which would restrict development of the site?	none aware of
Has any work been undertaken to assess how these constraints might be overcome?	n/a
Is there direct access to the site from the adjoining road network?	Yes
Are there any major issues regarding access to the site, and if so briefly what are they?	No

Are there any trees on site protected by Tree Preservation Orders?	No
Are there significant contamination issues/hazardous risks/pollution on the sites?	No
Is the site within an area at risk from flooding (flood Zone 2 or 3 as defined by the Environment Agency)?	No
Please explain why you think the site is a suitable location for development.	The site lies within the settlement boundary of Clitheroe the main town in Ribble Valley. It is PDL and adjacent to existing housing
If there are any other issues that you wish to raise in relation to this site, please do so here.	previously had outline pp for 7 apartments

**Declaration**

I understand that information provided on this form in response to this call for sites for sites, with the exception of name and address, could be made publicly available by Ribble Valley Borough Council in relation to production of the Housing and Economic Development DPD and evidence base for the LDF. Information will be made available to the Inspector for the purposes of the Examination in Public should he or she require it.

The information I have provided is accurate and true to the best of my knowledge.

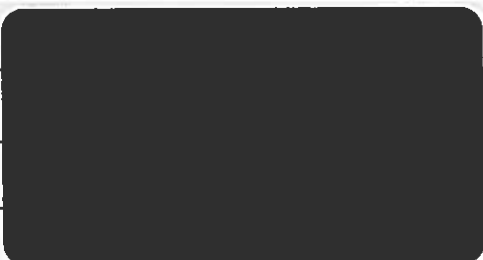
<b>Name (print)</b>	
<b>Signature</b>	
<b>Organisation</b>	
<b>Date</b>	





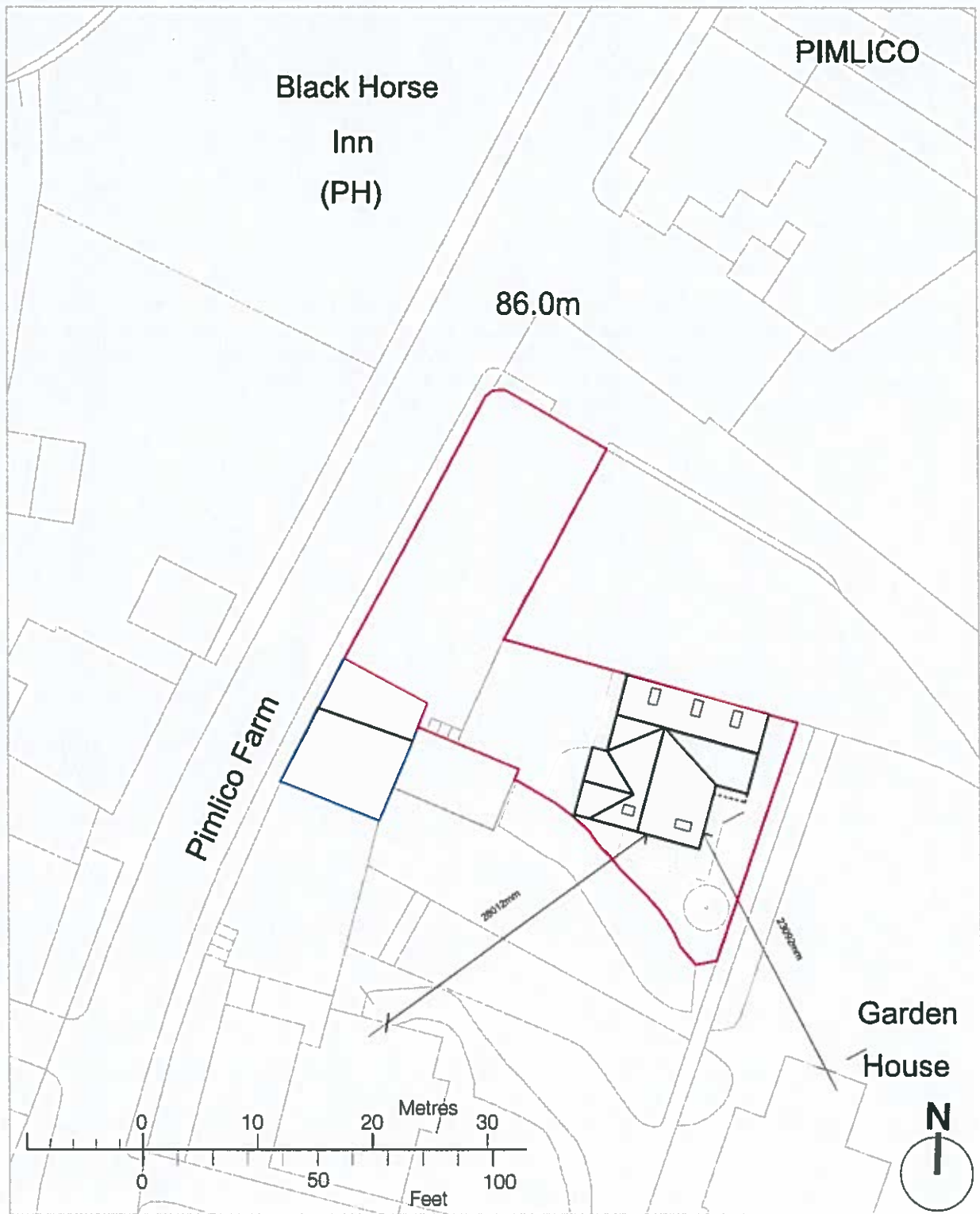

PROPOSED APARTMENTS

LOCATION PLAN

East Lancashire Property UK Ltd  
 Rockmount,  
 Pimlico Road  
 Clitheroe

14-051-01

April 2015

1:500 @ A4

