

Tree Preservation Order

Town and Country Planning Act 1990

The Wiltshire Golf Clubs Tree Preservation Order 2015 No 1

The Ribble Valley Borough Council, in exercise of the powers conferred on them by section 198 of the Town and Country Planning Act 1990 make the following Order—

Citation

1. This Order may be cited as The Wiltshire Golf Club Tree Preservation Order 2015 No 1.

Interpretation

- 2.— (1) In this Order “the authority” means the Ribble Valley Borough Council.
(2) In this Order any reference to a numbered section is a reference to the section so numbered in the Town and Country Planning Act 1990 and any reference to a numbered regulation is a reference to the regulation so numbered in the Town and Country Planning (Tree Preservation)(England) Regulations 2012.

Effect

- 3.— (1) Subject to article 4, this Order takes effect provisionally on the date on which it is made.

(2) Without prejudice to subsection (7) of section 198 (power to make tree preservation orders) or subsection (1) of section 200 (tree preservation orders: Forestry Commissioners) and, subject to the exceptions in regulation 14, no person shall—

- (a) cut down, top, lop, uproot, wilfully damage, or wilfully destroy; or
- (b) cause or permit the cutting down, topping, lopping, uprooting, wilful damage or wilful destruction of,

any tree specified in the Schedule to this Order except with the written consent of the authority in accordance with regulations 16 and 17, or of the Secretary of State in accordance with regulation 23, and, where such consent is given subject to conditions, in accordance with those conditions.

Application to trees to be planted pursuant to a condition

4. In relation to any tree identified in the first column of the Schedule by the letter “C”, being a tree to be planted pursuant to a condition imposed under paragraph (a) of section 197 (planning permission to include appropriate provision for preservation and planting of trees), this Order takes effect as from the time when the tree is planted.

Dated this 19th day of March 2015

The Common Seal of the Ribble Valley Borough Council

was affixed to this Order in the presence of—

.....
The Mayor

M. H. Scott
.....
The Chief Executive



CONFIRMATION OF ORDER

This Order was **confirmed** by the Ribble Valley Borough Council on the **24th day of April 2015**

Signed on behalf of the Ribble Valley Borough Council

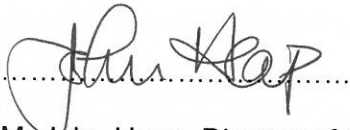
A handwritten signature in black ink, appearing to read 'John Heap', written over a horizontal dotted line.

Mr John Heap, Director of Community Services

Authorised by the Council to sign in that behalf

SCHEDULE

Specification of trees

Trees specified individually

(encircled in black on the map)

-NONE-

Trees specified by reference to an area

(within a dotted black line on the map)

<i>Reference on map</i>	<i>Description</i>	<i>Situation</i>
A1	Trees of whatever species located within the area designated as A1	Within the grounds of 1 and 3 Hollowhead Lane, Wilpshire

Groups of trees

(within a broken black line on the map)

-NONE-

Woodlands

(within a continuous black line on the map)

<i>Reference on map</i>	<i>Description</i>	<i>Situation</i>
W1	Trees of whatever species located within the woodland designated as W1	Mostly located to the rear of properties on Whalley Road, Wilpshire in various ownership

The Wilpshire Golf Club Tree Preservation Order 2015 No 1

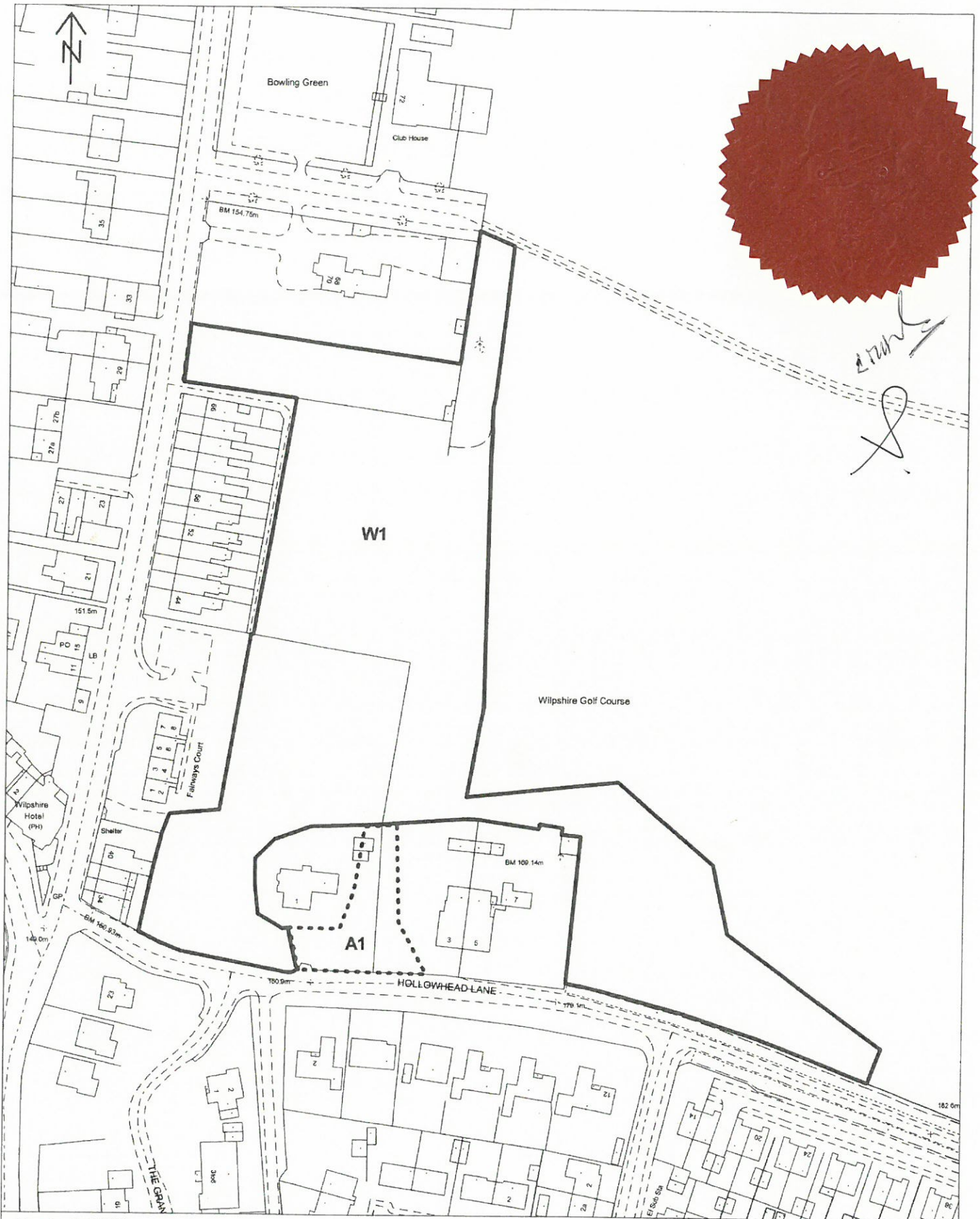

Scale 1:1500

(C) Crown copyright. All rights reserved.
Ribble Valley Borough Council LA 100018641
2011