

Tree Preservation Order

Town and Country Planning Act 1990

The Langlands, Gisburn Tree Preservation Order 2014

The Ribble Valley Borough Council in exercise of the powers conferred on them by section 198 of the Town and Country Planning Act 1990 make the following Order—

Citation

1. This Order may be cited as Langlands, Gisburn, Tree Preservation Order 2014.

Interpretation

2. (1) In this Order "the authority" means the Ribble Valley Borough Council.
(2) In this Order any reference to a numbered section is a reference to the section so numbered in the Town and Country Planning Act 1990 and any reference to a numbered regulation is a reference to the regulation so numbered in the Town and Country Planning (Tree Preservation)(England) Regulations 2012.

Effect

3. (1) Subject to article 4, this Order takes effect provisionally on the date on which it is made.
(2) Without prejudice to subsection (7) of section 198 (power to make tree preservation orders) or subsection (1) of section 200 (tree preservation orders: Forestry Commissioners) and, subject to the exceptions in regulation 14, no person shall—
 - (a) cut down, top, lop, uproot, wilfully damage, or wilfully destroy; or
 - (b) cause or permit the cutting down, topping, lopping, wilful damage or wilful destruction of,

any tree specified in the Schedule to this Order except with the written consent of the authority in accordance with regulations 16 and 17, or of the Secretary of State in accordance with regulation 23, and, where such consent is given subject to conditions, in accordance with those conditions.

Application to trees to be planted pursuant to a condition

4. In relation to any tree identified in the first column of the Schedule by the letter "C", being a tree to be planted pursuant to a condition imposed under paragraph (a) of section 197 (planning permission to include appropriate provision for preservation and planting of trees), this Order takes effect as from the time when the tree is planted.

Dated this 20th day of May 2014

The Common Seal of Ribble Valley Borough Council
was affixed to this Order in the presence of—

K. M. H. Kaur..... The Mayor

M. H. Scott..... The Chief Executive



CONFIRMATION OF ORDER

This Order was confirmed by Ribble Valley Borough Council without modification on the 18th day of August 2014

The Common Seal of Ribble Valley Borough Council was affixed to this Order in the presence of -

 The Mayor

 The Chief Executive



SCHEDULE Article 3
Specification of trees

Trees specified individually

(encircled in black on the map)

<i>Reference on map</i>	<i>Description</i>	<i>Situation</i>
[T1]	[Horse Chestnut]	[Growing in the garden of Langlands, Gisburn]

<i>Trees specified by area on the map</i>	<i>Description</i>	<i>Situation</i>
[none]	[none]	[none]

Groups of trees

<i>Reference on map</i>	<i>Description</i>	<i>Situation</i>
[none]	[none]	[none]

Woodlands

<i>Reference on map</i>	<i>Description</i>	<i>Situation</i>
[none]	[none]	[none]

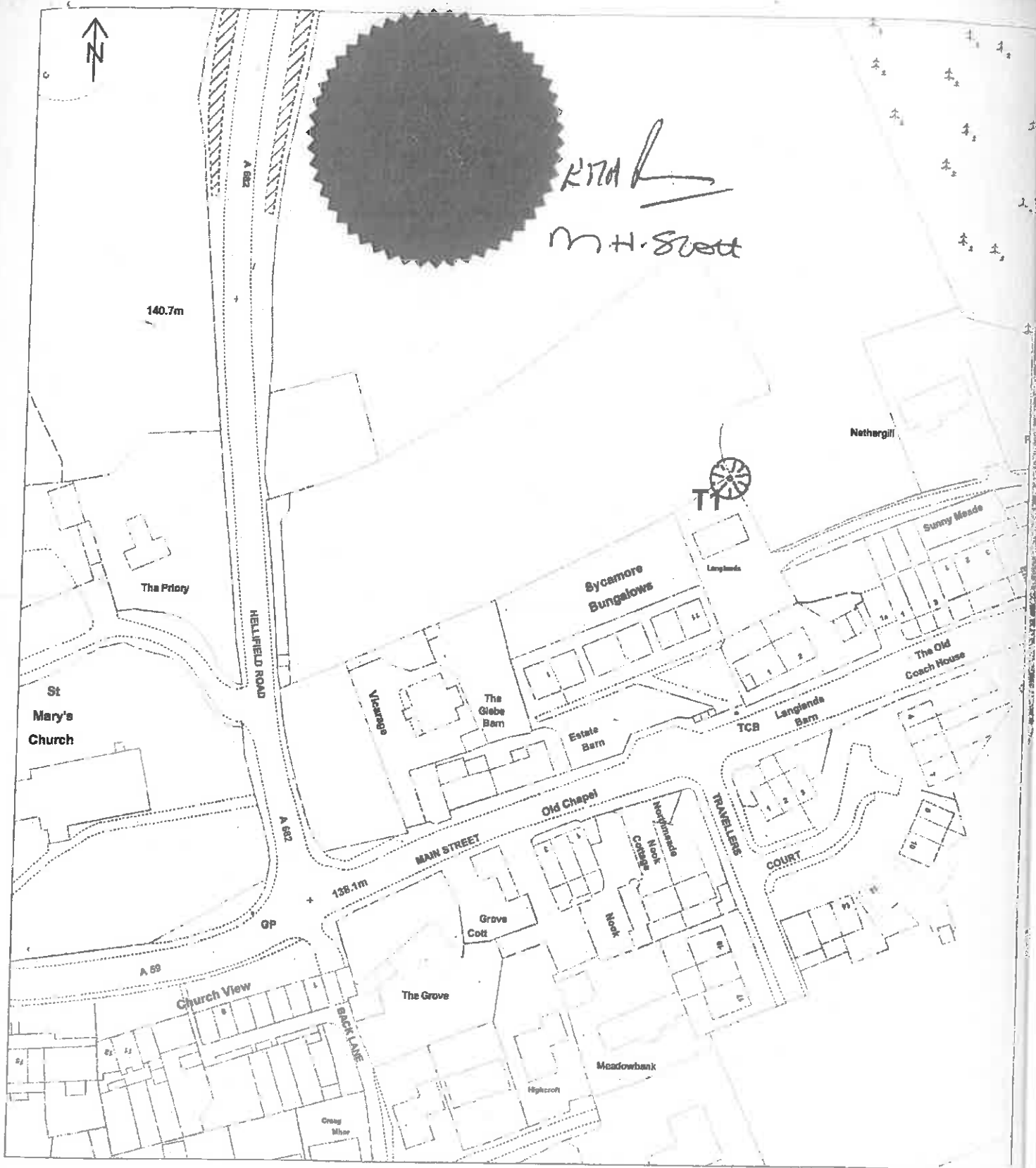

RIBBLE VALLEY BOROUGH COUNCIL TREE PRESERVATION ORDER NO./NOS. 7/19/3/190
 TOWN & COUNTRY PLANNING ACT 1990
 TOWN & COUNTRY PLANNING (TREES) REGULATIONS 2012

LOCATION: LANGLANDS

PARISH: GISBURN

OS SHEET: SD8348NW

© Crown Copyright. All rights reserved.
 Ribblesdale Borough Council. Licence No 100018641 19 May 2014
 For reference purposes only. No further copies may be made.

Scale 1:1250

