

**SCHEDULE 1
 SPECIFICATION OF TREES
 Trees Specified individually
 (encircled in black on the map)**

| <i>Reference on Map</i> | <i>Description</i> | <i>Situation*</i> |
|-------------------------|--------------------|---|
| T1 | BIRCH | RODHILL LODGE, SD7647NE - SAWLEY |

**Trees specified by reference to an area
 (within a dotted black line on the map)**

| <i>Reference on Map</i> | <i>Description</i> | <i>Situation*</i> |
|-------------------------|--------------------|-------------------|
| NONE | NONE | NONE |

Groups of Trees

(within a broken black line on the map)

| <i>Reference on Map</i> | <i>Description</i> | <i>Situation*</i> |
|-------------------------|--------------------|-------------------|
| NONE | NONE | NONE |

Woodlands

(within a continuous black line on the map)

| <i>Reference on Map</i> | <i>Description</i> | <i>Situation*</i> |
|-------------------------|--------------------|-------------------|
| NONE | NONE | NONE |

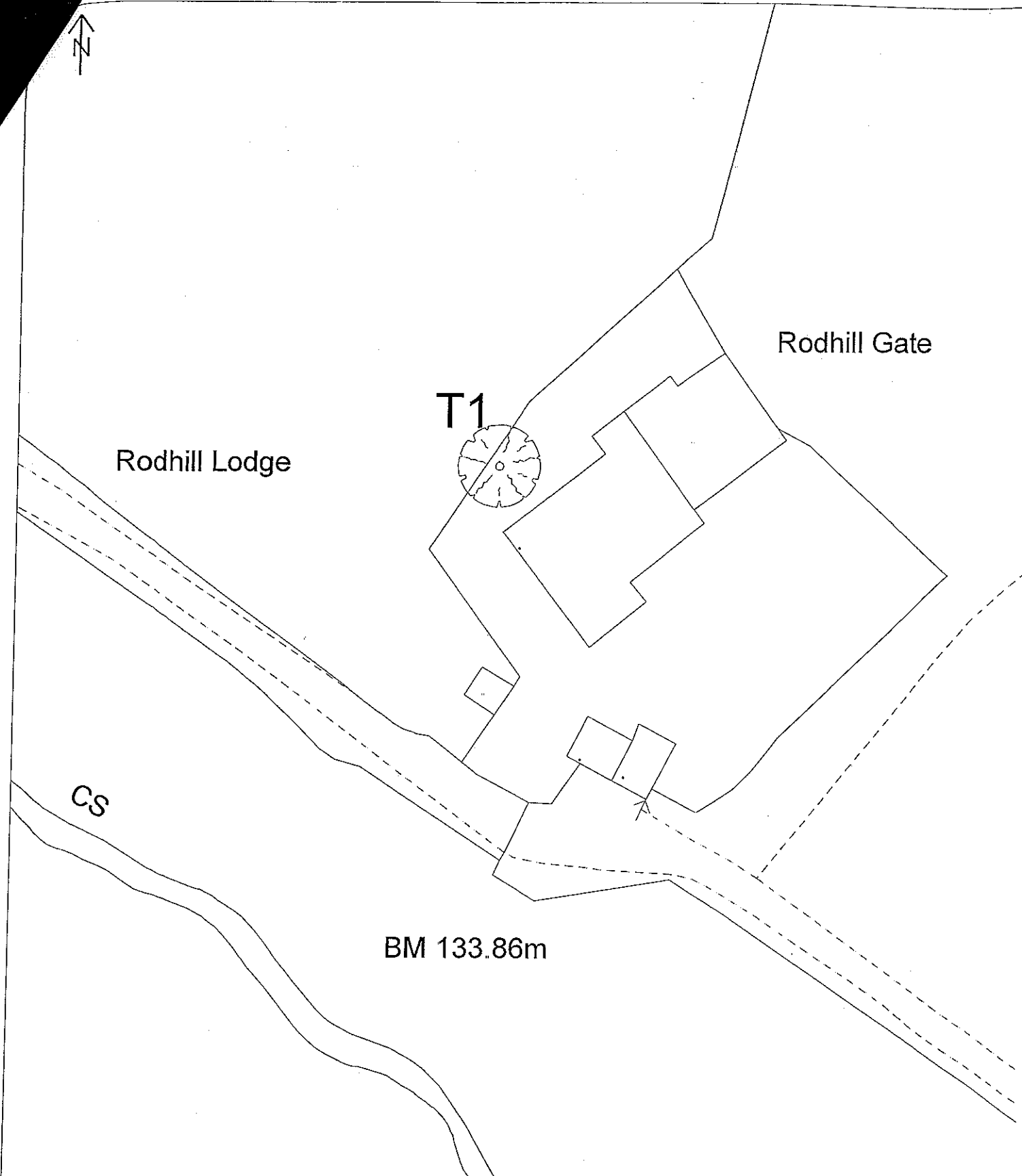

RIBBLE VALLEY BOROUGH COUNCIL TREE PRESERVATION ORDER NO./NOS. 7/19/3/178
TOWN & COUNTRY PLANNING ACT 1990
TOWN & COUNTRY PLANNING (TREES) REGULATIONS 1999

LOCATION: RODHILL LODGE, BOLTO-BY-BOWLAND
PARISH: SAWLEY

OS SHEET: SD7647NE