

SCHEDULE 1
SPECIFICATION OF TREES
Trees Specified individually
(encircled in black on the map)

<i>Reference on Map</i>	<i>Description</i>	<i>Situation*</i>
I1	Chestnut	Coach House, Ribchester Road, Clayton Le dale
I2	Lime [Consent to fell issued 19 th of March 2009]	Coach House, Ribchester Road, Clayton Le Dale
I3	Lime	Coach House, Ribchester Road, Clayton Le Dale
I4	Yew	Coach House, Ribchester Road, Clayton Le Dale

Trees specified by reference to an area
(within a dotted black line on the map)

<i>Reference on Map</i>	<i>Description</i>	<i>Situation*</i>
None	None	None

Groups of Trees
(within a broken black line on the map)

<i>Reference on Map</i>	<i>Description</i>	<i>Situation*</i>
None	None	None

Woodlands
(within a continuous black line on the map)

<i>Reference on Map</i>	<i>Description</i>	<i>Situation*</i>
None	None	None

*complete if necessary to specify more precisely the position of the trees

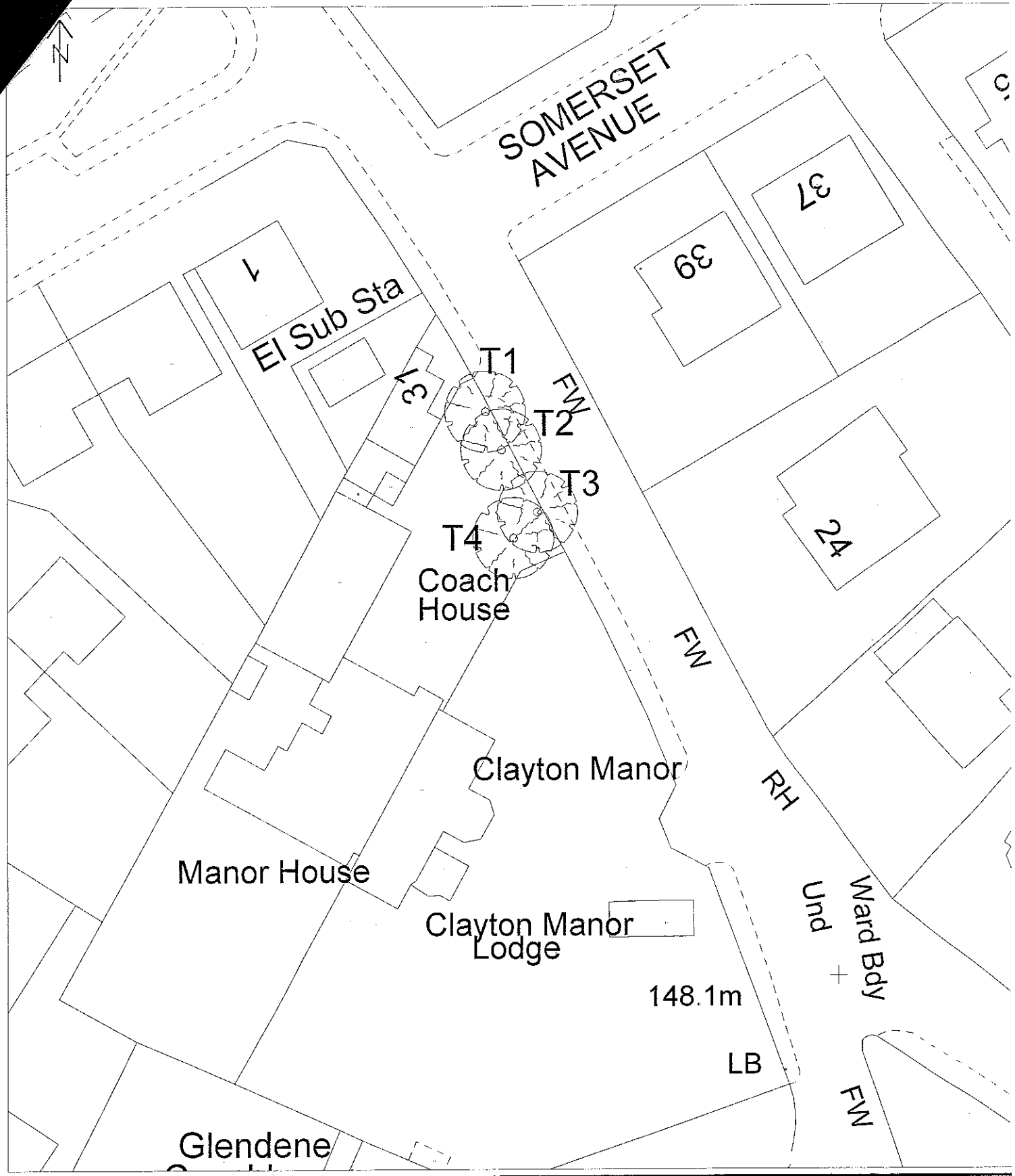

RIBBLE VALLEY BOROUGH COUNCIL TREE PRESERVATION ORDER NO./NOS 7/19/3/177
 TOWN & COUNTRY PLANNING ACT 1990
 TOWN & COUNTRY PLANNING (TREES) REGULATIONS 1999

LOCATION: COACH HOUSE, RIBCHESTER ROAD
 PARISH: CLAYTON LE DALE

OS SHEET: SD6832NW