

SCHEDULE 1
SPECIFICATION OF TREES
Trees Specified individually
(encircled in black on the map)

<i>Reference on Map</i>	<i>Description</i>	<i>Situation*</i>
T1	Sycamore	Growing on land at
T2	Sycamore	New House Farm
T3	Sycamore	Grunsagill Road
		Tosside, Slaidburn
		in the Ribble Valley

Trees specified by reference to an area
(within a dotted black line on the map)

<i>Reference on Map</i>	<i>Description</i>	<i>Situation*</i>
None	None	None

Groups of Trees
(within a broken black line on the map)

<i>Reference on Map</i>	<i>Description</i>	<i>Situation*</i>
None	None	None

Woodlands
(within a continuous black line on the map)

<i>Reference on Map</i>	<i>Description</i>	<i>Situation*</i>
None	None	None

*complete if necessary to specify more precisely the position of the trees

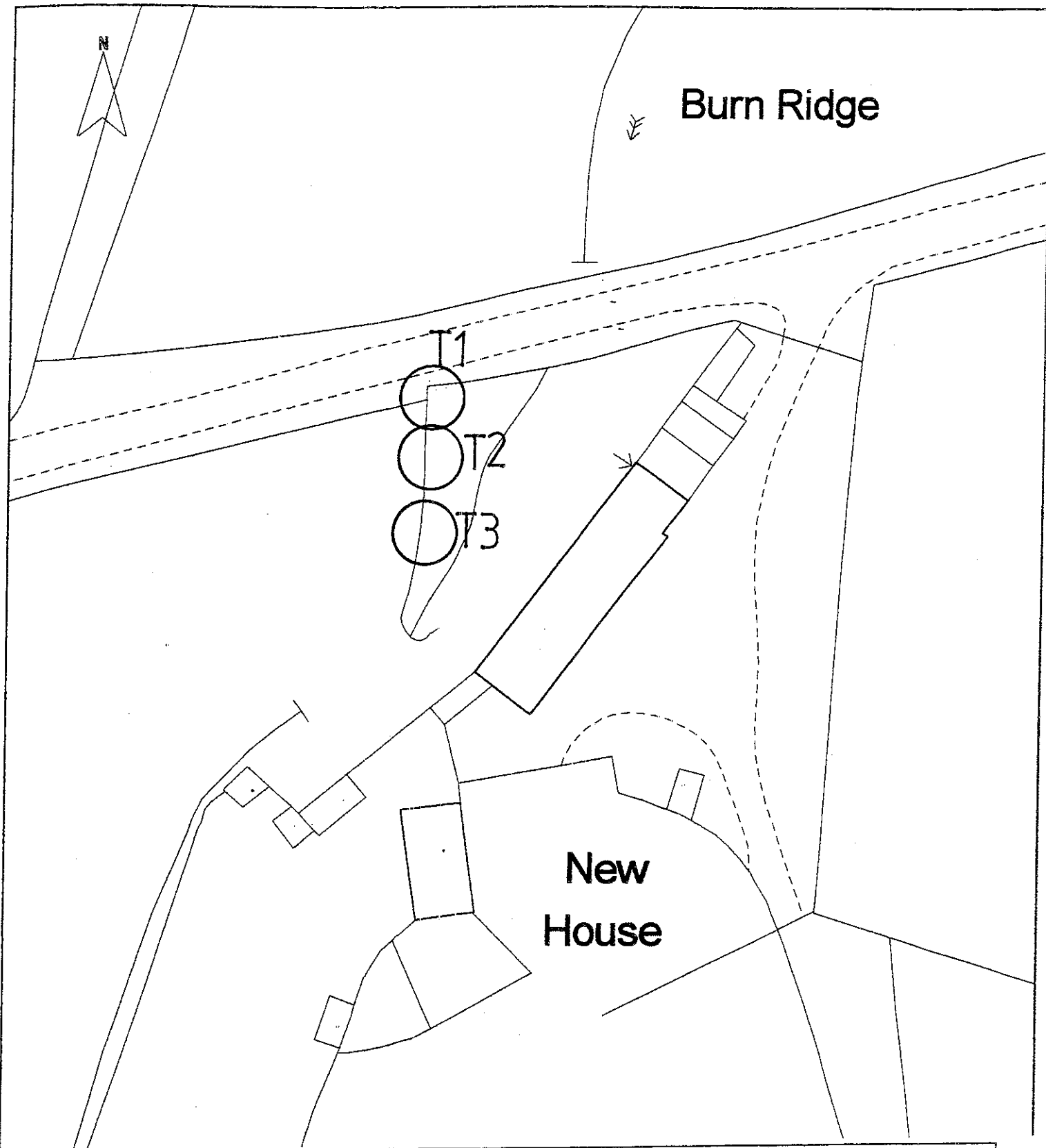

RIBBLE VALLEY BOROUGH COUNCIL
TREE PRESERVATION ORDER
TOWN AND COUNTRY PLANNING ACT 1990
NEW HOUSE FARM, GRUNSAGILL ROAD,
TOSSIDE, SLAIDBURN

SCALE : 1/500

REF : DAH

DATE : 8/12/2000