

**SCHEDULE 1  
SPECIFICATION OF TREES  
Trees Specified individually  
(encircled in black on the map)**

<i>Reference on Map</i>	<i>Description</i>	<i>Reference on Map</i>	<i>Description</i>	<i>Reference on Map</i>	<i>Description</i>	<i>Reference on Map</i>	<i>Description</i>	<i>Situation*</i>
T1	Sycamore	T11	Rowan	T21	Ash	T31	Oak	Growing along the boundary of land at Vicarage Lane, Wilpshire, Ribble Valley.
T2	Sycamore	T12	Ash	T22	Oak	T32	Alder	
T3	Sycamore	T13	Oak	T23	Ash	T33	Oak	
T4	Sycamore	T14	Oak	T24	Ash	T34	Oak	
T5	Sycamore	T15	Ash	T25	Oak	T35	Alder	
T6	Oak	T16	Acer	T26	Sycamore	T36	Oak	
T7	Oak	T17	Acer	T27	Alder	T37	Oak	
T8	Poplar	T18	Acer	T28	Alder	T38	Alder	
T9	Oak	T19	Acer	T29	Hawthorn	T38	Rowan	
T10	Ash	T20	Oak	T30	Oak	T40	Rowan	
						T41	Malus	

**Trees specified by reference to an area  
(within a dotted black line on the map)**

<i>Reference on Map</i>	<i>Description</i>	<i>Situation*</i>
NONE	NONE	NONE

**Groups of Trees  
(within a broken black line on the map)**

<i>Reference on Map</i>	<i>Description</i>	<i>Situation*</i>
NONE	NONE	NONE

**Woodlands  
(within a continuous black line on the map)**

<i>Reference on Map</i>	<i>Description</i>	<i>Situation*</i>
NONE	NONE	NONE

\*complete if necessary to specify more precisely the position of the trees

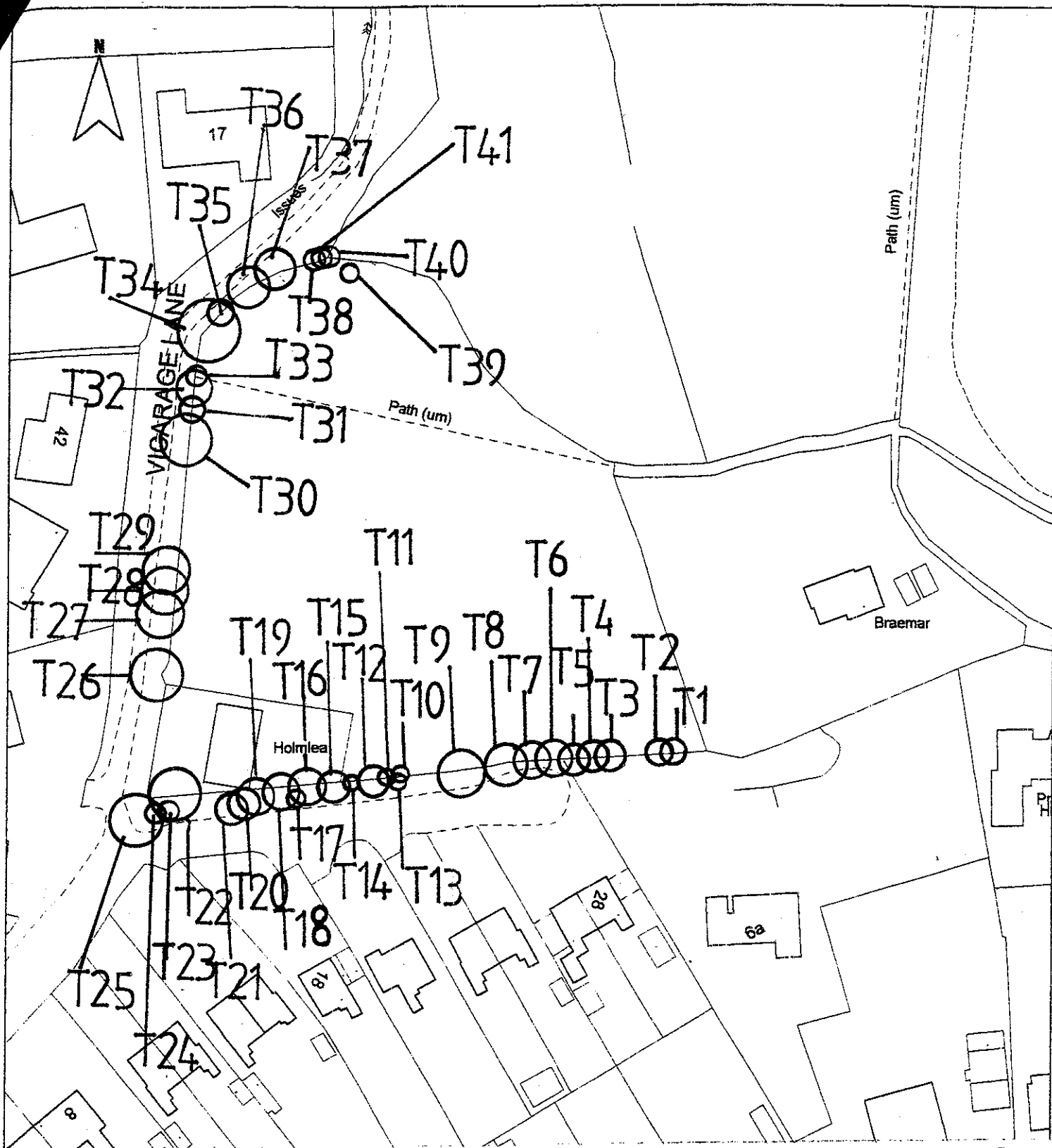

RIBBLE VALLEY BOROUGH COUNCIL  
 VICARAGE LANE, WILPSHIRE,  
 TREE PRESERVATION ORDER 2000

DATE : 10th JULY  
 REFERENCE : DAH  
 SCALE : 1/500

David Morris MIEH ARSH MBIM, Chief Executive  
 Ribble Valley Borough Council, Church Walk, Clitheroe, Lancs BB7 2RA (STD 01200 25111)