

**SCHEDULE 1**  
**SPECIFICATION OF TREES**  
**Trees Specified individually**  
 (encircled in black on the map)

<i>Reference on Map</i>	<i>Description</i>	<i>Situation*</i>
-------------------------	--------------------	-------------------

NONE

**Trees specified by reference to an area**  
 (within a dotted black line on the map)

<i>Reference on Map</i>	<i>Description</i>	<i>Situation*</i>
-------------------------	--------------------	-------------------

NONE

**Groups of Trees**  
 (within a broken black line on the map)

<i>Reference on Map</i>	<i>Description</i>	<i>Situation*</i>
-------------------------	--------------------	-------------------

NONE

**Woodlands**  
 (within a continuous black line on the map)

<i>Reference on Map</i>	<i>Description</i>	<i>Situation*</i>
-------------------------	--------------------	-------------------

W1	Woodland consisting mainly of: Beech Sycamore Common Ash Alder	Land belonging to 9 The Dene, Hurst Green
----	--	--

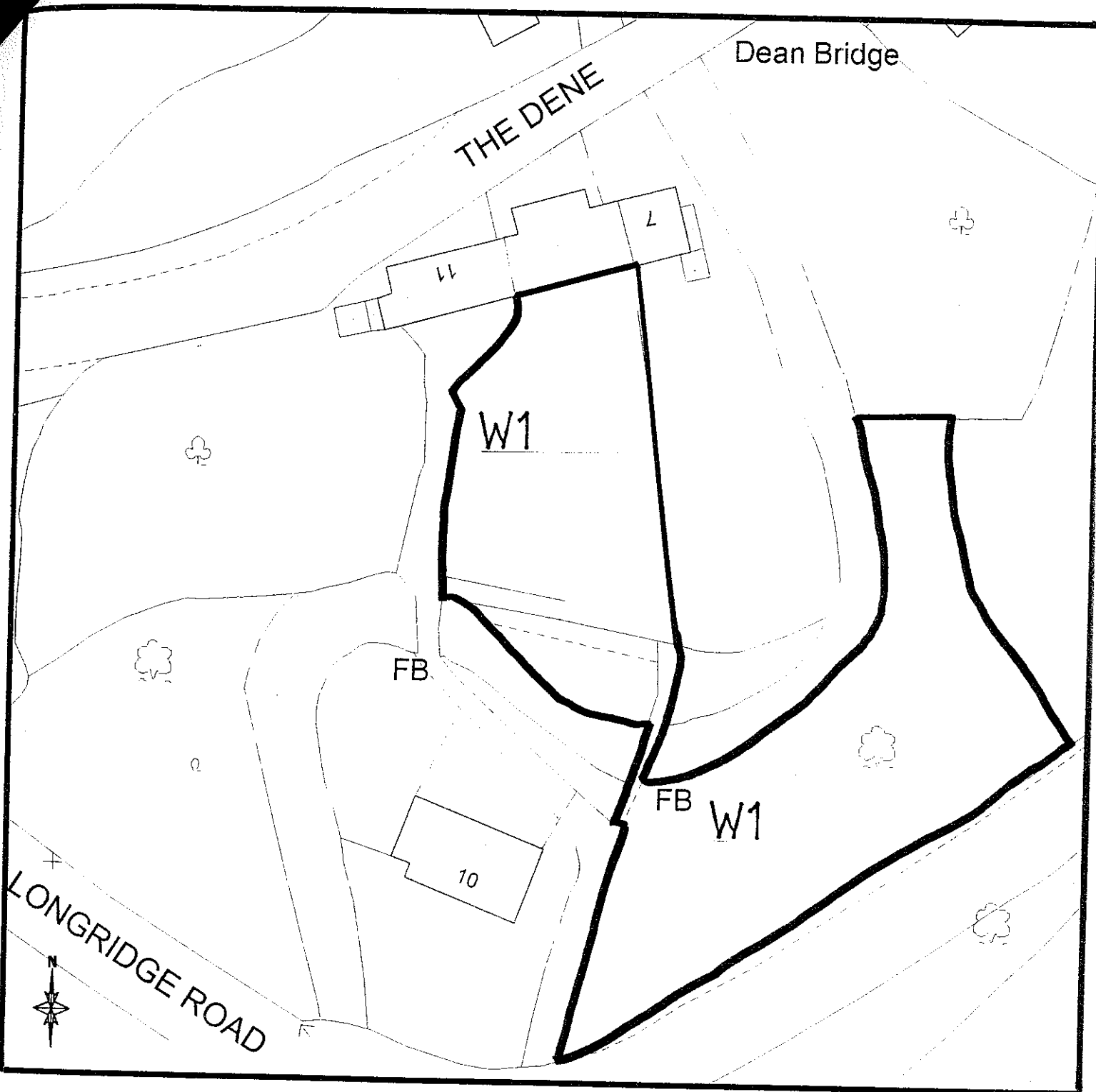

**RIBBLE VALLEY BOROUGH COUNCIL  
TREE PRESERVATION ORDER**

9 THE DENE TREE PRESERVATION ORDER 159

SCALE : 1: 500

REF : DAH

DATE : 14TH JUNE 2000

MODIFIED : 31 JULY 2000

David Morris MIEH ARSH MBIM, Chief Executive  
Ribble Valley Borough Council, Church Walk, Clitheroe, Lancs BB7 2RA (STD 01200 25111)