

FIRST SCHEDULE
TREES SPECIFIED INDIVIDUALLY*
 (encircled in black on the map)

| No. on Map | Description | Situation |
|------------|-------------|--|
| I1 | Birch | North West boundary of land at Apsley House, Lower Lane, Longridge |
| I2 | Birch | |
| I3 | Birch | |
| I4 | Birch | |

TREES SPECIFIED BY REFERENCES TO AN AREA*
 (within a dotted black line on the map)

| No on Map | Description | Situation |
|-----------|-------------|-----------|
| None | None | None |

GROUPS OF TREES*
 (within a broken black line on the map)

| No. on Map | Description | Situation |
|------------|-------------|-----------|
| None | None | None |

WOODLANDS*
 (within a continuous black line on the map)

| No on Map | Description | Situation |
|-----------|-------------|-----------|
| | | |

* The word "NONE" must be entered where necessary

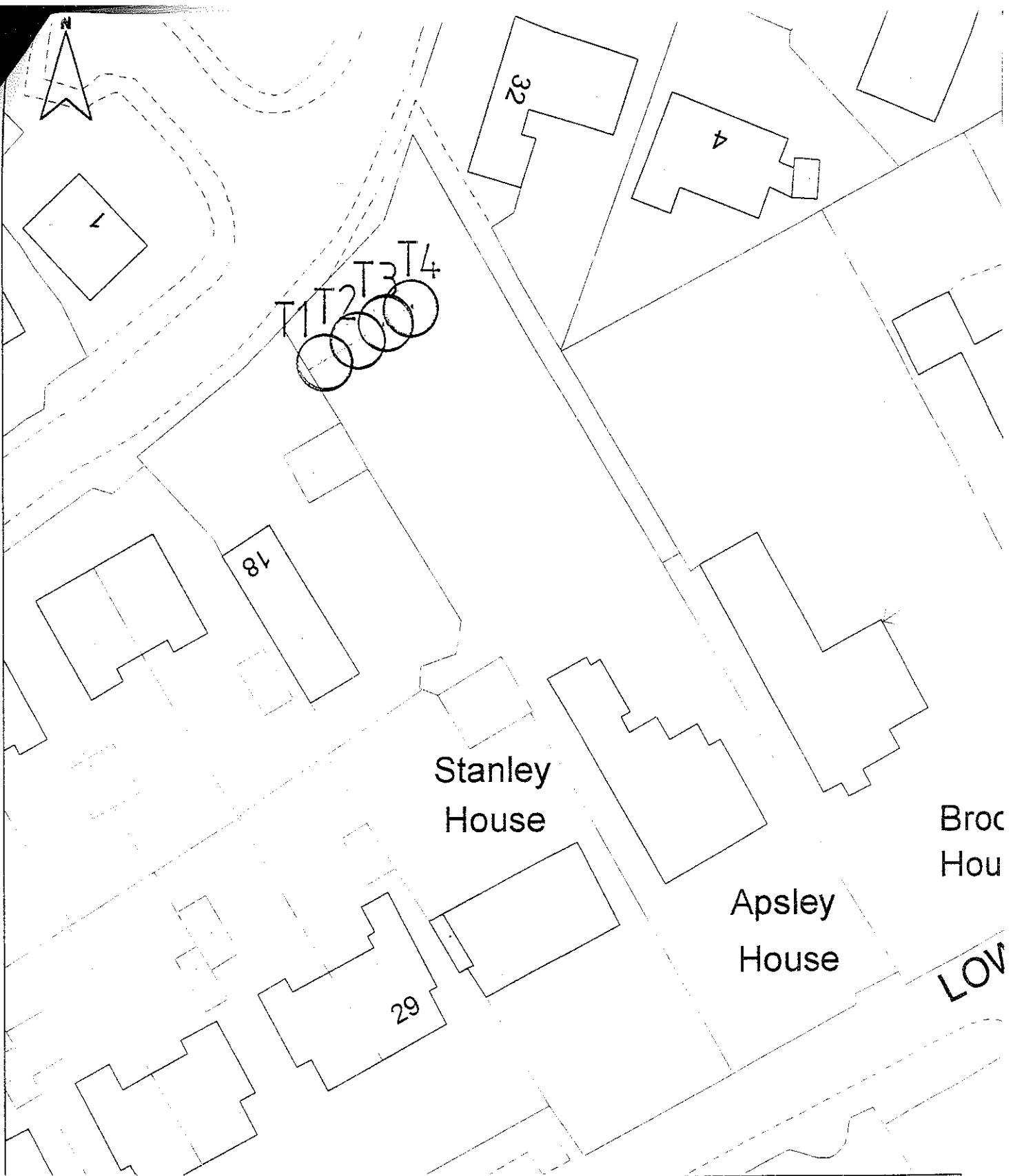

APSLEY HOUSE, LOWER LANE, LONGRIDGE
TREE PRESERVATION ORDER 1999

date: 15/3/99

scale: 1/500

reference: DH/T P O

David Morris MIEH ARSH MBIM, Chief Executive
Ribble Valley Borough Council, Church Walk, Clitheroe, Lancs BB7 2RA (STD 01200 25111)