

FIRST SCHEDULE
TREES SPECIFIED INDIVIDUALLY*
(encircled in black on the map)

No. on Map	Description	Situation
None	None	None

TREES SPECIFIED BY REFERENCES TO AN AREA*
(within a dotted black line on the map)

No. on Map	Description	Situation
None	None	None

GROUPS OF TREES*
(within a broken black line on the map)

No. on Map	Description	Situation
None	None	None

WOODLANDS*
(within a continuous black line on the map)

No. on Map	Description	Situation
W1	Woodland consisting mainly of: <ul style="list-style-type: none"> • Ash • Sycamore • Oak 	Higher Hodder Bridge, Great Mitton 056941

* The word "NONE" must be entered where necessary

SECOND SCHEDULE

This Order shall not apply so as to require the consent of the authority to

(3) the cutting down of any tree on land which is subject to a forestry dedication covenant where

(a) any positive covenants on the part of the owner of the land contained in the same deed as the forestry dedication covenant and at the time of the cutting down binding on the then owner of the land are fulfilled;

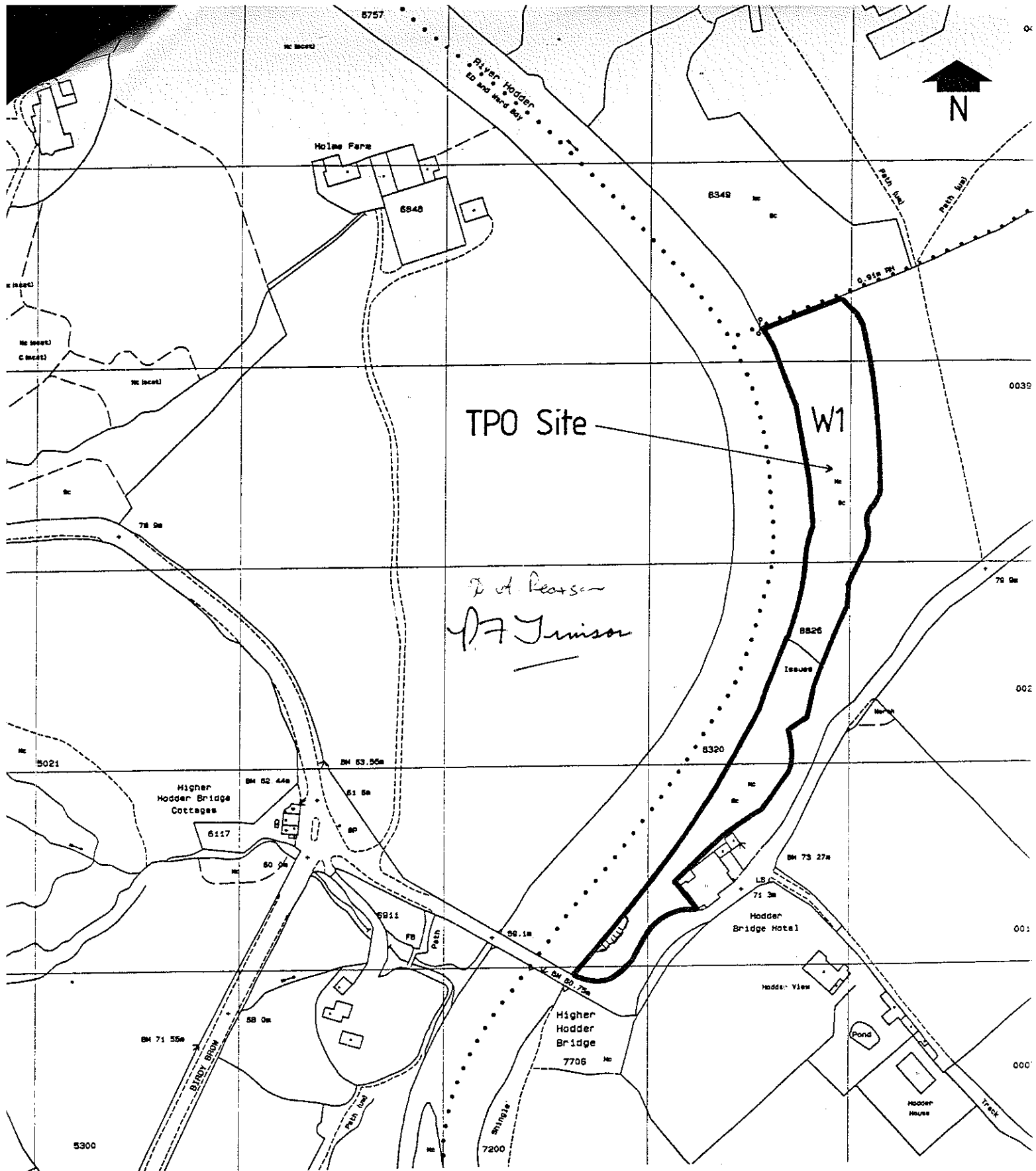

Tree Preservation Order
 Higher Hodder Bridge,
 Great Mitton.

scale
 1/2500th

drawing number
 8/116/1

reference
 LG

date
 April 1996

David Morris, Director of Development
 Ribbles Valley Borough Council, Church Walk, Clitheroe, Lancs. BB7 2RA (STD 01200) 25111