

FIRST SCHEDULE
TREES SPECIFIED INDIVIDUALLY*
(encircled in black on the map)

| No. on Map | Description | Situation |
|------------|-------------|-----------|
| None | None | None |

TREES SPECIFIED BY REFERENCES TO AN AREA*
(within a dotted black line on the map)

| No. on Map | Description | Situation |
|------------|---|--|
| A1 | Area of trees consisting - Sycamore, Cherry, Common Ash, Willow, Beech, Alder, Hawthorn | Land formerly caravan site, Mill Farm, Fell Road, Waddington |

GROUPS OF TREES*
(within a broken black line on the map)

| No. on Map | Description | Situation |
|------------|-------------|-----------|
| None | None | None |

WOODLANDS*
(within a continuous black line on the map)

| No. on Map | Description | Situation |
|------------|-------------|-----------|
| None | None | None |

* The word "NONE" must be entered where necessary

SECOND SCHEDULE

This Order shall not apply so as to require the consent of the authority to

(3) the cutting down of any tree on land which is subject to a forestry dedication covenant where

- (a) any positive covenants on the part of the owner of the land contained in the same deed as the forestry dedication covenant and at the time of the cutting down binding on the then owner of the land are fulfilled;
- (b) the cutting down is in accordance with a plan of operations approved by the Forestry Commission under such deed.

(4) the cutting down of any tree which is in accordance with a plan of operations approved by the Forestry Commission under a grant scheme under section 1 of the Forestry Act 1979 except a scheme which applies to a forestry dedication covenant.

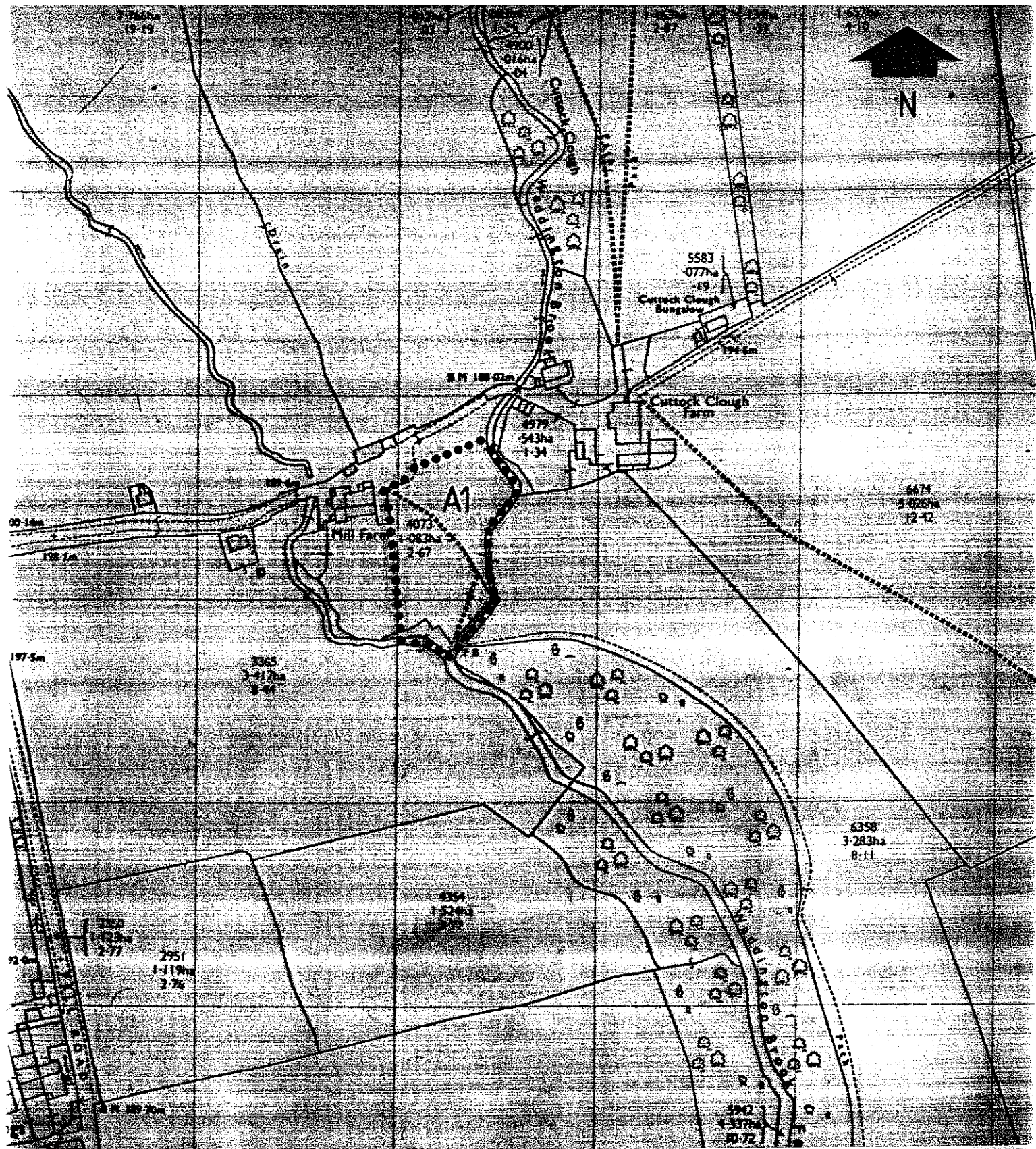

| | | |
|---|----------------|----------|
| Ribble Valley Borough Council Tree Preservation Order Former Caravan Site, Mill Farm, Fell Road, Waddington | scale | 1:2500 |
| | drawing number | 8:89:1 |
| | reference | DH |
| | date | Sept '91 |
| Philip Bailey Dip. Arch. Dip. TP. RIBA. MRTPI. AMBIM. Director of Development & Ribble Valley Borough Council, Church Walk, Clitheroe BB7 2RA (STD 0200) 25111 | | |