

FIRST SCHEDULE:

Trees specified individually (encircled in black on map)

<u>No. on map</u>	<u>Description:</u>	<u>Situation:</u>
T1	Horse Chestnut	Grid Ref: 59543611
T2	Horse Chestnut	Grid Ref: 59573614

Trees specified by reference to an area (within dotted line on the map)

None

Groups of Trees (within a broken black line on the map)

None

Woodlands (within a continuous black line on the map)

None

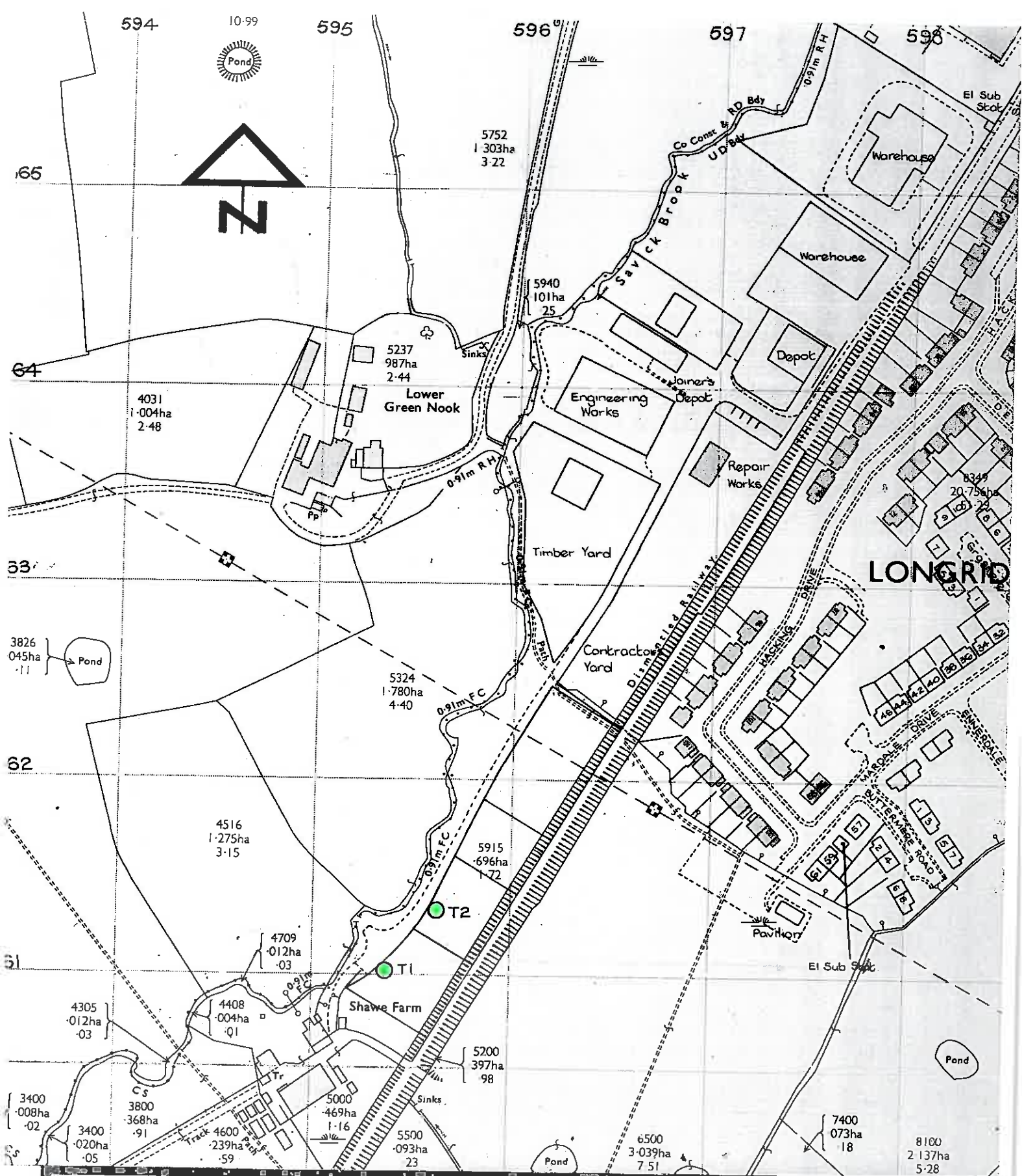

Ribble Valley Borough Council
 (Longridge)
 Tree Preservation Order No 6 1977

scale	1 : 2500
drawing number	8/25/1
reference	
date	May 1977

Charles Wilson, MA, DA(Manc), Dip.Arch, RIBA, MRTPI, Chief Architect & Planning Officer,
 Ribble Valley Borough Council, Princess Avenue, Clitheroe BB7 2AL (STD 0200) 25111