



## **PUBLIC PATH DIVERSION ORDER**

### **HIGHWAYS ACT 1980**

#### **RIBBLE VALLEY BOROUGH COUNCIL**

##### **DIVERSION OF PUBLIC FOOTPATH No.10 DINKLEY (PART)**

This Order is made by Ribble Valley Borough Council (the Authority) under Section 119 of the Highways Act 1980 (the 1980 Act) because it appears to the Authority that in the interests of the owner of the land crossed by the footpaths described in paragraph 1 of this Order it is expedient that the line of the ways should be diverted.

The applicant has agreed to defray any expenses, which are incurred in bringing the new site of the footpath into a fit condition for use by the public. All gates will be provided or modified so that they comply with BS 5907:2006.

##### **BY THIS ORDER:**

1. The public right of way over the land situated at Craven Fold Farm, Dinkley, and shown by bold continuous line on the map contained in this Order and described in Part 1 of the Schedule to this Order shall be stopped up as from the date the Authority certifies that all work to bring the footpath, as described in Part 2 of the Schedule into a fit condition for use by the public has been carried out.
2. There shall at the end of 14 days from the date of confirmation of this Order be a public footpath over the land situated at Craven Fold Farm, Dinkley, described in Part 2 of the Schedule and shown by bold broken lines on the map attached to this Order.
3. The rights conferred on the public under this Order shall be subject to the limitations and conditions set out in Part 3 of the Schedule.



## **SCHEDULE**

### **PART 1**

#### **DESCRIPTION OF SITE OF EXISTING PATH OR WAY**

##### **FOOTPATH 10.**

From Ordnance Survey Grid Reference SD 6947 3643, Point A on the Order Plan in a generally north easterly direction for approximately 236 metres to Ordnance Survey Grid Reference SD 6963 3659, Point B on the Order Plan. The existing path is shown by a bold line on the Order Plan and marked A – B.

### **PART 2**

#### **DESCRIPTION OF SITE OF NEW PATH OR WAY**

##### **FOOTPATH 10.**

The new length of path to be created being 2 metres wide commences from Ordnance Survey Grid Reference SD 6947 3643, Point A on the Order Plan in a generally east north-easterly direction for approximately 145 metres to Ordnance Survey Grid Reference SD 6960 3650, Point C on the Order Plan and then in a generally north north-westerly direction for approximately 90 metres to Ordnance Survey Grid Reference SD 6957 3658, Point D on the Order Plan, and then in a generally east north-easterly direction for approximately 56 metres to Ordnance Survey Grid Reference SD 6962 3661, Point E on the Order Plan, and then in a generally south southeasterly direction for approximately 18 metres to Ordnance Survey Grid Reference SD 6963 3659, Point B on the Order Plan, a total distance of approximately 309 metres. The new path is shown by a bold dashed line on the Order Plan and marked A – C – D – E – B.



**SCHEDULE**

**PART 3  
LIMITATIONS AND CONDITIONS**

1. The right of the owner of the soil to erect and maintain a kissing gate to BS 5907:2006 at Ordnance Survey Grid Reference SD 6963 3659, Point B on the Order Plan.

THE COMMON SEAL OF )  
RIBBLE VALLEY BOROUGH )  
COUNCIL was hereunto )  
affixed this 13<sup>th</sup> day )  
of October 2012 )  
In the presence of: )

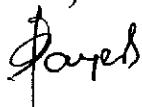

Mayor

M. H. Scott

Chief Executive

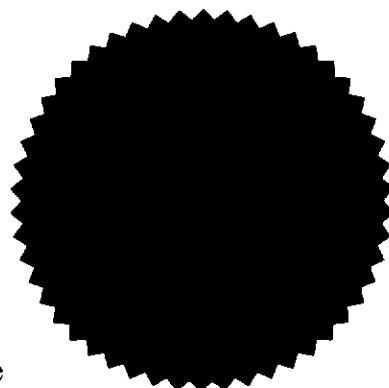

CONFIRMED BY )  
RIBBLE VALLEY BOROUGH )  
COUNCIL as an unopposed )  
Order this 7<sup>th</sup> day of )  
December 2012 )



Mayor

M. H. Scott

Chief Executive

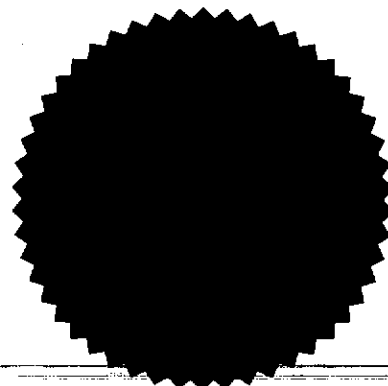

Engineering Section  
Council Offices  
Church Walk  
Clitheroe  
Lancashire. BB7 2RA  
Map Ref: SD6936SE Scale: 1:2500

### Public Path Diversion Order Section 119 Highways Act 1980 Public Footpath No. 10 Dinkley

Crown Copyright. All Rights reserved Ribble Valley Borough Council. Licence No. LA100018641 (2004).  
For reference purposes only, no further copies may be made.

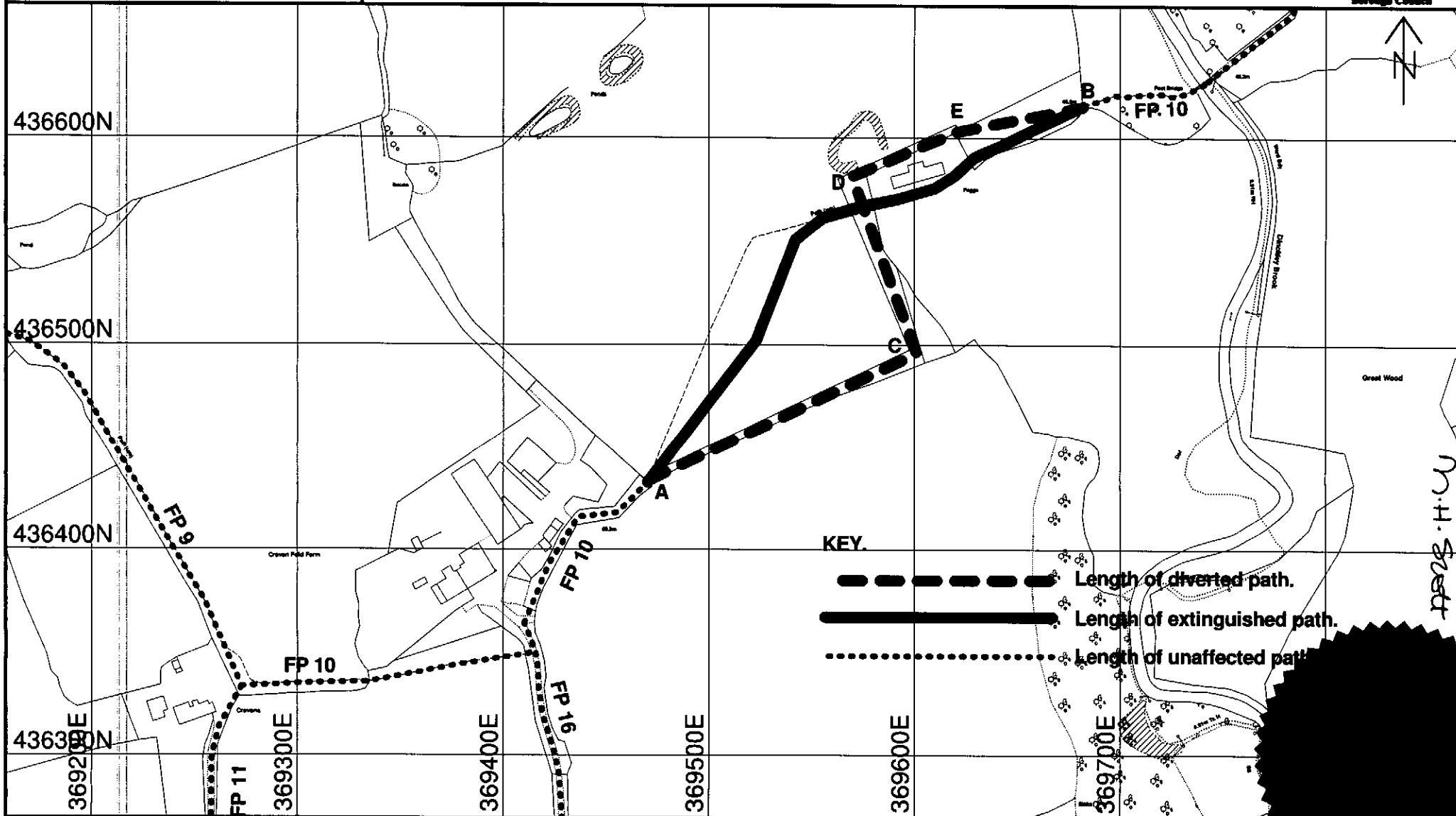

**KEY.**  
- - - - - Length of diverted path.  
————— Length of extinguished path.  
..... Length of unaffected path.

*M.H. Street*  
*Stretts*

