

HOUSING LAND AVAILABILITY SCHEDULE

OCTOBER 2015



Ribble Valley
Borough Council

www.ribblevalley.gov.uk

Ribble Valley Borough Council

HOUSING LAND AVAILABILITY SCHEDULE OCTOBER 2015

Contents

Housing land in Ribble Valley - an introductory overview

Details of large sites, ie over 0.4 hectares

Schedule of small sites, ie under 0.4 hectares

Location maps for small sites within the Borough

Date of Survey: 30 September 2015

Disclaimer

The factual information within this booklet is believed to be correct at the time of survey. Each site has been identified from approved planning applications. Whilst every effort is made to give accurate information no responsibility can be accepted for matters arising due to the information in this document being incorrect in any detail whatsoever.

M Scott
Chief Executive
Chief Executive's Department
Council Offices
Church Walk
Clitheroe BB7 2RA
Tel: 01200 425111

1. This table and graph show the recent build rates from 1 April 2008 to 30 September 2015 and are split between new build and conversions.

COMPLETIONS	NEW BUILD	CONVERSIONS CHANGE OF USE	TOTAL COMPLETIONS
1 April 2008 - 31 March 2009	58	17	75
1 April 2009 - 31 March 2010	57	32	89
1 April 2010 - 31 March 2011	36	33	69
1 April 2011 - 31 March 2012	116	31	147
1 April 2012 - 31 March 2013	121	51	172
1 April 2013 - 31 March 2014	155	28	183
1 April 2014 - 31 March 2015	316	29	345
1 April 2015 - 30 September 2015	118	16	134

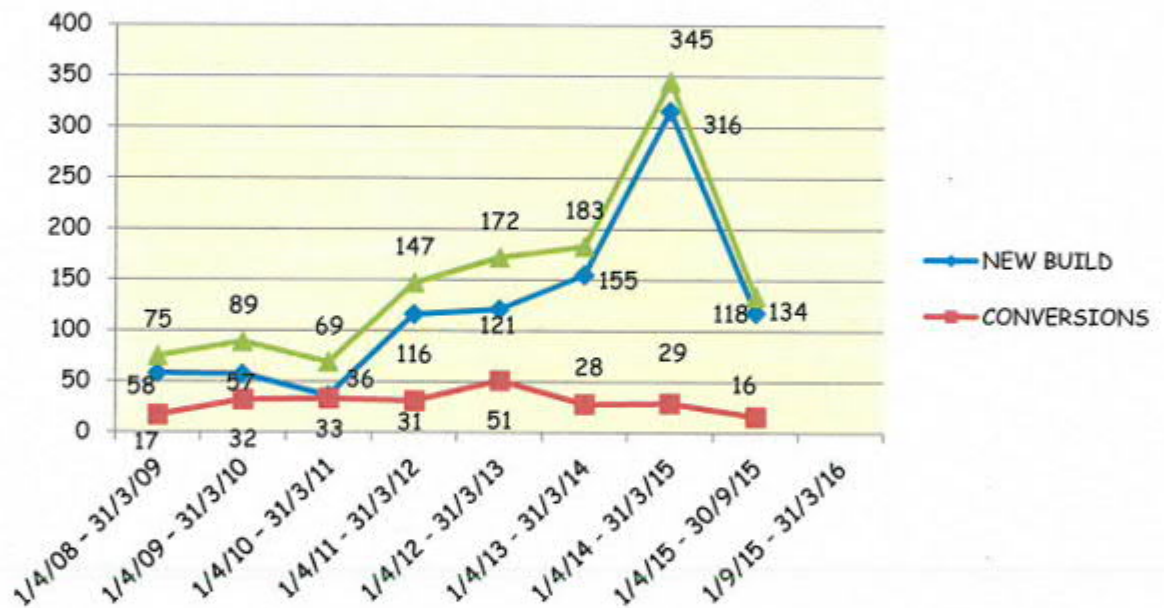

2. This table and graph show the number of completions since 1 April 2008 to 30 September 2015 on brownfield and greenfield sites

BROWNFIELD/GREENFIELD COMPLETIONS			
YEAR	BROWNFIELD	GREENFIELD	TOTAL
1/4/08 - 31/3/09	65	10	75
1/4/09 - 31/3/10	76	13	89
1/4/10 - 31/3/11	64	5	69
1/4/11 - 30/3/12	144	3	147
1/4/12 - 31/3/13	140	32	172
1/4/13 - 31/3/14	105	78	183
1/4/14 - 31/3/15	114	231	345
1/4/15 - 30/9/15	43	91	134

BROWNFIELD/GREENFIELD COMPLETIONS

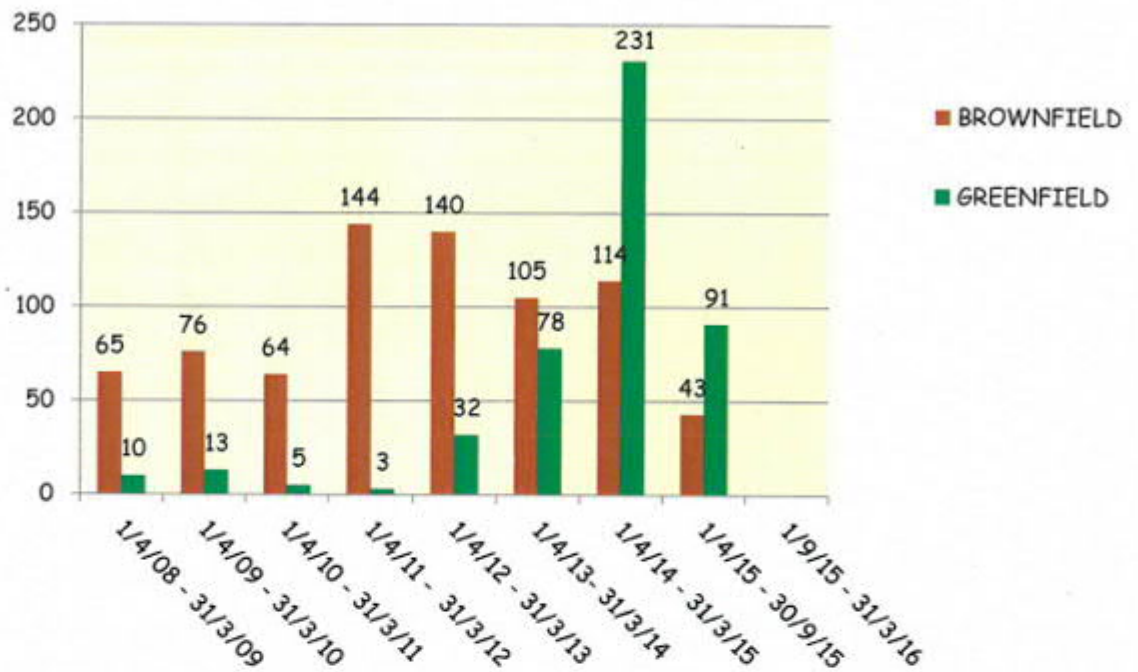

3. This table and graph show the number of completions since 1 April 2008 to 30 September 2015 of Affordable completions.

AFFORDABLE COMPLETIONS	
YEAR	NUMBER DWELLINGS
1/4/08 - 31/3/09	37
1/4/09 - 31/3/10	43
1/4/10 - 31/3/11	27
1/4/11 - 30/3/12	61
1/4/12 - 31/3/13	29
1/4/13 - 31/3/14	45
1/4/14 - 31/3/15	113
1/4/15 - 30/9/15	33
TOTAL	355

AFFORDABLE COMPLETIONS

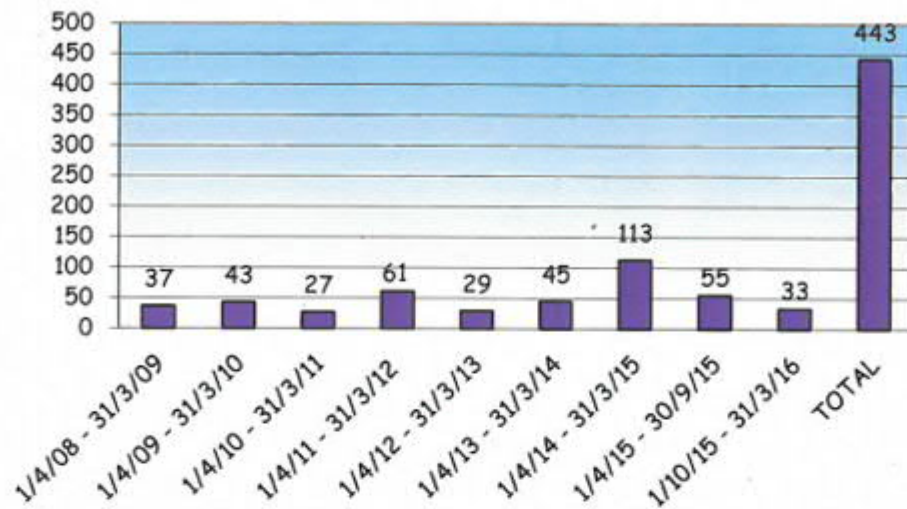

4. In the current housing land there are 4074 dwellings currently with planning permission and they are situated within Clitheroe, Longridge, Whalley and other parishes.

LOCATION OF CONSENTS

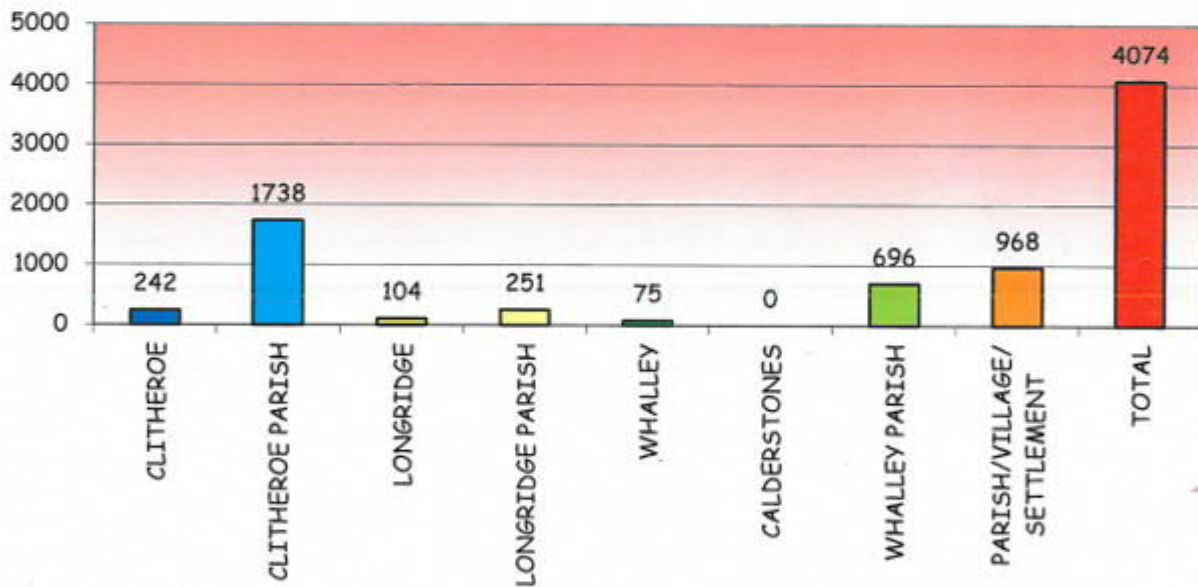

5. The Core Strategy was formally adopted at a meeting of the Full Council on 16 December 2014. Land for residential development will be made available to deliver 5,600 dwellings, estimated at an average annual completion target of at least 280 dwellings per year over the period 2008 to 2028. In terms of the calculation of housing supply, the Council adopt the Sedgefield approach.
6. Since 2008 a total of 1214 dwellings have been completed.

HOUSING LAND AVAILABILITY 30 SEPTEMBER 2015

All known sites	No of Dwellings	No Sites	Area Ha
1. Sites with full planning permission	365	49	18.60
2. Sites outline planning permission	1987	35	84.04
3. Sites on which development has commenced part of site not started	312	4	11.29
4. Sites on which development has started, units under construction	334	45	14.17
5. Conversions to dwellings (not started)	80	50	4.36
6. Conversions to dwellings, development commenced	47	31	2.66
7. Affordable housing sites (not started)*	949	2	40.36
TOTAL	4074	216	175.48

NOTE

Net total of dwellings

See pages 5 & 6 for breakdown of this table

*24 sites are included in sites over 0.4ha

*1 site is included in sites of less than 0.4ha with planning permission

*2 sites all affordable units are included in affordable housing sites - not started

1. SITES WITH FULL PLANNING PERMISSION			
NO DWLS	NO SITES	HA	LOCATION
75	41	4.05	Small Sites
10	1	0.68	Land off Chatburn Old Road, Chatburn
91	1	3.48	Land off Henthorn Road, Clitheroe
9	1	0.47	15 Parker Avenue, Clitheroe
3	1	0.54	Land off Mill Lane, Gisburn
23	1	0.96	Strawberry Fields, Main Street, Gisburn
21	1	1.71	Land North Whalley Road, Hurst Green
37	1	2.37	Land Chapel Hill, Longridge
96	1	4.34	Land Mitton Road, Whalley
365	49	18.60	TOTAL

2. SITE WITH OUTLINE PERMISSION			
NO DWLS	NO SITES	HA	LOCATION
35	14	2.09	Small Sites
6	1	0.51	Land off Clitheroe Road, Barrow
16	1	0.79	Land at 23-25 Old Row, Barrow
5	1	0.50	Land Whiteacre Lane, Barrow
353	1	12.79	Land SW & W Whalley Road, Barrow
30	1	1.34	Hanson Garden Centre, Whalley Road, Barrow
27	1	1.16	Land off Dale View, Billington
16	1	1.27	Land at Chatburn Road, Clitheroe
22	1	1.00	Land adj Greenfield Avenue, Clitheroe
8	1	0.55	Land adj St Paul's Church, Clitheroe
728	1	31.68	Standen Farm & Littlemoor Farm, Clitheroe
34	1	1.21	Land NW of Littlemoor, Clitheroe
35	1	0.86	Land Milton Avenue, Clitheroe
13	1	0.52	Land off Pimlico Link Road, Clitheroe
81	1	2.48	Land SW Primrose Village, Clitheroe
192	1	6.42	Land off Waddington Road, Clitheroe
13	1	3.90	Land off Longsight Road, Langho
136	1	6.99	Land North of Dilworth Lane, Longridge
22	1	1.22	Spout Farm, Preston Road, Longridge
17	1	0.63	Land r/o Pendle Street East, Sabden
54	1	2.08	Land at Accrington Road, Whalley
144	1	4.05	Lawsonsteads, Whalley - Whole Site
1987	35	84.04	TOTAL

3. SITES DEVELOPMENT COMMENCED, PART OF SITE NOT STARTED			
NO DWLS	NO SITES	HA	LOCATION
2	2	0.10	Small Sites
51		2.11	Middle Lodge Road, Barrow
23	1	1.00	Dale View, Billington
30		1.24	Nab Rise, Painter Crescent, Billington
18		0.50	Land off Elker Lane, Billington
45		1.38	Land Henthorn Road, Clitheroe
29		0.62	Primrose Mill Site, Clitheroe
2		0.16	Cherry Drive, Brockhall Village
1	1	0.14	Hillside, Brockhall Village
14		0.70	1-15 Anchor Hill Close, Ribchester
27		1.25	Clitheroe Road, Springwood Drive, Whalley
70		2.09	Land North of Riddings Lane, Whalley
312	4	11.29	TOTAL

4. SITES DEVELOPMENT STARTED, UNDER CONSTRUCTION			
NO DWLS	NO SITES	HA	LOCATION
66	29	2.88	Small Sites
40	1	1.66	Middle Lodge Road, Barrow
8	1	0.50	Lamb Roe Gardens, Barrow
22	1	0.91	Nab Rise, Painter Crescent, Billington
1	1	0.03	Land off Elker Lane, Billington
78	1	2.39	Henthorn Road, Clitheroe
31	1	0.66	Primrose Mill Site, Clitheroe
14	1	0.54	Water Meadows, Longridge
1	1	0.08	Cherry Drive, Brockhall Village
4	1	0.31	Eden Gardens, Brockhall Village
9	1	0.64	Meadow View, Whins Lane, Read
1	1	0.05	1-15 Anchor Hill Close, Ribchester
19	1	0.88	Clitheroe Road, Springwood Drive, Whalley
7	1	0.46	100-112 even, Clitheroe Road, Whalley
1	1	0.03	Land North of Riddings Lane, Whalley
28	1	0.71	Wheatsheaf Close, Whalley
4	1	1.44	Land at Bennetts Close, Whalley
334	45	14.17	TOTAL

5. CONVERSIONS NOT STARTED			
NO DWLS	NO SITES	HA	LOCATION
80	50	4.36	Small Sites
80	50	4.36	TOTAL

6. CONVERSIONS STARTED			
NO DWLS	NO SITES	HA	LOCATION
44	30	2.22	Small Sites
3	1	0.44	The Grange, Clayton-le-Dale
47	31	2.66	TOTAL

7. AFFORDABLE NOT STARTED			
NO DWLS	NO SITES	HA	LOCATION
949	2	40.36	
949	2	40.36	TOTAL

PARISH OR TOWN/VILLAGE	TOTAL COMPLETIONS 1.4.08 - 30.9.15	EXTANT PERMISSIONS AS AT 39.9.15	TOTAL COMPLETIONS & EXTANT PERMISSIONS 1.4.08 - 30.9.15
ABC PARISH	5	45	50
HURST GREEN	6		6
BALDERSTONE PARISH	4	2	6
BASHALL EAVES PARISH	6		6
BILLINGTON & LANGHO PARISH	75	108	183
BROCKHALL VILLAGE	33	10	43
BILLINGTON	8	52	60
LANGHO	1	5	6
BOLTON-BY-BOWLAND	1		1
BOLTON-BY-BOWLAND PARISH	6	3	9
HOLDEN			
BOWLAND FOREST HIGH PARISH	15	1	16
DUNSOP BRIDGE			
BOWLAND FOREST LOW PARISH			
BOWLAND WITH LEAGRAM PARISH	2	2	4
CHATBURN PARISH	1	14	15
CHATBURN	7	2	9
CHIPPING PARISH	7	14	21
CHIPPING	5	12	17
CLAYTON-LE-DALE PARISH	8	8	16
CLITHEROE PARISH	211	1738	1949
CLITHEROE	207	242	449
DINCKLEY PARISH	3	1	4
DOWNHAM PARISH			
DOWNHAM			
DUTTON PARISH	3		3
EASINGTON PARISH		5	5
GISBURN PARISH		33	33
GISBURN	2	9	11
GISBURN FOREST PARISH	2		2
TOSSIDE	1		1
GREAT MITTON PARISH	6		6
GRINDLETON PARISH	5	3	8
GRINDLETON	1	3	4
HORTON PARISH	1	3	4
HOTHERSALL PARISH	1		1
LITTLE MITTON PARISH	1		1
LONGRIDGE PARISH	115	251	366
LONGRIDGE	60	104	164
MEARLEY PARISH			
MELLOR PARISH	4	1	5
MELLOR	19	1	20
MELLOR BROOK	2	16	18
MIDDOP PARISH			
NEWSHOLME PARISH			
NEWTON PARISH	1		1
NEWTON	1		1
OSBALDESTON PARISH	1		1
OSBALDESTON			
PAYTHORNE PARISH	1	2	3
PENDLETON PARISH	4	1	5
PENDLETON			
RAMSGREAVE PARISH			
READ PARISH	1	4	5
READ	13	12	25
RIBCHESTER PARISH	5	18	23
RIBCHESTER	3	7	10
RIMINGTON PARISH	2	2	4
RIMINGTON	1	7	8
SABDEN PARISH	16	2	18
SABDEN	52	24	76
SALESBURY PARISH			
SALESBURY			
COPSTER GREEN	19		19
SAWLEY PARISH	1	3	4

PARISH OR TOWN/VILLAGE	TOTAL COMPLETIONS 1.4.08 - 30.9.15	EXTANT PERMISSIONS AS AT 30.9.15	TOTAL COMPLETIONS & EXTANT PERMISSIONS 1.4.08 - 30.9.15
SAWLEY	1		1
SIMONSTONE PARISH	2	3	5
SIMONSTONE			
SLAIDBURN PARISH	2	1	3
SLAIDBURN			
THORNLEY-WITH-WHEATLEY PARISH	4	3	7
TWISTON PARISH	1		1
WADDINGTON PARISH	2	1	3
WADDINGTON	7	2	9
WEST BRADFORD PARISH	1	6	7
WEST BRADFORD	3		3
WHALLEY PARISH	15	688	703
WHALLEY	11	75	86
CALDERSTONES	85		85
WILPSHIRE PARISH		3	3
WILPSHIRE	10	13	23
WISWELL PARISH		394	394
WISWELL			
BARROW	115	115	230
WORSTON PARISH			
WORSTON			
TOTALS	1214	4074	5288

Note: After a community governance review as from 1 April 2015 a new Parish of Barrow has been formed. For the purpose of this table the new Barrow Parish is not used

UNSIGNED SECTION 106'S AS AT 30 SEPTEMBER 2015		
APP NO	LOCATION	NO OF DWELLINGS
3/2014/0764	Land East of Chipping Lane Longridge	363
3/2014/1018	Barnacre Road Longridge	33
3/2015/0266	Primrose Works Primrose Road Clitheroe	18
3/2015/0347	Land off Towneley Road Longridge	12
	UNSIGNED	426

Housing land calculation at 30th September 2015

Annualised requirement

The Core Strategy was adopted on 16th December 2014. Policy H1 sets an overall requirement of 5600 dwellings for the plan period 2008 - 2028 which equates to 280 dwellings per year. The 5 year requirement is calculated as follows:

A	Planned provision 2008 - 2028	5600
B	Annual equivalent	280
C	Five year requirement (Bx5)	1400
D	Plus 20% buffer - NPPF para. 47 (B+C)	1680
E	Completions 1/4/2008 - 30/9/2015 (7.5 years)	1214
F	Shortfall [(7.5x B)-E]	886
G	Total five year requirement (D+F)	2566
H	Annual requirement (G÷5)	513

Five Year Supply calculation

Sites subject to Section 106 Agreements	426
Sites with planning permission not started (market units only):	
Sites with full permission	365
Sites with outline permission	1987
Conversions not started	80
Affordable Units not started	949
<i>Sub total:</i>	<i>3807</i>
Less dwellings on sites not deliverable (see note 1)	9
Less dwellings on large sites deliverable beyond 5 year period (see note 2)	1369
Less fewer dwellings on Lawsonsteads site (see note 2)	46
<i>Sub total:</i>	<i>2383</i>
Less 10% slippage	238
<i>Sub total:</i>	<i>2145</i>
Plus sites under construction	334
Plus conversions under construction	47
Plus dwellings not started on sites under construction	312
Less sites not currently active (see note 3)	45
Plus windfall allowance (see note 4)	115
TOTAL	2908

Five year supply position

Identified supply ÷ annualised requirement

= 2908 ÷ 513

= 5.67

Explanatory notes

Sites with planning permission are usually considered deliverable in accordance with NPPF¹. The sites in the following sections have planning permission but are excluded in whole or in part from the 5 year supply at the relevant points in the calculation.

1. Specific sites not deliverable in 5 years

The following site is deducted due to specific deliverability issues:

Sites with planning permission	Total no.	Market units	Affordable Units	Development status
Pack Horse Garage	9	9	0	Not started
total	9	9	0	

2. Large sites

Large sites with planning permission must be considered in terms of their contribution to housing delivery in the five year period. Where possible, allowances are based on information provided by developers/agents. If this is not forthcoming officer estimates are made.

The Strategic site at Standen is identified in the Core Strategy and has outline planning permission for mixed development which includes 1040 dwellings of which 312 are affordable. For the purposes of the five year supply, based on information provided by the agent, the site is estimated to contribute about 100 dwellings per year for the latter three years of the five year period.

The site south and west of Barrow was granted outline permission on appeal in February 2014 for 504 dwellings of which 151 are affordable. Information provided by the agent supports the delivery of the site in five years at a rate of 100 dwellings per year using 4 builders. For the purposes of the five year supply, the site is estimated to contribute about 100 dwellings per year for the latter three years of the five year period.

The Core Strategy Inspector, in finding the plan sound, considered these figures to be broadly reasonable.

A site at land off Waddington Road, has outline planning permission for up to 275 dwellings. For the purposes of five year supply, it is assumed that the site could deliver 50 dwellings a year for the latter three years of the plan period, allowing a two year lead in due to the outline permission.

The site north of Dilworth Lane Longridge has outline planning permission for 195 dwellings. A reserved matters application was submitted in August 2015 for the same number of dwellings. It is estimated that the site will deliver 138 dwellings in the five year period based on a delivery programme forming part of the reserved matters application. It is noted that since the September survey, the reserved matters scheme has been approved (13/11/15 ref: 3/2015/0688).

The site East of Chipping Lane, Longridge has been considered by the Council and the decision to grant planning permission was deferred (as at 30/11/15) pending the completion of a Section 106

¹ NPPF para. 47, footnote 11

Agreement. It is noted that since the September survey the section 106 has been completed and outline permission approved (29/10/11 ref: 3/2014/0764). It is estimated that approx. 120 dwellings will be delivered in the five year period.

The allowances are shown in the table below.

Site	Reference	Status at 31/3/2015	Total dwelling capacity	Allowance in 5 year period	Remainder deliverable beyond 5 years
land at Higher Standen Farm & part Littlemoor Farm	3/2012/0942	Outline planning permission granted 17/4/14. Core Strategy Strategic site	1040	300	740
Land to the south and west of Barrow and west of Whalley Road, Barrow	3/2012/0630	Outline planning permission granted on appeal 20/2/2014	504	300	204
Land off Waddington Road, Clitheroe	3/2014/0597	Outline planning permission granted 6/3/13	275	150	125
Land North of Dilworth Lane, Longridge	3/2015/0065 3/2015/0688	Outline approved 31/3/15 Reserved matters (subsequently approved 13/11/15)	195	138	57
Land East Chipping Lane Longridge	3/2014/0764	Outline planning application awaiting completion of S106 at 301/11/15	363	120	243
TOTAL			2377	1008	1369

A further site at Lawsonsteads has an extant outline planning permission for 206 dwellings. A current application for Reserved Matters indicates a lower number of 160 dwellings. Although the RM application is not yet determined, this amounts to a reduction of 46 dwellings.

Future monitoring will identify whether any changes need to be made in the light of the progression of the sites and development activity.

3. Sites under Construction:

A number of sites have commenced but are currently not active so are deducted from the five year supply as follows:

Site	Application ref	No of dwellings	Commenced
Conversions/changes of use - commenced			
Trough House Farm Lambing Clough Lane, Hurst Green	3/1995/0474	1	13/5/97
The Old School Cottage Forest Becks Farm, Bolton By Bowland	3/1997/0571 3/2002/0511	1	27/2/07
Woodfield Barn Woodfields, Stonyhurst	3/2007/0504	2	2/8/07
New Barn Whalley Road, Stonyhurst	3/2007/0505	3	2/8/07
Horrocks Barn Horrocks Fold, Stonyhurst	3/2007/0506	1	2/8/07
16/18/18A Well Terrace Clitheroe	3/2008/0775	3	7/5/09
Sub total		11	
New build under construction (small)			
Land at Padiham Road Sabden	3/2005/0429	1	
Land adj Alderleigh Henthorn Road, Clitheroe	3/1994/0128	1	
Hesketh End Judd Holmes Lane, Chipping	3/2007/0246	1	
Land at Higher Highfield Farm Tinklers Lane, Slaidburn	3/2006/0586	1	
26, 26a 28 Bosburn Drive Mellor Brook	3/2009/0765	3	
Eden Gardens Brockhall Gardens	3/2012/0103	4	
Sub total		11	
TOTAL		22	

A further site at Dale View Billington, (total no.49) has been part built. 26 dwellings are complete but a further 23 remain not started and are unlikely to be developed, with no current activity. Therefore the 23 are deducted from the calculation.

New build under construction (large)			
Land off Dale View Billington	various	23	-
Sub total		23	

A total of 45 units is deducted from sites under construction in the calculation.

4. Windfall Allowance

A windfall allowance is included, based on past development rates and in accordance with definitions in NPPF para. 48 and its glossary.

Past trends have only been considered in relation to the Principal Settlements of Clitheroe; Longridge and Whalley where the Core Strategy seeks to direct the majority of housing development; and the Tier 1 settlements of Barrow, Billington, Chatburn, Gisburn, Langho,

Mellor, Mellor Brook, Read and Simonstone (taken and as single settlement) and Wilpshire where a limited amount of development might be allowed in accordance with the Core Strategy. Past trends were not considered in the remaining 23 Tier 2 settlements and locations outside any settlement as the Core Strategy does not anticipate that a significant number of dwellings will come forward in these locations unless certain criteria are met. .

To ensure a realistic assessment in accordance with the NPPF guidance/criteria past developments were only considered for new build or conversions to new dwellings granted permission since 2008 (base date of the Core Strategy) where:

- The dwellings were constructed or under construction at 31st March 2014 (i.e. the permission had been implemented. Lapsed permissions and permissions not started are excluded);
- The sites were within the settlement boundaries (as defined on the former District wide local plan);
- The site was a brownfield site; and
- The site is not a residential garden.

Thresholds were also applied to ensure large sites did not skew trends as follows:

Clitheroe, Whalley and Longridge: 10 dwellings
Tier One settlements: 5 dwellings

Information from in-house housing land monitoring in accordance with the above criteria shows the following:

No. Dwellings completed or under construction on brownfield sites 2008-2014

	2008/9	2009/10	2010/11	2011/12	2012/13	2013/14	TOTAL
Clitheroe	9	12	3	4	19	14	61
Longridge	8	13	6	6	6	8	47
Whalley	6	3	0	0	0	0	9
Barrow	0	0	0	1	0	0	1
Billington	1	0	0	0	0	0	1
Chatburn	2	1	0	0	4	0	7
Gisburn	0	1	0	0	1	0	2
Langho	0	1	0	0	0	0	1
Mellor	0	0	0	0	0	0	0
Mellor Brook	0	0	0	0	0	0	0
Read and Simonstone	1	0	2	0	0	0	3
Wilpshire	1	2	0	2	0	0	5
	28	33	11	13	30	22	137

A total of 137 dwellings were built or under construction in a six year period. This amounts to about 23 dwellings per year. A five year equivalent would be 115.

The allowance will be monitored, perhaps annually, to show if it needs to be modified. The inclusion of a windfall allowance does not imply that planning permission will be forthcoming for a particular development.

SITES OVER 0.4HA

**MIDDLE LODGE ROAD, WATERSIDE REACH, SHEEPFOLD
CRESCENT, NORTHACRE DRIVE, HAZELNUT COURT, BARROW**

OS Grid Reference: 373979 438040 Site Size ha: 4.35ha No Dwellings: 105

Planning Status: Full 3/2013/0771; 3/2014/0944; 3/2015/0101; Outline 3/2012/0158

Applicant or Agent:
Bloor Homes (North West) Ltd
2-4 Whiteside Business Park
Station Road
Holmes Chapel
Cheshire CW4 8AA



*Erection of 85 open market
dwellings & 20 affordable dwellings*

CROWN COPYRIGHT RIBBLE VALLEY BOROUGH COUNCIL LA100018641

Development Stage

Started? *yes*

Completions: *14dw*

Under Construction: *40dw / 1.66ha*

Remaining area to be developed: *51dw / 2.11ha*

LAND OFF CLITHEROE ROAD, BARROW

OS Grid Reference: 373634 437794 Site Size ha: 0.77ha No Dwellings: 9

Planning Status: Outline 3/2013/0511

Applicant or Agent:

Mr J Ashcroft
Huntingdon Hall
Huntingdon Hall Lane
Dutton
Lancs PR3 2ZT



*Erection of 9 dwellings of which
3 are affordable bungalows*

CROWN COPYRIGHT RIBBLE VALLEY BOROUGH COUNCIL LA079111

Development Stage

Started? *no*

Completions: *n/a*

Under Construction: *n/a*

Remaining area to be developed: *6dw / 0.51ha*

LAMB ROE GARDENS, BARROW

OS Grid Reference: 373568 437508 Site Size ha: 0.50 No Dwellings: 8

Planning Status: Full 3/2014/1061

Applicant or Agent:

Applethwaite Ltd
Quarry Warehouse
Sandside
Milnthorpe
LA7 7HG

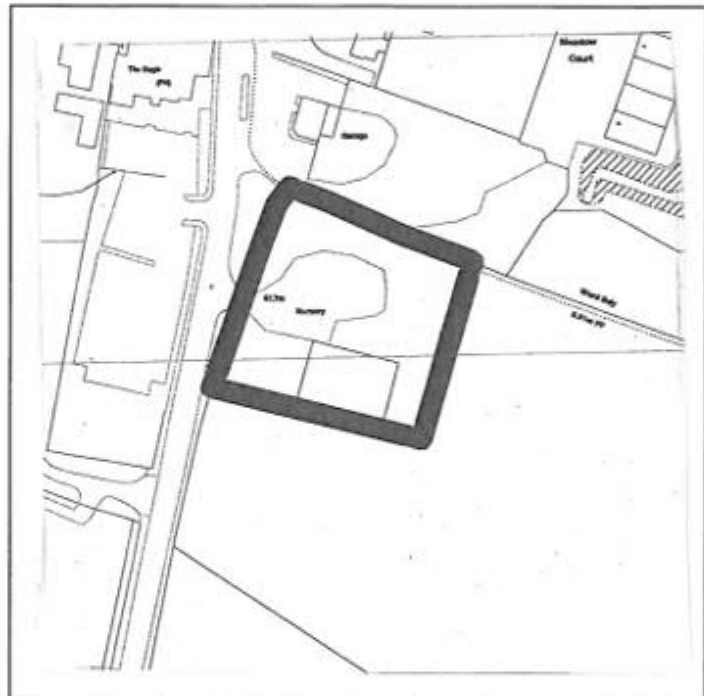

Erection of 8 bungalows for the over 55s

CROWN COPYRIGHT RIBBLE VALLEY BOROUGH COUNCIL LA100018641

Development Stage

Started? *yes*

Completions: *n/a*

Under Construction: *8dw / 0.50ha*

Remaining area to be developed: *0dw*

LAND AT 23-25 OLD ROW, BARROW

OS Grid Reference: 373876 438431 Site Size ha: 1.13ha No Dwellings: 23

Planning Status: Outline 3/2012/0623

Applicant or Agent:
Admiral Taverns Ltd
C/o Agent
Caldecotte Consultants
Unit A Bourton Business Centre
Manor Farm
Buckingham
Bucks MK18 7DS

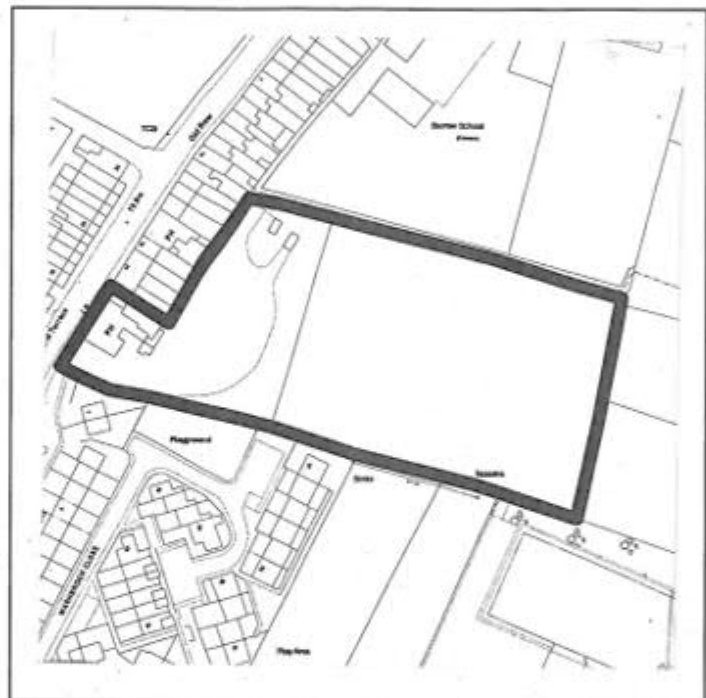

Erection of 23 dwellings of which
7 are affordable

CROWN COPYRIGHT RIBBLE VALLEY BOROUGH COUNCIL LA100018641

Development Stage

Started? no

Completions: n/a

Under Construction: n/a

Remaining area to be developed: 16dw / 0.79ha

LAND AT WHITEACRE LANE, BARROW

OS Grid Reference: 374072 437851 Site Size ha: 0.70ha No Dwellings: 7

Planning Status: Outline 3/2011/0776

Applicant or Agent:

Mr M Kay
Church Farm
Thornham Parva
Eye
Suffolk IP23 8EY

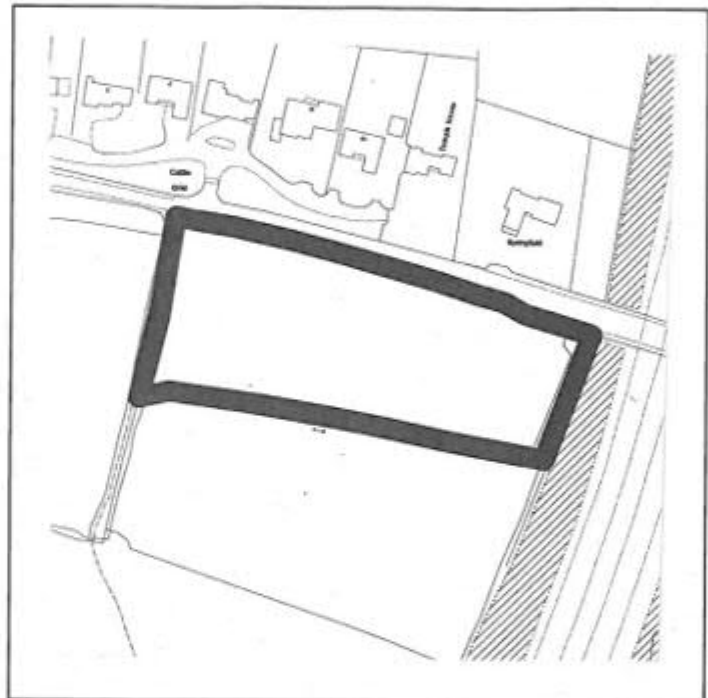

Erection of 7 dwellings of which
2 are affordable

CROWN COPYRIGHT RIBBLE VALLEY BOROUGH COUNCIL LA079111

Development Stage

Started? *no*

Completions: *n/a*

Under Construction: *n/a*

Remaining area to be developed: *5dw / 0.50ha*

LAND TO SOUTH-WEST OF BARROW & WEST OF WHALLEY ROAD, BARROW

OS Grid Reference: 373362 438104 Site Size ha: 18.26ha No Dwellings: 504

Planning Status: Outline 3/2012/0630; 3/2013/0099

Applicant or Agent:

*The Barrow Lands Company Ltd
1 Kingsland Passage
London*

3/2012/0630 - Outlined in black on
map

*Erection of 504 dwellings (353
market & 151 affordable)*

3/2013/0099 - Hatched on map

*Erection of 190 dwellings
(57 affordable)*

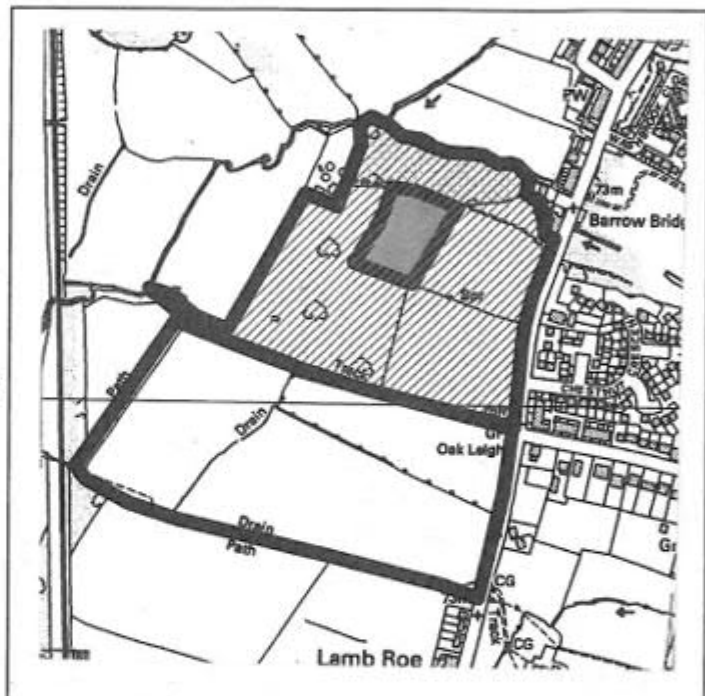

CROWN COPYRIGHT RIBBLE VALLEY BOROUGH COUNCIL LA100018641

Development Stage

Started? *no*

Completions: *n/a*

Under Construction: *n/a*

Remaining area to be developed: *353dw / 12.79ha*

HANSON GARDEN CENTRE, WHALLEY ROAD, BARROW

OS Grid Reference: 373884 438858 **Site Size ha:** 1.92ha **No Dwellings:** 43

Planning Status: *Outline 3/2013/0737*

Applicant or Agent:
Mr Chris Hanson
C/o Agent

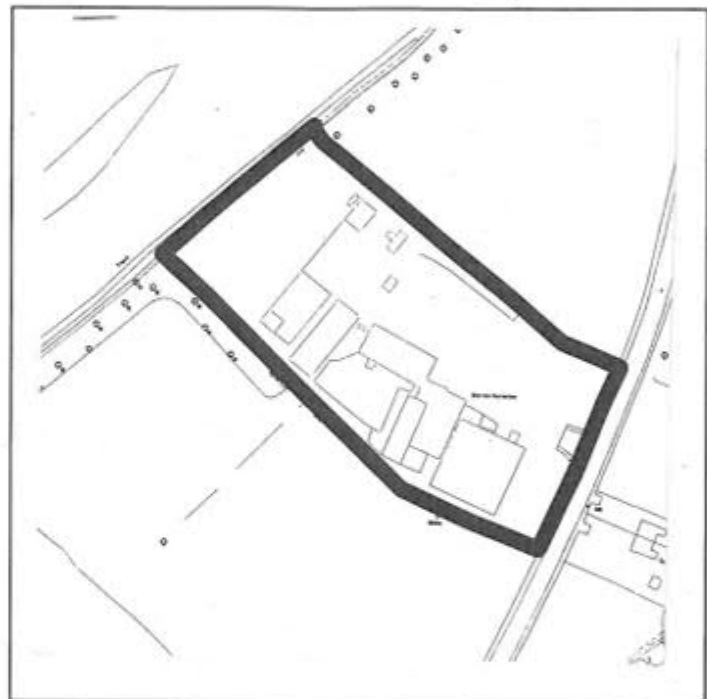

*Proposed residential development
up to 43 dwellings including 30%
affordable*

CROWN COPYRIGHT RIBBLE VALLEY BOROUGH COUNCIL LA079111

Development Stage

Started? *no*

Completions: *n/a*

Under Construction: *n/a*

Remaining area to be developed: *30dw / 1.34ha*

LAND OFF DALE VIEW, BILLINGTON

OS Grid Reference: 372596 435860 Site Size ha: 2.14 No Dwellings: 49

Planning Status: *Reserved Matters 3/97/0070; 3/97/0379; 3/99/0834; 3/00/0307; 3/00/0550; 3/03/0048*

Applicant or Agent:

*Bloor Homes
2-4 Whiteside Business Park
Station Road
Holmes Chapel
Cheshire CW4 8AA*



49 dwellings comprising detached dwellings of either 3 or 4 bedrooms plus 3 blocks of terraced units

CROWN COPYRIGHT RIBBLE VALLEY BOROUGH COUNCIL LA100018641

Development Stage

Started? *yes*

Completions: *26dw*

Under Construction: *0dw*

Remaining area to be developed: *23dw / 1.00ha*

LAND OFF DALE VIEW, BILLINGTON

OS Grid Reference: 372515 435974 Site Size ha: 1.68 No Dwellings: 39

Planning Status: Outline 3/2014/0779; 3/2012/0738; 3/2012/0065

Applicant or Agent:

Mr K Geldard

c/o Agent



Erection of 39 dwellings which includes 12 affordable units
 3/2014/0779 - 18 dwellings
 3/2012/0738 - 9 dwellings
 3/2012/0065 - 12 dwellings

CROWN COPYRIGHT RIBBLE VALLEY BOROUGH COUNCIL LA079111

Development Stage

Started? no

Completions: n/a

Under Construction: n/a

Remaining area to be developed: 27dw / 1.16ha

NAB RISE, PAINTER CRESCENT & PAINTER WOOD, BILLINGTON

OS Grid Reference: 372776 435698 **Site Size ha:** 2.35 **No Dwellings:** 57

Planning Status: Full 3/2013/0747; 3/2014/0753

Applicant or Agent:
McDermott Homes Ltd
Jupiter House
Mercury Rise
Altham Business Park
Altham BB5 5BY



*Erection of 41 market and 15
 affordable dwellings*
*Substitution of plots 12-15 to
 include 1 extra dwelling*

CROWN COPYRIGHT RIBBLE VALLEY BOROUGH COUNCIL LA079111

Development Stage

Started? *yes*

Completions: *5dw*

Under Construction: *22dw / 0.91ha*

Remaining area to be developed: *30dw / 1.24ha*

LAND OFF ELKER LANE, BILLINGTON

OS Grid Reference: 371884 435570 Site Size ha: 0.53 No Dwellings: 19

Planning Status: Full 3/2014/0801

Applicant or Agent:

*St Vincents HA & Oaks from
Acorns Private Day Nursery
c/o Agent*

*Construction of 19 apartments
for the over 55s & 120 place
childrens day nursery*

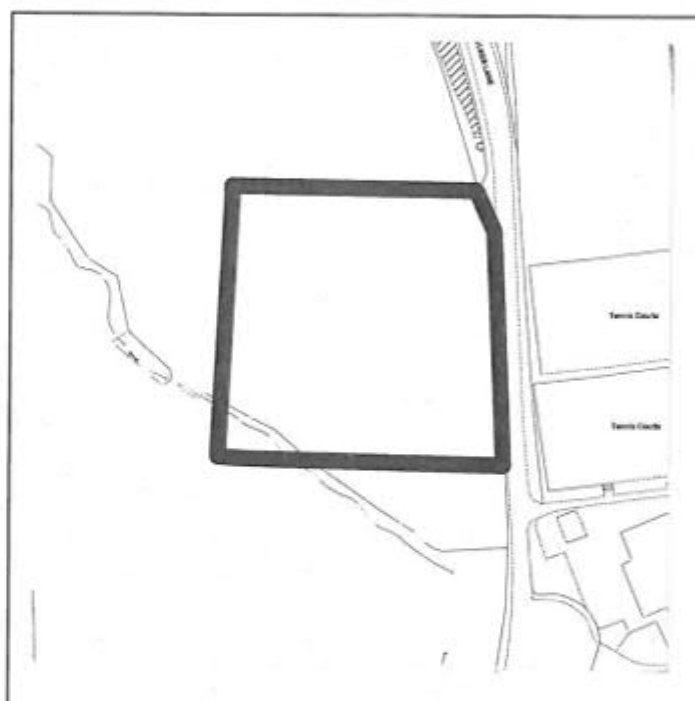

CROWN COPYRIGHT RIBBLE VALLEY BOROUGH COUNCIL LA079111

Development Stage

Started? *yes*

Completions: *n/a*

Under Construction: *1dw / 0.03*

Remaining area to be developed: *18dw / 0.50ha*

LAND OFF CHATBURN OLD ROAD, CHATBURN

OS Grid Reference: 373685 444024 Site Size ha: 0.68 No Dwellings: 10

Planning Status: Full 3/2014/0618; Outline 3/2011/0025

Applicant or Agent:
J-J Holmes (NW) LLP
C/o Agent

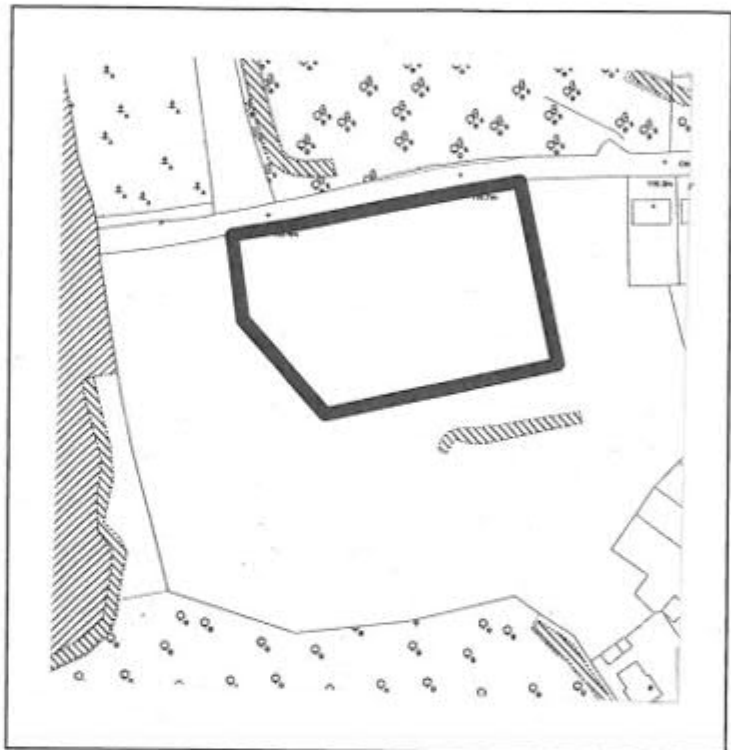

Erection of 10 detached dwellings

CROWN COPYRIGHT RIBBLE VALLEY BOROUGH COUNCIL LA100018641

Development Stage

Started? *no*

Completions: *n/a*

Under Construction: *n/a*

Remaining area to be developed: *10dw / 0.68ha*

LAND AT CHATBURN ROAD, CLITHEROE

OS Grid Reference: 375229 443021 Site Size ha: 1.82 No Dwellings: 23

Planning Status: Outline 3/2013/0981

Applicant or Agent:

Oakmere Homes Ltd
Helm Bank
Natland
Kendal
Cumbria LA9 7PS

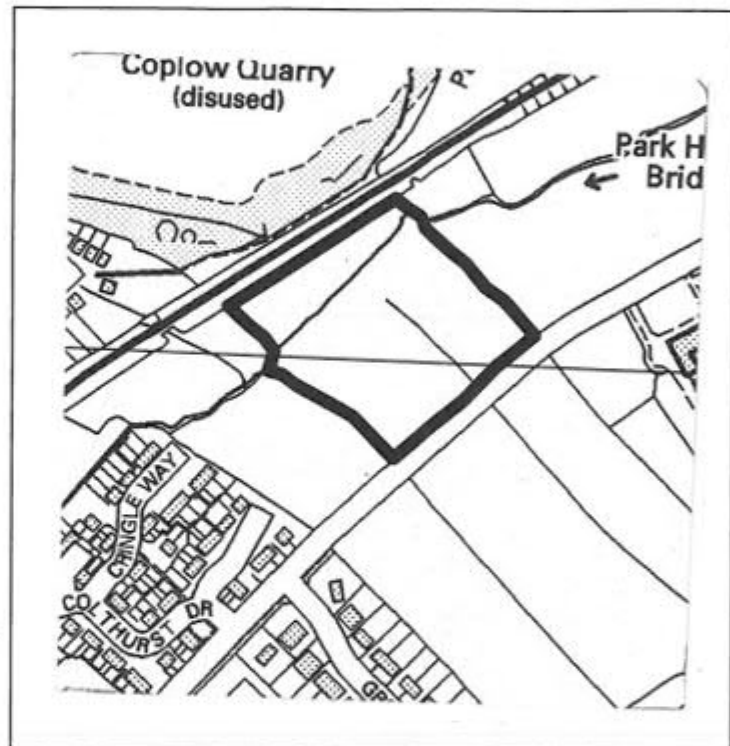

Erection of 20 dwellings
(including 6 units of social
housing), 3 close care apartments
and a 60 bed care home

CROWN COPYRIGHT RIBBLE VALLEY BOROUGH COUNCIL LA100018641

Development Stage

Started? no

Completions: n/a

Under Construction: n/a

Remaining area to be developed: 16dw / 1.27ha

LAND ADJ GREENFIELD AVENUE, CLITHEROE

OS Grid Reference: 373277 441778 Site Size ha: 1.37 No Dwellings: 30

Planning Status: *Outline 3/2012/0014*

Applicant or Agent:

Mrs M Rushton

C/o Agent

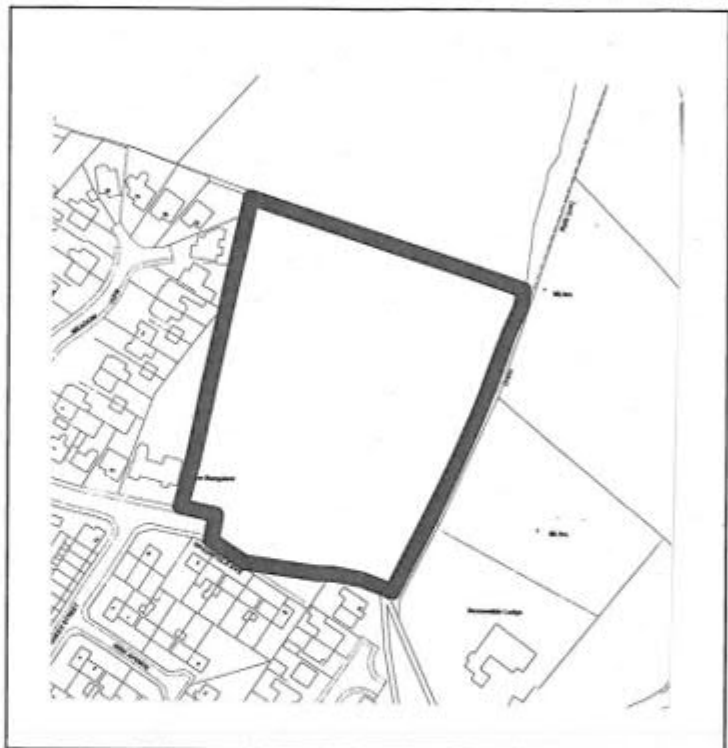

*Erection of 30 dwellings which
comprises 16 houses, 8
affordable houses & 6 bungalows*

CROWN COPYRIGHT RIBBLE VALLEY BOROUGH COUNCIL LA100018641

Development Stage

Started? *no*

Completions: *n/a*

Under Construction: *n/a*

Remaining area to be developed: *22dw / 1.00ha*

LAND ADJ ST PAUL'S CHURCH, EDISFORD ROAD, CLITHEROE

OS Grid Reference: 373128 441547 Site Size ha: 0.55 No Dwellings: 8

Planning Status: *Outline 3/2013/0014*

Applicant or Agent:

*Blackburn Diocese Board of Finance
Church House
Cathedral Close
Blackburn BB1 5AA*



*Outline permission for the erection
of 8 dwellings on land adjacent to
St Paul's Church*

CROWN COPYRIGHT RIBBLE VALLEY BOROUGH COUNCIL LA079111

Development Stage

Started? *no*

Completions: *n/a*

Under Construction: *n/a*

Remaining area to be developed: *8dw / 0.55ha*

LAND OFF HENTHORN ROAD, CLITHEROE

OS Grid Reference: 372946 441036 Site Size ha: 8.27 No Dwellings: 270

Planning Status: *Reserved Matters 3/2013/0035; Outline 3/2010/0719;
Full 3/2014/0381*

Applicant or Agent:

*Taylor Wimpey Manchester &
Barratt Homes Manchester
C/o Agent*

*Development for up to 270
dwellings and doctor's surgery
which includes 81 affordable
dwellings*



CROWN COPYRIGHT RIBBLE VALLEY BOROUGH COUNCIL LA079111

Development Stage

Started? *yes*

Completions: *147dw*

Under Construction: *78dw / 2.39ha*

Remaining area to be developed: *45dw / 1.38ha*

LAND OFF HENTHORN ROAD, CLITHEROE

OS Grid Reference: 373184 440758 Site Size ha: 4.97 No Dwellings: 130

Planning Status: *Reserved Matters 3/2015/0446; Outline 3/2013/0711*

Applicant or Agent:

*Story Homes Ltd & Strategic
Land Group Ltd
C/o Story House
Lords Way
Kingmoor Business Park
Carlisle CA6 4SL*



*Reserved Matters for erection of
130 dwellings which includes 39
affordable units*

CROWN COPYRIGHT RIBBLE VALLEY BOROUGH COUNCIL LA079111

Development Stage

Started? *no*

Completions: *n/a*

Under Construction: *n/a*

Remaining area to be developed: *91dw / 3.48ha*

LAND AT HIGHER STANDEN FARM & PART LITTLEMOOR FARM, CLITHEROE

OS Grid Reference: 375069 440720 **Site Size ha:** 45.25 **No Dwellings:** 1040

Planning Status: *Outline 3/2012/0942*

Applicant or Agent:
*The Trustees of the Standen
 Estate
 c/o Ingham & Yorke
 Littlemoor
 Clitheroe BB7 1HG*



*Erection of 728 market & 312
 affordable dwellings.
 Also local retail, service &
 community facilities, employment.
 Land for a primary school & public
 open space*

CROWN COPYRIGHT RIBBLE VALLEY BOROUGH COUNCIL LA100018641

Development Stage

Started? *no*

Completions: *n/a*

Under Construction: *0dw*

Remaining area to be developed: *728dw / 31.68ha*

LAND NORTH & WEST OF LITTLEMOOR, CLITHEROE

OS Grid Reference: 374205 440887 Site Size ha: 1.75 No Dwellings: 49

Planning Status: *Outline 3/2012/0420*

Applicant or Agent:

*R Cornish and A Ferguson
(as trustees) The Standen Estate
c/o Ingham & Yorke LLP
Littlemoor
Clitheroe
Lancs
BB7 1HG*

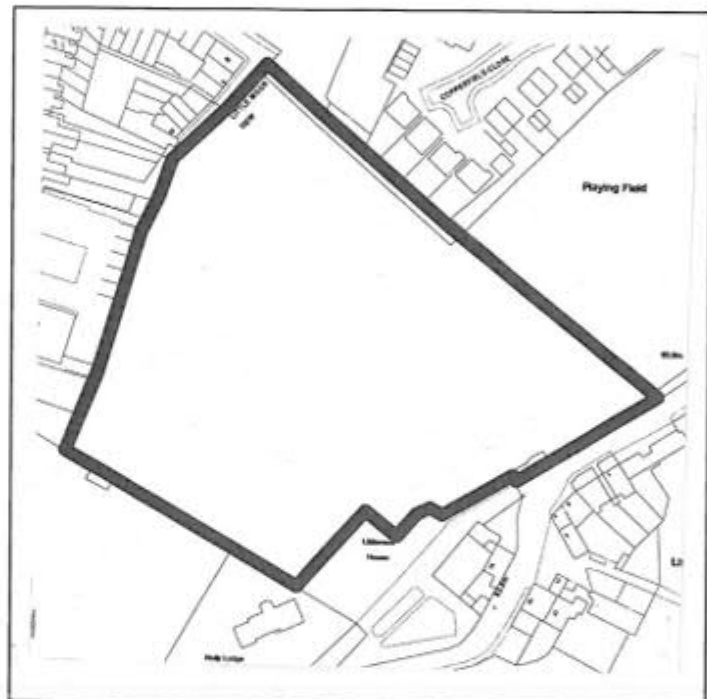

*Outline for the erection of
49 dwellings of which 15 are
affordable*

CROWN COPYRIGHT RIBBLE VALLEY BOROUGH COUNCIL LA100018641

Development Stage

Started? *no*

Completions: *n/a*

Under Construction: *n/a*

Remaining area to be developed: *34dw / 1.21ha*

LAND OFF MILTON AVENUE, CLITHEROE

OS Grid Reference: 374089 442171 **Site Size ha:** 1.23 **No Dwellings:** 50

Planning Status: *Outline 3/2011/0892*

Applicant or Agent:

*The Huntroyde Estate
Huntroyde Estate Office
Padiham
Lancs BB12 7QX*

*Development for 50 dwellings which
includes 15 affordable units*

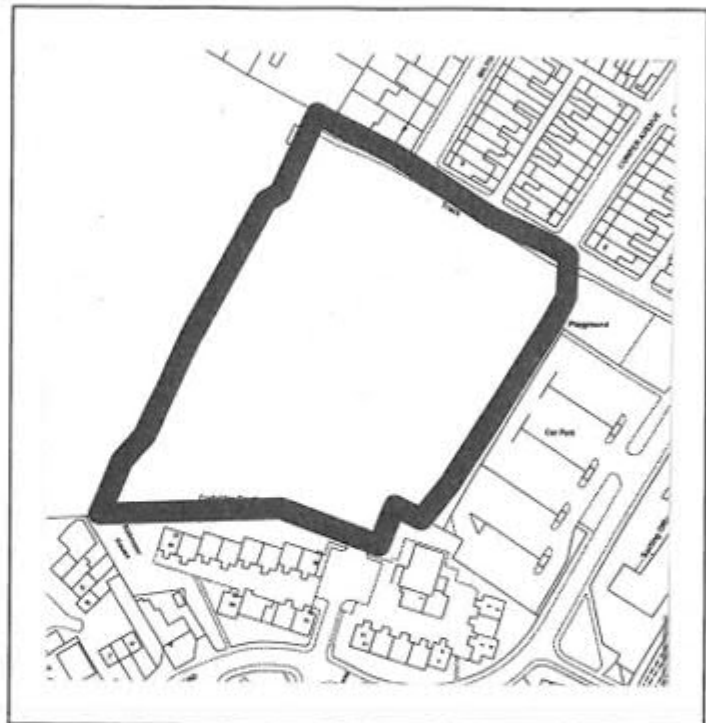

CROWN COPYRIGHT RIBBLE VALLEY BOROUGH COUNCIL LA079111

Development Stage

Started? *no*

Completions: *n/a*

Under Construction: *n/a*

Remaining area to be developed: *35dw / 0.86ha*

15 PARKER AVENUE, CLITHEROE

OS Grid Reference: 373965 440931 Site Size ha: 0.73 No Dwellings: 14

Planning Status: Full 3/2014/0666

Applicant or Agent:

*Bowsall Ltd/Mr G Jenkins/
Mrs S Sharples
C/o 3 King Street
Salford
M3 7DG*

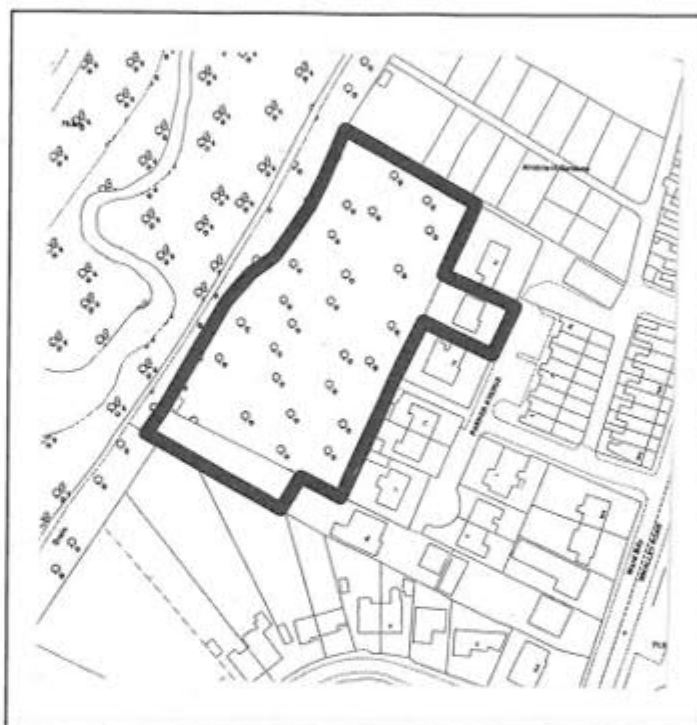

*Demolition of bungalow & erection
of 10 market & 5 affordable
dwellings*

CROWN COPYRIGHT RIBBLE VALLEY BOROUGH COUNCIL LA079111

Development Stage

Started? *no*

Completions: *n/a*

Under Construction: *n/a*

Remaining area to be developed: *9dw / 0.47ha*

LAND OFF PIMLICO LINK ROAD, CLITHEROE

OS Grid Reference: 374958 443258 Site Size ha: 0.76 No Dwellings: 19

Planning Status: Outline 3/2014/0742

Applicant or Agent:

Mr & Mrs Stone

C/o Agent



Erection of up to 19 dwelling, which includes
6 affordable dwellings

CROWN COPYRIGHT RIBBLE VALLEY BOROUGH COUNCIL LA079111

Development Stage

Started? no

Completions: n/a

Under Construction: n/a

Remaining area to be developed: 13dw / 0.52ha

PRIMROSE MILL SITE, WOONE LANE, CLITHEROE

OS Grid Reference: 373706 440860 **Site Size ha:** 2.68 **No Dwellings:** 126

Planning Status: *Reserved Matters 3/2012/0394; Outline 3/2008/0526 + Full
Consents 3/2010/0055; 3/2010/0838; 3/2010/0897; 3/2012/0379
Reserved Matters 3/2012/0392; 3/2010/0756; Outline 3/2008/0526*

Applicant or Agent:
*Miller Homes & Beck Development
C/o Agent JWPC Ltd*

Around Primrose Mill
*3/2012/0394 - Reserved Matters for
78 dwellings with a mix of terraces,
semi detached, detached & apartments*
Rectella Site
*3/2012/0392 - Reserved Matters for
34 detached, semi detached,
terraced dwellings & apartments*
Primrose Mill
*3/2010/0897 - Full for 12 apartments
& 2 dwellings*

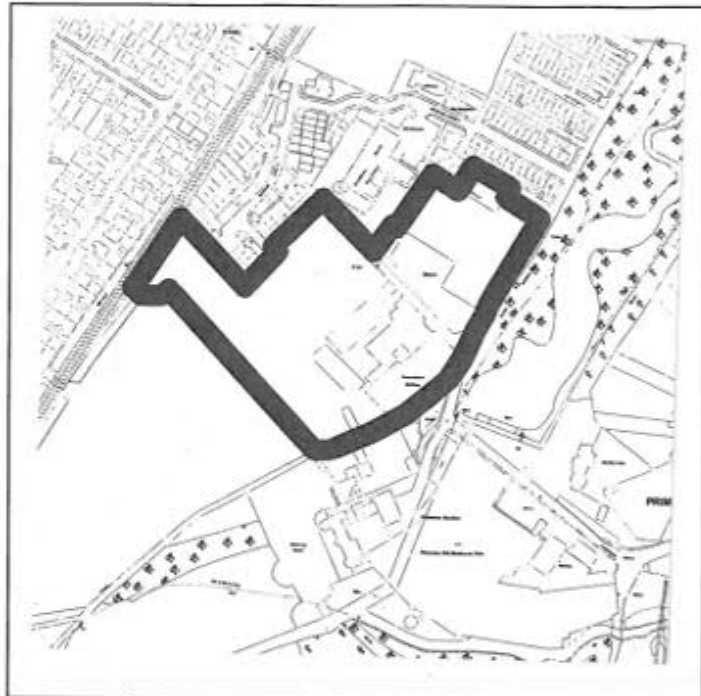

CROWN COPYRIGHT RIBBLE VALLEY BOROUGH COUNCIL LA100018641

Development Stage

Started? *yes*

Completions: *66dw*

Under Construction: *31dw / 0.66ha*

Remaining area to be developed: *29dw / 0.62ha*

LAND SOUTH WEST OF PRIMROSE VILLAGE, CLITHEROE

OS Grid Reference: 373531 440737 Site Size ha: 2.48 No Dwellings: 81

Planning Status: *Outline 3/2011/1064*

Applicant or Agent:
*Beck Developments Ltd
Challenge House
Challenge Way
Blackburn BB1 5QB*



Erection of 81 market dwellings

CROWN COPYRIGHT RIBBLE VALLEY BOROUGH COUNCIL LA100018641

Development Stage

Started? *no*

Completions: *n/a*

Under Construction: *Odw*

Remaining area to be developed: *81dw / 2.48ha*

LAND OFF WADDINGTON ROAD, CLITHEROE

OS Grid Reference: 373869 442205 Site Size ha: 9.20 No Dwellings: 275

Planning Status: *Outline 3/2014/0597*

Applicant or Agent:

*The Huntroyde Estate, Clitheroe
Auction Mart Co Ltd, John Taylor,
Sarah Howard & Samantha Howard
C/o Agent
Dickman Associates Ltd*



Outline development for up to 275 dwellings with 30% affordable

CROWN COPYRIGHT RIBBLE VALLEY BOROUGH COUNCIL LA079111

Development Stage

Started? *no*

Completions: *n/a*

Under Construction: *n/a*

Remaining area to be developed: *192dw / 6.42ha*

LAND OFF MILL LANE, GISBURN

OS Grid Reference: 382453 448943 Site Size ha: 0.54 No Dwellings: 3

Planning Status: Full 3/2015/0167

Applicant or Agent:
 Gisburne Park Estate
 C/o Agent



Erection of 3 detached dwellings

CROWN COPYRIGHT RIBBLE VALLEY BOROUGH COUNCIL LA100018641

Development Stage

Started? *no*

Completions: *n/a*

Under Construction: *n/a*

Remaining area to be developed: *3dw / 0.54ha*

STRAWBERRY FIELDS, MAIN STREET, GISBURN

OS Grid Reference: 383294 448988 Site Size ha: 1.42 No Dwellings: 34

Planning Status: *Reserved Matters 3/2015/0370; Outline 3/2012/0497; 3/2013/0161; 3/2013/0189*

Applicant or Agent:

*Prospect GB Ltd
Unit 5
Meridian Business Park
Hansby Drive
Hunts Cross
Speke L24 9LG*

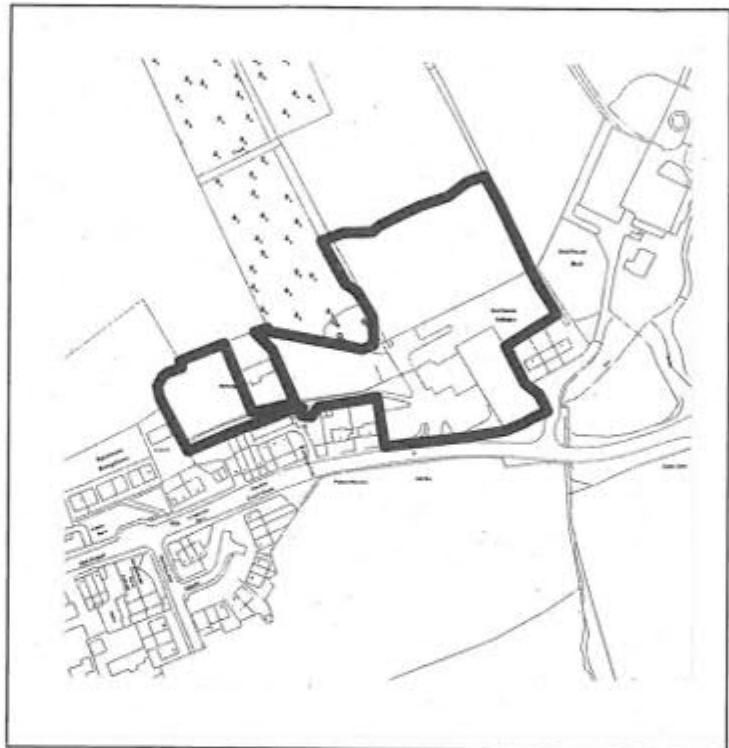

Reserved Matters for 34 dwellings of which 11 are affordable

CROWN COPYRIGHT RIBBLE VALLEY BOROUGH COUNCIL LA100018641

Development Stage

Started? *no*

Completions: *n/a*

Under Construction: *n/a*

Remaining area to be developed: *23dw / 0.96ha*

LAND TO THE NORTH OF WHALLEY ROAD, HURST GREEN

OS Grid Reference: 368708 438077 Site Size ha: 2.44 No Dwellings: 30

Planning Status: Full 3/2012/0964

Ownership:

Stonyhurst College

Stonyhurst

Clitheroe BB7 9PZ



*Erection of 21 market & 9
affordable dwellings*

CROWN COPYRIGHT RIBBLE VALLEY BOROUGH COUNCIL LA100018641

Development Stage

Started? *no*

Completions: *n/a*

Under Construction: *n/a*

Remaining area to be developed: *21dw / 1.71ha*

LAND OFF LONGSIGHT ROAD, LANGHO

OS Grid Reference: 370561 434585 Site Size ha: 5.40 No Dwellings: 18

Planning Status: Outline 3/2015/0010

Ownership:

Hallam Land Management

C/o Agent



Erection of 18 dwellings, including 5 affordable dwellings

CROWN COPYRIGHT RIBBLE VALLEY BOROUGH COUNCIL LA100018641

Development Stage

Started? no

Completions: n/a

Under Construction: n/a

Remaining area to be developed: 13dw / 3.90ha

LAND AT CHAPEL HILL, LONGRIDGE

OS Grid Reference: 360401 436623 Site Size ha: 3.40 No Dwellings: 53

Planning Status: Full 3/2011/1071

Applicant or Agent:

United Utilities Property Services
1st Floor Grasmere House
Lingley Mere Business Park
Lingley Green Avenue
Great Sankey
Warrington WA5 3LP



Erection of 52 dwellings of which 16 are affordable units and conversion of former barn to one dwelling and refurbishment of existing residential unit (53 Chapel Hill)

CROWN COPYRIGHT RIBBLE VALLEY BOROUGH COUNCIL LA100018641

Development Stage

Started? no

Completions: n/a

Under Construction: n/a

Remaining area to be developed: 37dw / 2.37ha

LAND TO NORTH OF DILWORTH LANE, LONGRIDGE

OS Grid Reference: 361324 437385 Site Size ha: 10.02 No Dwellings: 195

Planning Status: *Outline 3/2015/0065*

Applicant or Agent:

*Taylor Wimpey UK Ltd
1 Lumsdale Road
Stretford
Manchester
Greater Manchester
M32 0UT*

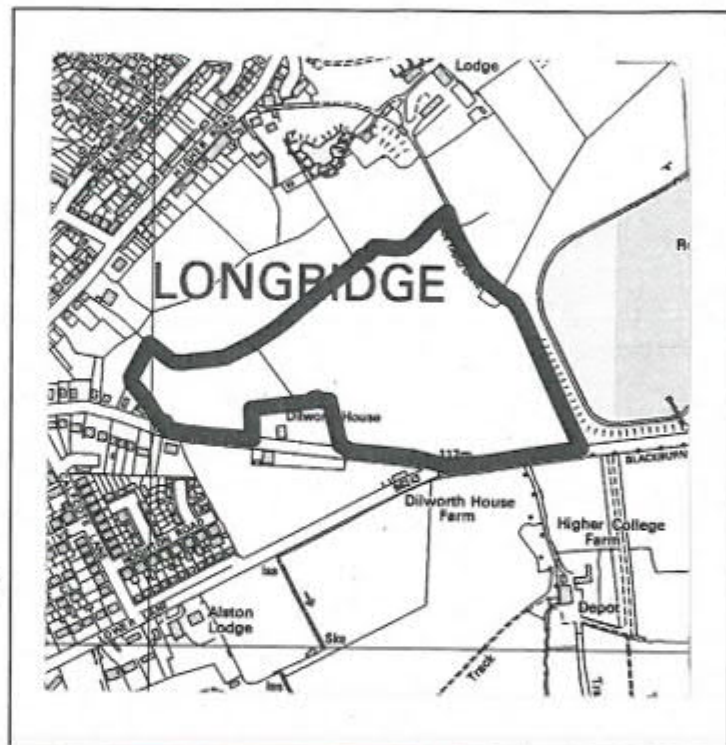

*Erection of up to 195 dwellings of
which 59 are affordable*

CROWN COPYRIGHT RIBBLE VALLEY BOROUGH COUNCIL LA100018641

Development Stage

Started? *no*

Completions: *n/a*

Under Construction: *n/a*

Remaining area to be developed: *136dw / 6.99ha*

SPOUT FARM, PRESTON ROAD, LONGRIDGE

OS Grid Reference: 360285 436036 Size ha: 1.78 No Dwellings: 32

Planning Status: *Outline 3/2013/0782*

Applicant or Agent:

Mr D Lambert

Spout Farm

Preston Road

Longridge PR3 3BE

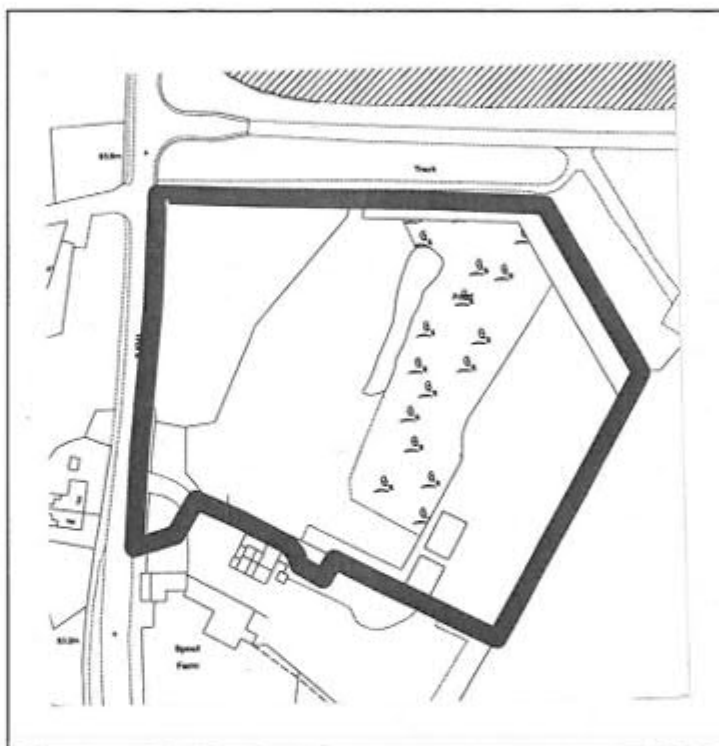

Erection of 32 dwellings of which 22 are market & 10 affordable

CROWN COPYRIGHT RIBBLE VALLEY BOROUGH COUNCIL LA100018641

Development Stage

Started? *no*

Completions: *n/a*

Under Construction: *n/a*

Remaining area to be developed: *22dw / 1.22ha*

WATER MEADOWS, LONGRIDGE

OS Grid Reference: 360093 436126 Site Size ha: 2.35 No Dwellings: 61

Planning Status: Full 3/2014/0822; Reserved Matters 3/2013/0307; Outline 3/2011/0316

Applicant or Agent:
 Miller Homes (North West) Ltd
 Hawthorne House
 Woodlands Road
 Ashton Road
 Newton-le-Willows
 Merseyside WA12 0HF

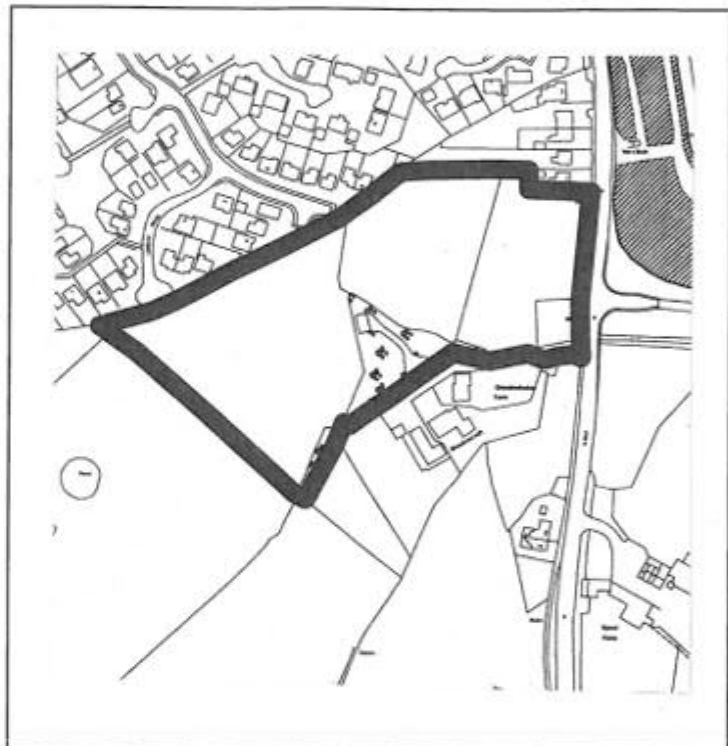

Reserved Matters for 58 dwellings of which 18 are affordable
 Replan of plots 32-45 to add 3 additional dwellings

CROWN COPYRIGHT RIBBLE VALLEY BOROUGH COUNCIL LA100018641

Development Stage

Started? *yes*

Completions: *47dw*

Under Construction: *14dw / 0.54ha*

Remaining area to be developed: *0dw*

CHERRY DRIVE, BROCKHALL VILLAGE, OLD LANGHO

OS Grid Reference: 369936 436638 Site Size ha: 0.56 No Dwellings: 7

Planning Status: 3/2007/1071; 3/2008/0567; 3/2010/0419; 3/2010/0706;
 3/2011/0096; 3/2011/0330; 3/2011/0336; 3/2011/0749;
 3/2013/0074

Applicant or Agent:
Individual Owners

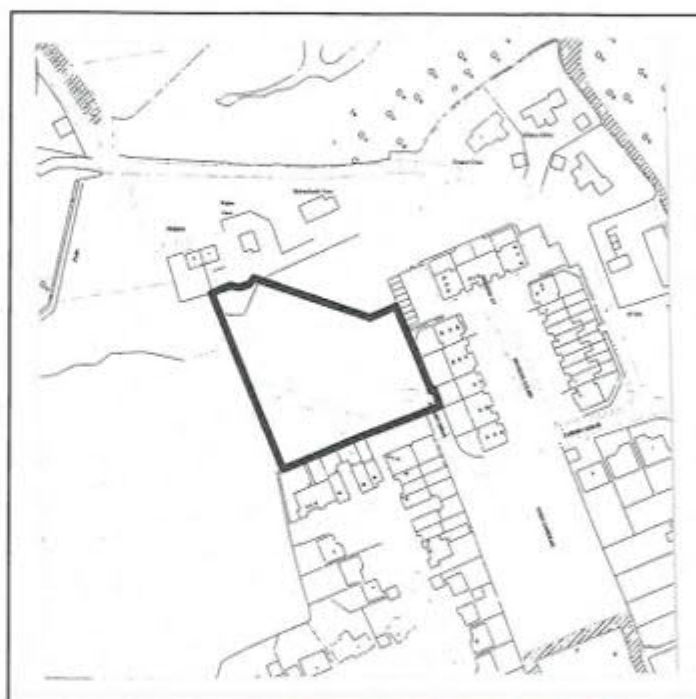

Plot 1 - No 2 - detached dwelling
Plot 2 - No 4 - detached dwelling
Plot 3 - No 6 - detached dwelling
Plot 5 - No 10 - detached dwelling
Plot 6 - No 9 - detached dwelling
Plot 7 - No 7 - detached dwelling

CROWN COPYRIGHT RIBBLE VALLEY BOROUGH COUNCIL LA100018641

Development Stage

Started? *yes*

Completions: *4dw*

Under Construction: *1dw / 0.08ha*

Remaining area to be developed: *2dw / 0.16ha*

EDEN GARDENS, BROCKHALL VILLAGE, OLD LANGHO

OS Grid Reference: 3700014 436548 Site Size ha: 0.47 No Dwellings: 6

Planning Status: Full 3/2006/0830; 3/2010/0103

Applicant or Agent:

*Langtree Homes
6 Hallgate
Wigan WN1 1HP*

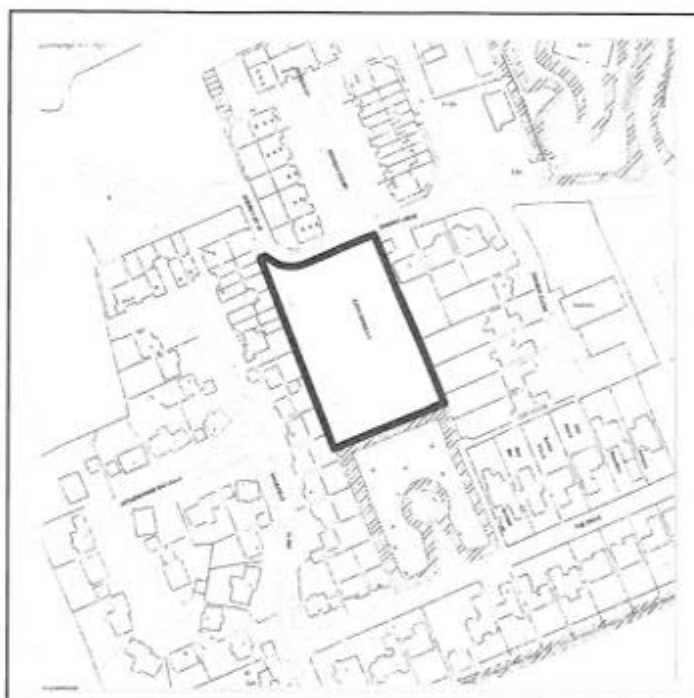

Erection of 6 detached dwellings

CROWN COPYRIGHT RIBBLE VALLEY BOROUGH COUNCIL LA100018641

Development Stage

Started? *yes*

Completions: *2dw*

Under Construction: *4dw / 0.31ha*

Remaining area to be developed: *0dw*

LAND AT HILLSIDE, BROCKHALL VILLAGE, OLD LANGHO

OS Grid Reference: 369945 436694 Site Size ha: 0.41 No Dwellings: 3

Planning Status: *Full 3/2010/0387*

Applicant or Agent:

*Mr M Gaffey
Cedar House
Bosburn Drive
Mellor Brook BB2 7PA*

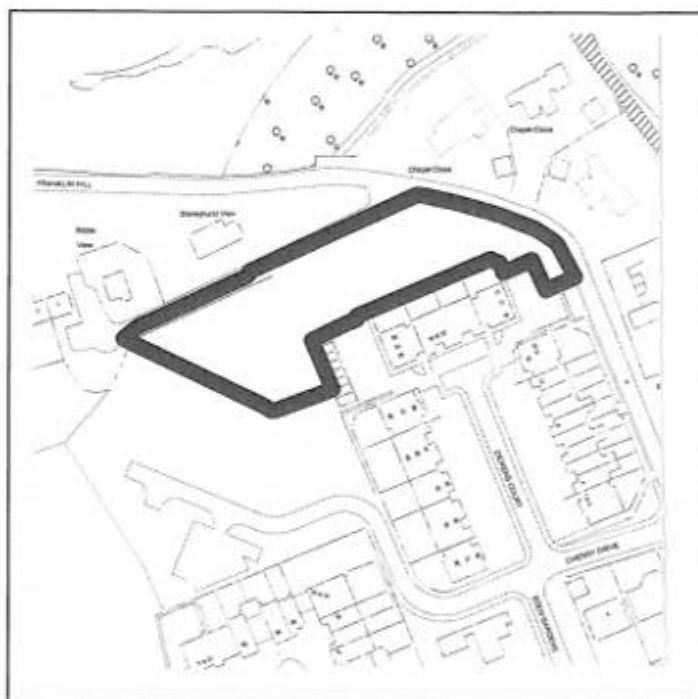

*Erection of 2 six bed and 1 four
bedroomed detached houses*

CROWN COPYRIGHT RIBBLE VALLEY BOROUGH COUNCIL LA100018641

Development Stage

Started? *yes*

Completions: *2dw*

Under Construction: *0dw*

Remaining area to be developed: *1dw / 0.14ha*

MEADOW VIEW & WHINS HOUSE, WHINS LANE, READ

OS Grid Reference: 377126 434994 Site Size ha: 1.07 No Dwellings: 15

Planning Status: Full 3/2013/0851; 3/2012/1101

Applicant or Agent:
Westby Homes & Bowsall Ltd
c/o Agent

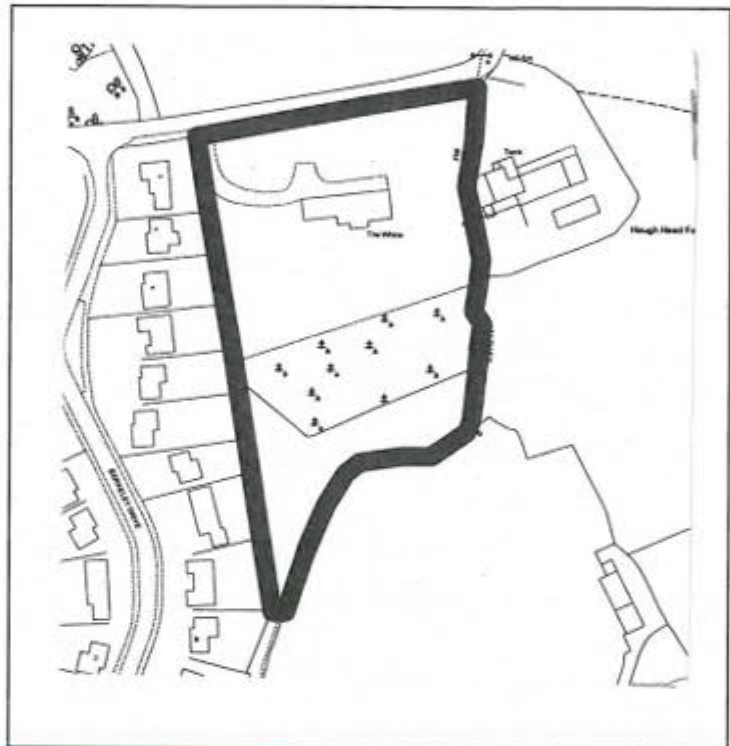

*Full consent for the demolition
of the existing dwelling and
erection of 16 dwellings which
includes 5 affordable units*

CROWN COPYRIGHT RIBBLE VALLEY BOROUGH COUNCIL LA100018641

Development Stage

Started? *yes*

Completions: *6dw*

Under Construction: *9dw / 0.64ha*

Remaining area to be developed: *0dw*

1-15 ANCHOR HILL CLOSE, RIBCHESTER

OS Grid Reference: 364808 435132 Site Size ha: 0.75 No Dwellings: 15

Planning Status: Full 3/2014/0624

Applicant or Agent:
Partner Construction
C/o Agent

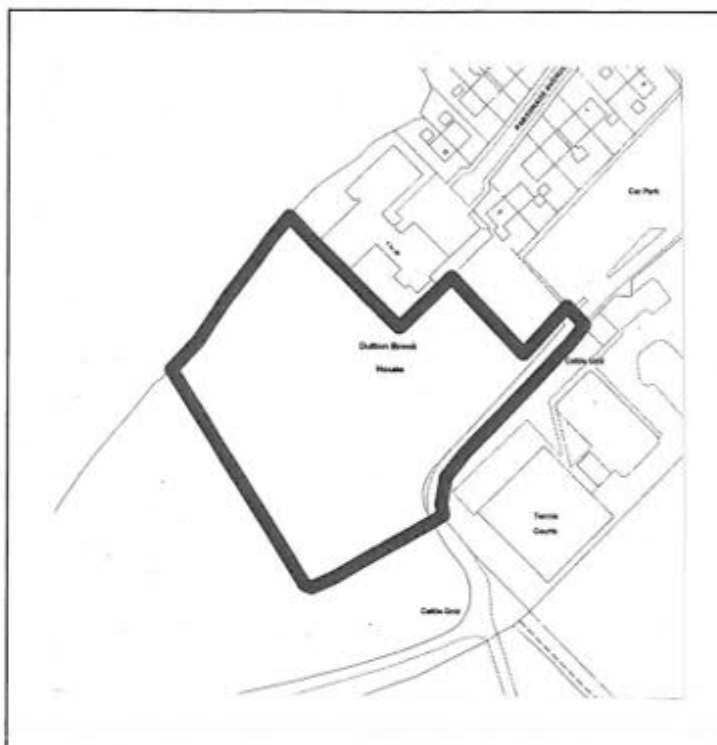

Erection of 15 affordable dwellings

CROWN COPYRIGHT RIBBLE VALLEY BOROUGH COUNCIL LA100018641

Development Stage

Started? *yes*

Completions: *n/a*

Under Construction: *1dw / 0.05ha*

Remaining area to be developed: *14dw / 0.70ha*

LAND R/O PENDLE STREET EAST, SABDEN

OS Grid Reference: 377861 437165 **Site Size ha:** 0.63 **No Dwellings:** 17

Planning Status: *Outline 3/2013/0440*

Applicant or Agent:

*P & D Developments Ltd
Fern Court Business Centre
Castlegate
Clitheroe*

*Outline for residential
development of 14 houses & 3
bungalows*

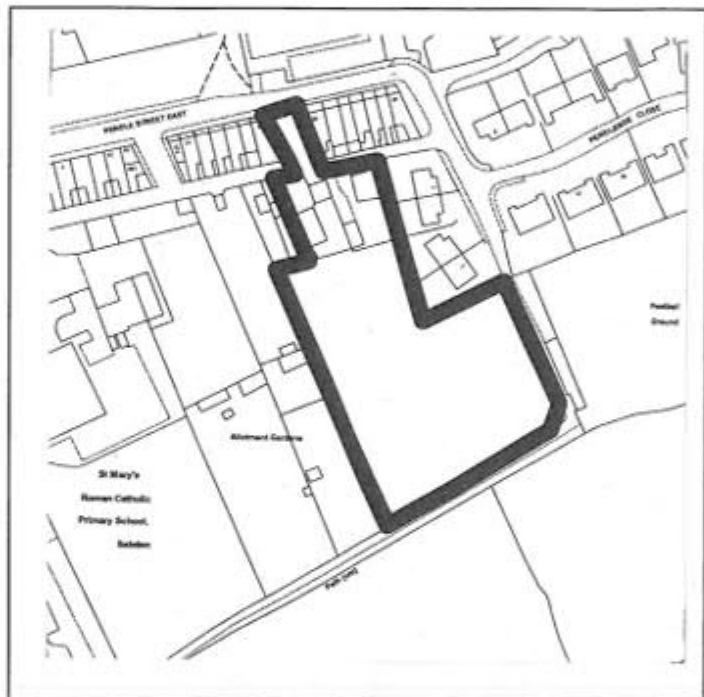

CROWN COPYRIGHT RIBBLE VALLEY BOROUGH COUNCIL LA079111

Development Stage

Started? *no*

Completions: *n/a*

Under Construction: *n/a*

Remaining area to be developed: *17dw / 0.63ha*

LAND AT ACCRINGTON ROAD, WHALLEY

OS Grid Reference: 373587 436021 Site Size ha: 2.97 No Dwellings: 77

Planning Status: *Outline 3/2012/0179*

Applicant or Agent:

Briery Homes Ltd

Helm Bank

Natland

Kendal

Cumbria LA9 7PS

*Outline for 37 bungalows and
40 retirement apartments.
This includes 23 affordable units
which consist of 12 bungalows &
11 apartments*



CROWN COPYRIGHT RIBBLE VALLEY BOROUGH COUNCIL LA100018641

Development Stage

Started? *no*

Completions: *n/a*

Under Construction: *n/a*

Remaining area to be developed: *54dw / 2.08ha*

LAND EAST OF CLITHEROE ROAD (LAWSONSTEADS), WHALLEY

OS Grid Reference: 373713 436508 Site Size ha: 5.80 No Dwellings: 206

Planning Status: *Outline 3/2013/0137*

Applicant or Agent:

*Commercial Estates Group
c/o Indigo Planning Limited*

*Residential mixed use development
comprising 260 dwellings & primary
school. Includes 78 affordable
dwellings*

Note

See Reserved Matters

*3/2014/0043, consent on same
site - 54 dwellings.*

Therefore 260 - 54 = 206 dwellings

Affordable 78 - 16 = 62 dwellings

Site Area 8.30ha - 2.50ha = 5.80ha



CROWN COPYRIGHT RIBBLE VALLEY BOROUGH COUNCIL LA100018641

Development Stage

Started? *no*

Completions: *n/a*

Under Construction: *n/a*

Remaining area to be developed: *144dw / 4.05ha*

***CLITHEROE ROAD, SPRINGWOOD DRIVE, DEER PARK
CRESCENT & FOUNTAIN WAY, WHALLEY***

OS Grid Reference: 373615 436622 Site Size ha: 2.50 No Dwellings: 54

Planning Status: *Reserved Matter 3/2014/0043; Outline 3/2012/0687*

Applicant or Agent:
Redrow (Lancashire)
C/o Agent



*Reserved Matters for Phase 1
for the erection of 38 market
dwellings & 16 affordable dwellings*

CROWN COPYRIGHT RIBBLE VALLEY BOROUGH COUNCIL LA100018641

Development Stage

Started? *yes*

Completions: *8dw*

Under Construction: *19dw / 0.88ha*

Remaining area to be developed: *27dw / 1.25ha*

100, 102, 104, 106, 108, 110, 112 CLITHEROE ROAD, WHALLEY

OS Grid Reference: 373579 437708 Site Size ha: 0.46ha No Dwellings: 7

Planning Status: Full 3/2014/0725; Outline 3/2012/0617

Applicant or Agent:
Reilly Developments Ltd
C/o Agent



CROWN COPYRIGHT RIBBLE VALLEY BOROUGH COUNCIL LA079111

Erection of 7 dwellings

Development Stage

Started? *yes*

Completions: *0dw*

Under Construction: *7dw / 0.46ha*

Remaining area to be developed: *0dw*

LAND AT MITTON ROAD, WHALLEY

OS Grid Reference: 372734 436416 Site Size ha: 6.20 No Dwellings: 137

Planning Status: Full 3/2012/0637

Applicant or Agent:

David Wilson Homes North West
& AC Surveyors & Valuers
c/o David Wilson Homes North West
2nd Floor 303 Bridgwater Place
Birchwood Park
Warrington
WA3 6XF



Full consent for 116 - 2,3,4 & 5
bedroom dwellings & 21 - 1 bedroom
bungalows which includes 41
affordable units

CROWN COPYRIGHT RIBBLE VALLEY BOROUGH COUNCIL LA100018641

Development Stage

Started? no

Completions: n/a

Under Construction: n/a

Remaining area to be developed: 96dw / 4.34ha

LAND NORTH OF RIDDINGS LANE, WHALLEY

OS Grid Reference: 373187 436694 Site Size ha: 2.12 No Dwellings: 71

Planning Status: *Reserved Matters 3/2014/0815; Outline 3/2010/0820*

Applicant or Agent:

*Bellway Homes (Manchester
Division)
Co-Operative Estates
C/O Bellway Homes
The Genesis Centre
Birchwood
Warrington WA3 7BH*



*Reserved Matters for the erection
of 71 dwellings, which includes
21 affordable units*

CROWN COPYRIGHT RIBBLE VALLEY BOROUGH COUNCIL LA100018641

Development Stage

Started? *yes*

Completions: *n/a*

Under Construction: *1dw / 0.03ha*

Remaining area to be developed: *70dw / 2.09ha*

WHEATSHEAF CLOSE, WHALLEY

OS Grid Reference: 373604 437552 Site Size ha: 0.71ha No Dwellings: 28

Planning Status: Full 3/2013/0169

Applicant or Agent:
Great Places Housing Group
729 Princess Road
Manchester
M20 2LT

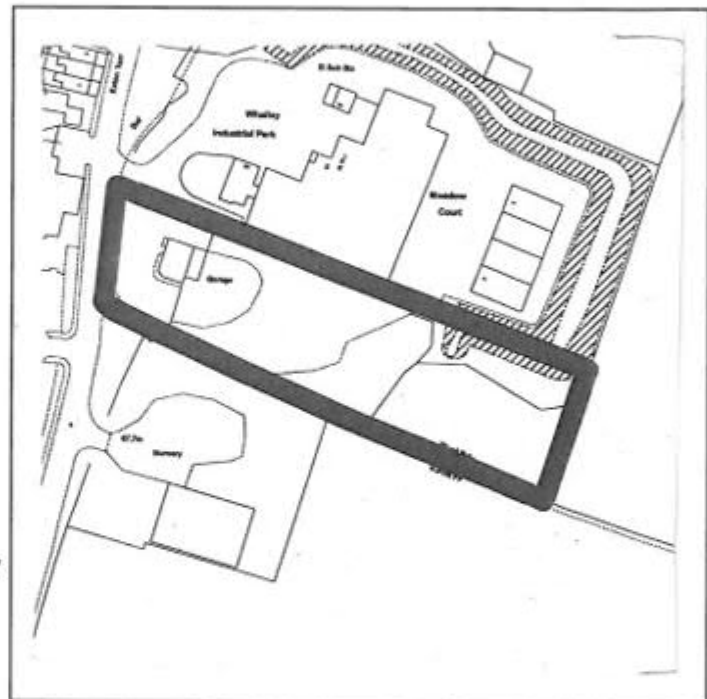

Erection of 28 affordable dwellings

CROWN COPYRIGHT RIBBLE VALLEY BOROUGH COUNCIL LA079111

Development Stage

Started? *yes*

Completions: *0dw*

Under Construction: *28dw / 0.71ha*

Remaining area to be developed: *0dw*

**LAND AT BENNETTS CLOSE, WISWELL LANE,
WHALLEY**

OS Grid Reference: 373946 436932 Site Size ha: 1.44 No Dwellings: 4

Planning Status: Full 3/2014/0993; 3/2013/0770

Applicant or Agent:

Mr D Knowles
Westbridge Developments Ltd
23 Wood Street
Bolton
BL1 1EB

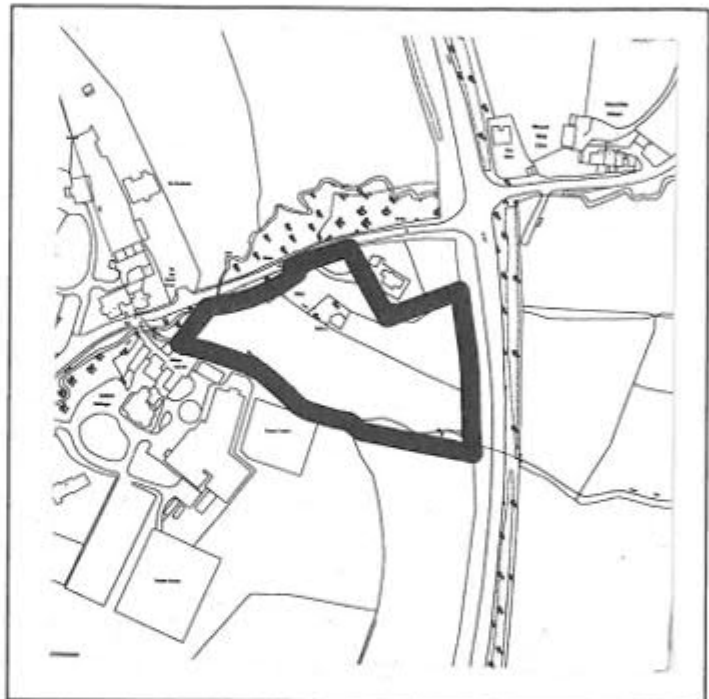

Erection of dwellings in grounds

CROWN COPYRIGHT RIBBLE VALLEY BOROUGH COUNCIL LA100018641

Development Stage

Started? *yes*

Completions: *n/a*

Under Construction: *4dw / 1.44ha*

Remaining area to be developed: *0dw*

**DE TABLEY MEWS, BLACKBURN ROAD,
RIBCHESTER**

OS Grid Reference: 366272 435541

Site Size ha: 0.44

No Dwellings: 6

Planning Status: Full 3/2010/0202; 3/2010/0216

Works: *Conversion/Change of use of former De
Tabley Arms, with manager's accommodation to 6
dwellings & erection of garages or to 3 dwellings*

Completions: 3dw

Development Commenced? yes / 3dw



CROWN COPYRIGHT RIBBLE VALLEY BOROUGH COUNCIL LA079111

**SITES WITH FULL
PLANNING PERMISSION**

SITES WITH FULL PLANNING PERMISSION

APPLICATION NO	LOCATION	SITE AREA (HECTARES)	NO OF DWELLINGS	COMMENTS	DATE OF APPROVAL	MAP NO	NGR	BROWNFIELD SITE
3/2013/0306	Pack Horse Garage Mellor Brow Mellor Brook	0.26	9	Renewal of 3/2010/0180 for demolition of commercial premises and erection of apartments	24/7/13	1	364159 431103	*
3/2012/0937	Land adj The Coach House Whalley Road Wilpshire	0.13	1	Erection of detached dwelling on former tennis court Renewal of 3/2009/0664P	18/1/13	2	368891 432062	*
3/2015/0223	Land adj Stonyhurst View Franklin Hill Brockhall Village	0.04	1	Alterations to 3/2012/1107 for erection of a dwelling	25/6/15	3	369939 436717	
3/2009/0542	Land adj 47 Knowsley Road West	0.01	1	Detached chalet bungalow	16/4/10	4	368178	*
3/2012/0724	Clayton-le-Dale			Revised layout	16/10/12		432577	
3/2014/0240	Black Bull Hotel Church Street Ribchester	0.11	5	Erection of 5 dwellings & 2 affordable dwellings	9/6/14	5	364998 435346	*
3/2014/1089	Land off Clough Bank Lane Chatburn	0.21	2	Proposed erection of 2 new dwellings & detached garage	14/7/15	6	376896 444033	*
3/2012/0595	Roe field Reach Edisford Road Clitheroe	0.16	1	Detached dwelling	1/11/12	7	372782 441497	
3/2012/1085	28 Kirkmoor Road Clitheroe	0.03	3	Demolition of existing garages & construction of dwellings	28/1/13	8	374018 442021	*
3/2012/1095	4 Stanley Street Longridge	0.01	1	Erection of dwelling following demolition of remains of derelict barn	7/2/13	9	360204 437534	*
3/2012/1010	55 Pendle Road Clitheroe	0.12	2	Erection of detached dwellings - 1 commenced	27/2/13	10	375027 441369	
3/2014/1074	Kemple Barn Whalley Road Pendleton	0.20	1	Proposed dwelling with garages	20/1/15	11	373740	
3/2012/0096				Non-material amendment to amend position of dwelling & garage	13/3/13		440591	
3/2012/0876	Land off Victoria Terrace Mellor Brook	0.32	3	Erection of dwellings	15/3/13	12	364145 431065	
3/2013/0331	197 Ribchester Road Clayton-le-Dale	0.05	1	Erection of bungalow	22/5/13	13	367186 433295	
3/2013/0454	2 Halton Place Longridge	0.02	1	Erection of attached house on side of existing property	1/7/13	14	360755 437548	

SITES WITH FULL PLANNING PERMISSION

APPLICATION NO	LOCATION	SITE AREA (HECTARES)	NO OF DWELLINGS	COMMENTS	DATE OF APPROVAL	MAP NO	NGR	BROWNFIELD SITE
3/2013/0267	Land adj 74 Knowsley Road Wilpshire	0.02	1	Erection of detached dwelling	5/9/13	15	368588 432360	
3/2012/0789	Land opposite Foxhill House Whins Lane Simonstone	0.13	1	Demolition of building & erection of dwelling with Granny Annex	23/5/13	16	377486 435316	*
3/2013/0333	Brook Farm Longsight Road Clayton-le-Dale	0.06	1	Erection of dwelling. (See Conversions 2 dwellings)	7/10/13	17	366771 433345	
3/2013/0513	8 Hammond Drive Read	0.27	2	Erection of detached dwellings	17/10/13	18	376059 434854	
3/2014/0751	8 Hammond Drive Read	0.05	1	Erection of detached dwelling	6/2/15	19	376089 434838	
3/2013/0742	Land between 52 & 54 Knowsley Road Wilpshire	0.06	1	Erection of dwelling	11/11/13	20	368598 432243	
3/2013/1070	Cherry Hall Main Street Grindleton	0.05	1	Erection of dwelling	14/2/14	21	375791 445889	
3/2013/0805	The Abbottoir Clerk Hill Road Whalley	0.12	1	RM for erection of dwelling on Plot 2, See 3/2012/0477 OL for Plot 1	24/2/14	22	375632 437051	*
3/2013/0571	Croftlands Broad Meadow Chipping	0.18	3	Erection of dwellings	3/3/14	23	361809 443288	
3/2012/0488	Land adj Radley Ribblesdale Avenue Clitheroe	0.06	1	Erection of 2 detached dwelling. 1 completed	24/10/12	24	374182 442547	
3/2014/0106	54 Fairfield Drive Clitheroe	0.11	2	Demolition of existing dwelling & erection of dwellings	2/6/14	25	373061 441236	*
3/2014/0536	8 Lancaster Drive Clitheroe	0.04	1	Erection of detached dwelling in garden area	14/8/14	26	373287 441417	
3/2014/0482	Land off Highfield Drive Longridge	0.17	3	Erection of detached dwellings	29/9/14	27	360554 436940	*

SITES WITH FULL PLANNING PERMISSION

APPLICATION NO	LOCATION	SITE AREA (HECTARES)	NO OF DWELLINGS	COMMENTS	DATE OF APPROVAL	MAP NO	NGR	BROWNFIELD SITE
3/2014/0722	The Royal British Legion Townley Road Longridge	0.09	4	Erection of dwellings	14/11/14	28	360261 437418	*
3/2014/0776	9 Fox Street Clitheroe	0.03	1	Erection of detached dwelling	15/12/14	29	374438 442375	
3/2014/0923	Land at Neddy Lane Billington	0.05	1	Erection of dwelling	17/2/15	30	372463 435823	
3/2015/0014	23 Hillcrest Road Langho	0.03	1	Erection of dwelling within curtilage	16/3/15	31	370270 433721	
3/2014/0703	Site of Ten Garages Hambleton View Simonstone	0.04	3	Replace garages with dwellings	15/4/15	32	376803 434450	*
3/2015/0029	Hazelmere Pimlico Road Clitheroe	0.07	3	Erection of dwellings	17/4/15	33	374508 442235	*
3/2015/0187	58 Bushburn Drive Langho	0.03	1	Erection of dwelling in garden	20/4/15	34	370092 434131	
3/2014/1119	The Moorcock Inn Slaidburn Road Waddington	0.34	1	Demolition of Inn and erection of dwelling	14/5/15	35	371914 446632	*
3/2015/0485	Land at Chapel Close Low Moor Clitheroe	0.07	1	Demolition of stable buildings & erection of detached house (Plot 2)	21/7/15	36	373026 442049	
3/2015/0515	Land adj 14 Church Raikie Chipping	0.07	1	Erection of detached dwelling	17/8/15	37	362136 443410	*
3/2015/0411	Prestons Yard Longridge Road Chipping	0.10	4	Erection of dwellings	28/8/15	38	362377 443189	*
3/2015/0366	63 Mitton Road Whalley	0.03	1	Erection of dwelling	9/9/15	39	372601 436738	
3/2015/0250	Plot adj St Leonards Vicarage 11 Whalley Road Billington	0.10	1	Detached house with detached garage	11/9/15	40	372436 435735	

SITES WITH FULL PLANNING PERMISSION

APPLICATION NO	LOCATION	SITE AREA (HECTARES)	NO OF DWELLINGS	COMMENTS	DATE OF APPROVAL	MAP NO	NGR	BROWNFIELD SITE
3/2015/0305	Dunsop Bridge Trout Farm Dunsop Road Dunsop Bridge	0.01	1	Demolition of storage building & erection of rural workers dwelling	29/9/15	41	365784 449786	*
No of Sites 41	TOTAL	4.05	75					

**SITES WITH OUTLINE
PLANNING PERMISSION**

SITES WITH OUTLINE PLANNING PERMISSION

APPLICATION NO	SITE LOCATION	SITE AREA (HECTARES)	NO OF DWELLINGS	COMMENTS	DATE OF APPROVAL	MAP NO	NGR	BROWNFIELD SITES
3/2014/0172	Former LCC Depot Land off Dixon Road Longridge	0.15	9	Redevelopment of land for residential purposes	14/4/14	42	360628 437338	*
3/2011/0719	Land Ribblesdale Avenue Clitheroe	0.06	1	Erection of detached dwellings See 3/2012/0488 full planning permission for 2 dwellings	9/12/11	43	374177 442543	
3/2014/0922	65 Whalley Road Langho	0.09	2	Demolition of existing garage & erection of detached dwellings	5/12/14	44	370353 434604	
3/2012/0698	Grimbaldeston Farm Preston Road Longridge	0.17	4	Erection of bungalows	28/9/12	45	360103 436023	
3/2012/0477	The Abattoir Clerk Hill Road Whalley	0.14	1	Demolition of abattoir & erection of dwellings. See 3/2013/0805 for R/M for Plot 2	19/11/14 8/3/13	46	375621 437044	*
3/2013/0153	1 Durham Drive Wilpshire	0.04	1	Dwelling within curtilage of existing dwelling	30/4/13	47	368884 432854	
3/2014/0859	Land adj Manor Barn Rimington Lane Rimington	0.15	3	Erection of dwellings (See 3/2014/0208 -Full application 1 dwelling) -(Erection of dwelling, Plot 2)	18/7/13	48	380762 445920	
3/2013/0707	Bolton Fold Farm Alston Lane Alston	0.06	1	Erection of dwelling	23/9/13	49	360117 435369	
3/2013/0592	Longsight House Longsight Road Langho	0.19	2	Erection of detached dwellings	22/10/13	50	369186 434344	
3/2013/0815	Land adj 25 Little Lane Longridge	0.07	4	Erection of 1 bed flats	14/2/14	51	360365 437009	
3/2014/0461	115 Kemple View Clitheroe	0.18	3	Erection of dwellings	22/1/15	52	373358 440646	*
3/2014/0547	Land at Bentlea Road Gisburn	0.29	2	Erection of detached dwellings	21/1/15	53	383079 448735	

SITES WITH OUTLINE PLANNING PERMISSION

APPLICATION NO	SITE LOCATION	SITE AREA (HECTARES)	NO OF DWELLINGS	COMMENTS	DATE OF APPROVAL	MAP NO	NGR	BROWNFIELD SITES
3/2014/0738	Tan Yard Lane Longridge	0.16	1	Erection of dwelling	15/5/15	54	361264 437730	
3/2014/0827	39 Clitheroe Road Whalley	0.34	1	Erection of dwelling	21/5/15	55	373484 436890	
No of Sites 14	TOTAL	2.09	35					

SITES ON WHICH DEVELOPMENT HAS
COMMENCED PART OF SITE NOT STARTED

SITES ON WHICH DEVELOPMENT HAS COMMENCED, PART OF SITE NOT STARTED

APPLICATION NO	SITE LOCATION	WHOLE SITE		REMAINDER		MAP NO	NGR	BROWNFIELD SITE
		AREA	DWELLINGS	AREA	DWELLINGS			
6/9/2236*	144 Whalley Road Wilpshire	0.19	3	0.07	1	56	369422 432991	*
3/91/0071#	Weavers Croft Billington	0.65	23	0.03	1	57	372179 435649	*
No of Sites 2	TOTAL	0.84	26	0.10	2			

*Consent for 3 detached houses. 2 houses completed. Only 1 extra dwelling will be added to the housing supply

#Consent for 23 houses. 22 houses are complete. 1 house is outstanding therefore only 1 dwelling will be added to the housing supply

SITES ON WHICH DEVELOPMENT HAS
COMMENCED, UNITS UNDER CONSTRUCTION

SITES ON WHICH DEVELOPMENT HAS COMMENCED, UNITS UNDER CONSTRUCTION

APPLICATION NO	SITE LOCATION	PART OF SITE UNDER CONSTRUCTION	MAP NO	NGR	BROWNFIELD SITE
3/2005/0429	Land at Padiham Road Sabden	0.07	58	377987 437353	*
3/1994/0128	Land adj Alderleigh Henthorn Road Clitheroe	0.05	59	373233 440972	*
3/2007/0246	Hesketh End Judd Holmes Lane Chipping	0.10	60	361261 441140	
3/2006/0586	Land at Higher Highfield Farm Tinklers Lane Slaidburn	0.05	61	372695 452516	
3/2009/0399	Flats 1-7, 33 Kirklands Chipping	0.10	62	362106 443270	*
3/2011/0599	Walter Carefoot Blackpool Road Longridge	0.04	63	359950 437271	*
3/2009/0307	17 & 19 Waverley Road Ramsgreave	0.12	64	368434 431656	
3/2009/0765	26, 26a, 28 Bosburn Drive Mellor Brook	0.11	65	364063 430816	
3/2011/0169	Black Horse Inn Pimlico Road Clitheroe	0.14	66	374881 443202	
3/2010/1014	11 Stubbins Lane Sabden	0.07	67	378058 437440	*
3/2010/0424	Clayton Manor Ribchester Road Wilpshire	0.09	68	368492 432549	
3/2010/0763	Land Severn Street Longridge	0.14	69	360531 437515	*
3/2013/1031	Waterloo House Slaidburn Road Waddington	0.02	70	372775 443964	*

SITES ON WHICH DEVELOPMENT HAS COMMENCED, UNITS UNDER CONSTRUCTION

APPLICATION NO	SITE LOCATION	PART OF SITE UNDER CONSTRUCTION	MAP NO	NGR	BROWNFIELD SITE
3/2013/0844	The Bowling Green Cherry Drive Brockhall Village	0.19	71	370170 436568	*
3/2014/0515 3/2013/0271	42 George Lane Read	0.04	72	376396 434882	
3/2010/0807	Woodbridge, 26A Whalley Road Tavistock, 26B Whalley Road Wilpshire	0.32	73	368829 432027	
3/2013/0587	Elker Croft Whalley Road Billington	0.13	74	371850 435385	
3/2011/0695	Land adj Mount Pleasant Padiham Road Sabden	0.07	75	378117 437271	
3/2014/0107	The Courtyard 249 Preston Road Alston	0.05	76	360094 435392	
3/2014/0331	Plot 1 Springfield Whiteacre Lane Barrow	0.19	77	374131 437904	*
3/2015/0119	Plot 3 Springfield Whiteacre Lane Barrow	0.07	78	374156 437897	
3/2014/0467	128a Whalley Road Langho	0.04	79	370654 434366	*
3/2013/0568	Aintree House 12 Whalley Road Mellor Brook	0.06	80	364142 431223	
3/2012/0185	Victoria Street Garage Victoria Street Clitheroe	0.06	81	373791 441166	*

SITES ON WHICH DEVELOPMENT HAS COMMENCED, UNITS UNDER CONSTRUCTION

APPLICATION NO	SITE LOCATION	PART OF SITE UNDER CONSTRUCTION	MAP NO	NGR	BROWNFIELD SITE
3/2014/0818	Duke William Hotel 30 Chapel Hill Longridge	0.10	82	360483 436751	*
3/2014/0175	20 Brookside Old Langho	0.07	83	370287 436009	
3/2015/0291	Land at Chapel Close (Plot 1) Low Moor Clitheroe	0.06	84	373019 772031	
3/2015/0177	Elker Lodge Whalley Road Billington	0.25	85	371870 435429	
3/2015/0296	Land at Riddings Lane Whalley	0.08	86	373187 436628	*
No of Sites 29		2.88	66		

**CONVERSIONS AND CHANGE OF USE
SITES ON WHICH DEVELOPMENT
HAS NOT COMMENCED**

CONVERSION CHANGE OF USE ~ SITES ON WHICH DEVELOPMENT HAS NOT COMMENCED

SITE LOCATION	SITE AREA	DW	COMMENTS	DATE OF APPROVAL	APPLICATION NO	NGR	BROWNFIELD SITES
Ashgrove Barn 1 Shawbridge Street Clitheroe	0.01	1	Conversion of garage/games room into dwelling	18/12/12	3/2012/0998	374732 441709	*
17 Dilworth Lane Longridge	0.02	1	Conversion of barn to 2 bed dwelling	29/6/15	3/2015/0149	360806 437293	
Lawson House Farm Bolton by Bowland Road Sawley	0.30	1	Conversion of existing barns to 1 dwelling Demolition of redundant agricultural sheds, conversion & extension of existing barns to dwelling	1/11/10 2/10/12	3/2010/0750 3/2011/0729	377186 447138	
Barn adj Shays Cottage Tosside	0.12	2	Conversion of barn to dwellings Renewal of 3/2010/0569 for conversion of barn to 1 dwelling	5/4/12 14/10/13	3/2012/0070 3/2013/0757	375363 453851	
Coach House Trapp Lane Simonstone	0.07	1	Renewal of 3/2010/0626 - Conversion of former coach house to dwelling	25/10/13	3/2013/0796	377647 435644	*
Bay Gate Barn Bolton-by-Bowland	0.15	1	Conversion of barn to dwelling	21/1/14	3/2013/0887	375789 449792	
6 Church Lane Mellor	0.01	1	Change of use of shop & living accommodation to houses	4/2/14 4/9/12	3/2013/1030 3/2012/0603	365116 430750	*
11 New Row Cottages Clitheroe Road Knowle Green	0.07	1	Change of use of garage/home office to dwelling	23/12/14	3/2014/0940 3/2012/0708	364944 438185	*
Mill adj Primrose House Primrose Road Clitheroe	0.02	1	Conversion of former mill building into an apartment	24/10/12	3/2012/0558	373723 440690	*
Stanley House Lowergate Clitheroe	0.11	2	Change of use of offices (B1a) to dwellings	19/11/12	3/2012/0839	374462 441776	*

CONVERSION CHANGE OF USE ~ SITES ON WHICH DEVELOPMENT HAS NOT COMMENCED

SITE LOCATION	SITE AREA	DW	COMMENTS	DATE OF APPROVAL	APPLICATION NO	NGR	BROWNFIELD SITES
Watt Close Farm Burnley Road Gisburn	0.05	1	Conversion of barn to dwelling	20/12/12	3/2012/0983	383358 447115	
Windy Hills Farm Chipping	0.16	2	Conversion of barn to dwellings Conversion of barn to single dwelling	9/1/13 14/5/15	3/2012/0639 3/2015/0158	361951 444611	
Kallets Farm Green Moor Lane Knowle Green	0.03	1	Conversion of barn to dwelling	10/1/13	3/2012/0777	363965 437396	
The Longridge Restaurant 104 Higher Road Longridge	0.07	5	Conversion of restaurant to 2 dwellings Conversion of restaurant into 3 houses and 2 flats	20/5/15 11/3/13	3/2014/1088 3/2012/1077	361147 437725	*
Former Garage Branch Road Waddington	0.01	1	Conversion of former garage to bungalow	4/3/13	3/2013/0064	372869 443932	*
Quarry House Tosside	0.04	1	Conversion of out buildings to dwelling	28/3/13	3/2012/1110	375076 454098	*
Moorfield 4 Wiswell Lane Whalley	0.06	1	Removal of condition 3 (occupancy) of 3/2006/0570P to allow greater flexibility of use	28/3/13	3/2013/0150	373645 436722	*
Bailey Hall Barn Hurst Green	0.20	2	Conversion of barn & outbuildings to dwellings	23/5/13	3/2013/0154	367780 437324	
27-29 Bowlands Clitheroe	0.01	1	Change of use of ground floor from commercial to residential	3/7/13	3/2013/0481	373867 441584	*
Groom's Farm Stirk House Gisburn	0.06	1	Demolition of agricultural building & change of use of out buildings to dwelling	24/7/13	3/2012/1102	381063 448145	
Billingtons Farm Mile Lane Longridge	0.06	2	Conversion of barn to dwellings	22/8/13	3/2012/0778	361125 438285	

CONVERSION CHANGE OF USE ~ SITES ON WHICH DEVELOPMENT HAS NOT COMMENCED

SITE LOCATION	SITE AREA	DW	COMMENTS	DATE OF APPROVAL	APPLICATION NO	NGR	BROWNFIELD SITES
The Rann Saccary Lane Mellor	0.03	1	Conversion of store to dwelling	27/8/13	3/2013/0052	366221 431825	*
Eaves Hall Moor Lane West Bradford	0.25	4	Conversion of stables to 3 units & motor house to 2 units (already 1 unit in motor house)	17/9/13	3/2013/0111	373792 444860	*
Tythe Barn Stables Whins Lane Simonstone	0.30	1	Change of use of existing detached stable block to retirement bungalow	4/10/13	3/2013/0612	377553 435422	*
Halsteads Farm Rimington	0.03	1	Removal condition 5 of 3/2010/0070P to allow holiday cottages to be used as permanent dwellings - 1 complete	14/10/13	3/2013/0693	380925 446069	*
Causeway Farm Longsight Road Osbaldeston	0.17	1	Conversion of barns to dwelling & detached garage	24/10/13	3/2012/1073	364438 431558	
Greengore Farm Hill Lane Hurst Green	0.15	2	Conversion of barn 1 to dwelling Conversion of barn 2 to dwelling	15/11/13	3/2013/0215	367391 438876	
Mill House Farm Chipping Road Chaigley	0.07	1	Change of use of stone barn to dwelling	22/11/13	3/2013/0840	369085 441394	
Whins Barn Sabden	0.12	1	Change of use of existing barn & attached former cottage to dwelling	23/1/14	3/2013/0842	377075 437471	
Brocklehurst Farm Bowland Gate Lane West Bradford	0.10	2	Conversion of barn to dwellings	3/2/14	3/2013/0896	374220 445604	
Field Barn Old Langho Road Old Langho	0.08	1	Change of use from office to residential	13/2/14	3/2013/1065	370107 435364	*

CONVERSION CHANGE OF USE ~ SITES ON WHICH DEVELOPMENT HAS NOT COMMENCED

SITE LOCATION	SITE AREA	DW	COMMENTS	DATE OF APPROVAL	APPLICATION NO	NGR	BROWNFIELD SITES
Garage Premises Back Brennard Street Clitheroe	0.03	3	Conversion of existing garage premises to dwellings	25/3/14	3/2014/0150	374310 442062	*
Elmridge Farm Elmridge Lane Chipping	0.36	4	Conversion of barns to dwellings	29/5/14	3/2013/0691	359564 440599	
47 Preston Road Longridge	0.02	1	Conversion of dwelling to 2 dwellings	17/6/14	3/2014/0263	360098 436991	*
Dewhurst Farm Longsight Road Langho	0.32	2	Conversion of buildings to dwellings	1/7/14	3/2013/0713	368769 433973	
1,2,3,4 Rimington House Rimington Lane Rimington	0.09	4	Change of use to flats	19/9/14	3/2014/0583	380529 445809	*
7 Isle of Man Ramsgreave	0.05	1	Change of use of existing detached garage to dwelling. Sub division of dwelling complete	24/9/14	3/2014/0626	368265 431566	*
Chapel House Farm Preston Road Alston	0.01	1	Conversion of barn to dwelling	9/10/14	3/2014/0410	359728 434752	
Shuttleworth Hall Burnley Road Gisburn	0.03	1	Prior Approval Notification - Class MB(a) for change of use of agricultural building to dwelling	22/1/15	3/2014/0811	382855 448356	
Curtis House Chipping Road Longridge	0.13	1	Conversion of redundant agricultural building to dwelling	12/2/15	3/2014/0425	360385 438866	
West Barn Brows Barn Higher Road Longridge	0.10	1	Conversion of barn to dwelling	27/2/15	3/2014/0671	362146 438367	

CONVERSION CHANGE OF USE ~ SITES ON WHICH DEVELOPMENT HAS NOT COMMENCED

SITE LOCATION	SITE AREA	DW	COMMENTS	DATE OF APPROVAL	APPLICATION NO	NGR	BROWNFIELD SITES
22 Wellgate Clitheroe	0.01	1	Change of use from A4 to new dwelling for premises manager	7/4/15	3/2015/0103	374458 441864	*
Greengates Farm Skipton Road Gisburn	0.03	1	Change of use of agricultural barn to dwelling Prior Notification	5/6/15	3/2015/0338	383957 449156	
New Laithe Skipton Road Gisburn	0.02	1	Change of use of agricultural building to dwelling. Prior Notification	24/6/15	3/2015/0346	387106 450204	
New Hall Barn Blackburn Road Ribchester	0.07	1	Conversion of barn to residential uses. Prior Notification	30/6/15	3/2015/0321	366200 435350	
Pendle Hotel Clitheroe Road Chatburn	0.05	1	Conversion & reconstruction of part of original public house/hotel to form a dwelling	22/7/15	3/2015/1019	376558 443679	*
Dewhurst Farm Longsight Road Langho	0.01	1	Change of use of agricultural building to dwelling. Prior Notification	15/9/15	3/2015/0632	368776 434022	
Barn at Pasture House Farm West Marton	0.02	2	Change of use of agricultural storage building to dwellings. Prior Notification	22/9/15	3/2015/0633	387470 450767	
White Bull Hotel Higher Road Longridge	0.04	7	Change of use & alterations to form 8 apartments - 1 managers apartment already existing	24/9/15	3/2015/0491	360777 437324	*
Barn at Higher House Farm Settle Lane Paythorne	0.04	1	Change of use of agricultural building to dwelling. Prior Notification	29/9/15	3/2015/0661	382901 452199	
No of Sites 50	4.36	80					

**CONVERSIONS AND CHANGE OF USE
SITES ON WHICH DEVELOPMENT
HAS COMMENCED**

CONVERSIONS AND CHANGE OF USE ~ SITES ON WHICH DEVELOPMENT HAS COMMENCED

SITE LOCATION	AREA HA	DW	COMMENCED	BUILDING REGS NO	PLANNING APP NO	NGR	BROWNFIELD
Trough House Farm Lambing Clough Lane Hurst Green	0.04	1	13/5/97	3/1997/0095	3/1995/0474	368675 436779	
The Old School Cottage Forest Becks Farm Forest Becks Bolton-by-Bowland	0.04	1	27/2/07	3/2015/1297 3/2002/0289	3/1997/0571 3/2002/0511	378552 451257	*
Woodfield Barn Woodfields Stonyhurst	0.10	2	2/8/07	3/2007/1166	3/2013/0626 3/2007/0504	369582 439412	
New Barn Whalley Road Stonyhurst	0.13	3	2/8/07	3/2007/1127	3/2013/0625 3/2007/0505	369713 438566	
Horricks Barn Horricks Farm Stonyhurst	0.05	1	3/7/15	3/2015/0898	3/2013/0096	368276 439740	
16,18,18A Well Terrace Clitheroe	0.01	3	7/5/09	3/2009/0983	3/2008/0775	374575 442180	*
Carlinghurst Farm Huntingdon Hall Lane Dutton	0.02	2	31/8/11	3/2011/2216	3/2010/0627	366303 438241	
Pendle Hotel Clitheroe Road Chatburn	0.14	3	12/3/12	3/2011/1831	3/2012/0317	376553 443672	*
Aspinalls Farm/ The Old Barn Kenyon Lane Dinckley	0.04	1	20/4/12	3/2011/3215	3/2011/0675	369420 436111	
New Barn Holden Lane Slaidburn	0.02	1	6/8/12	3/2012/0867	3/2013/0508 3/2010/0194	375714 452239	

CONVERSIONS AND CHANGE OF USE ~ SITES ON WHICH DEVELOPMENT HAS COMMENCED

SITE LOCATION	AREA HA	DW	COMMENCED	BUILDING REGS NO	PLANNING APP NO	NGR	BROWNFIELD
Ox Hey Barn Gisburn Road Sawley	0.06	1	12/12/11	3/2011/3014	3/2012/0579	379771 447700	
2 Chapel School St Nicholas Avenue Sabden	0.09	1	9/12	3/2011/2968	3/2011/0284	377979 437565	*
Rakefoot Farm Thornley Road Chaigley	0.10	1	25/9/12	3/2012/1557	3/2010/1022	366215 441602	
22 Corporation Street Clitheroe	0.01	1	10/12		3/2009/0762	373865 441512	*
44-46 Berry Lane Longridge	0.01	1	24/7/12	3/2012/1434	3/2012/0577	360418 437428	*
The Chapel & The Old School House	0.07	2	22/11/12	3/2012/1960	3/2011/0896	375890 445843	*
Lower Chapel Lane Grindleton							
Carr House Farm Longsight Road Clayton-le-Dale	0.24	2	13/3/14	3/2012/0764	3/2011/0008	365443 432633	
Wyongill Farm Holden Lane Bolton-by-Bowland	0.06	1	6/13	3/2011/1010	3/2011/0633	377295 450459	
Chadwicks Farm Settle Road Bolton-by-Bowland	0.22	1	2/14	3/2013/1431	3/2012/0255	378003 449959	
Out Lane Head Farm Out Lane Chipping	0.06	2	3/14	3/2014/0514	3/2011/0004	360376 443711	
Hothersall Hall Farm Hothersall Lane Ribchester	0.05	1	4/14	3/2012/2091IN	3/2011/0324	363138 434671	

CONVERSIONS AND CHANGE OF USE ~ SITES ON WHICH DEVELOPMENT HAS COMMENCED

SITE LOCATION	AREA HA	DW	COMMENCED	BUILDING REGS NO	PLANNING APP NO	NGR	BROWNFIELD
The Stables Preston Road Alston	0.05	1	26/4/14		3/2011/0951	359928 435464	*
Clough Farm Carters Lane Paythorne	0.33	1	6/6/14	3/2014/0562	3/2011/0278	381130 451286	
Lower Cote Barn Higher Greenhead Farm Gisburn Road Sawley	0.01	1	17/7/14	3/2013/1208	3/2013/0013	378918 446406	
Abbot Barn Back House Lane Chipping	0.07	1	9/14	3/2014/0600IN	3/2011/0887	360898 442491	
Old School House Lane Ends Grindleton	0.04	1	21/1/15	3/2014/1580	3/2015/0142 3/2013/0503	375094 450273	*
Hubbersty Fold Farm Commons Lane Balderstone	0.06	1	3/2/15		3/2011/0625	362953 432149	
Fairclough House Loud Bridge Chipping	0.06	2	3/2/15	3/2014/1585IN	3/2011/0702	359061 441126	*
Brockthorn Tosside	0.02	2	1/15	3/2014/1225	3/2011/1058 3/2010/0693	375853 45514	
25A & 25B Back King Street Clitheroe	0.02	2	2/4/15	3/2014/0769	3/2014/0274	374243 441926	*
No of Sites 30	2.22	44					

**AFFORDABLE HOUSING SITES
NOT STARTED**

AFFORDABLE HOUSING SITES ~ NOT STARTED

SITE LOCATION	SITE AREA	DW	COMMENTS	DATE OF APPROVAL	APPLICATION NO	NGR	BROWNFIELD SITES
Black Bull Hotel Church Street Ribchester	0.05	2	Erection of affordable units	9/6/14	3/2014/0240	364996 435346	*
Land at Whiteacre Lane Barrow	0.20	2	Outline for erection of affordable units	22/8/12	3/2011/0776	374072 437851	
Land at Chapel Hill Longridge	1.03	16	Erection of affordable units	7/11/12	3/2011/1071	360401 436623	
Mearley Croft Woone Lane Clitheroe	0.88	32	Erection of affordable units	20/11/12	3/2011/1064	373992 441116	*
Land off Milton Avenue Clitheroe	0.37	15	Outline erection of affordable units	4/2/13	3/2011/0892	374089 442171	
Land at 23-25 Old Row Barrow	0.34	7	Outline erection of affordable units	27/2/13	3/2012/0623	373876 438431	
Land North & West of Littlemoor Clitheroe	0.54	15	Outline erection of affordable units	12/6/13	3/2012/0420	374205 440887	
Land Accrington Road Whalley	0.89	23	Outline erection of affordable units	25/6/13	3/2012/0179	373587 436021	
Land at Mitton Road Whalley	1.86	41	Full consent for erection of affordable units	27/6/13	3/2012/0637	372734 436416	
Land off Clitheroe Road Barrow	0.26	3	Outline erection of affordable units	13/9/13	3/2013/0511	373634 437794	
Land East of Clitheroe Road (Lawsonsteads) Whalley	1.75	62	Outline erection of affordable units	16/7/13	3/2013/0137	373713 436508	
Strawberry Fields Main Street Gisburn	0.46	11	Reserved Matters for erection of affordable units	28/9/15	3/2015/0370	383294 448988	*
Land off Dale View Billington	0.52	12	Outline erection of affordable units	5/11/13 1/11/13 25/9/15	3/2012/0065 3/2012/0738 3/2014/0779	372515 435974	

AFFORDABLE HOUSING SITES ~ NOT STARTED

SITE LOCATION	SITE AREA	DW	COMMENTS	DATE OF APPROVAL	APPLICATION NO	NGR	BROWNFIELD SITES
Land adj Greenfield Avenue Clitheroe	0.37	8	Outline erection of affordable units	14/11/13	3/2012/0014	373277 441778	
Spout Farm Preston Road Longridge	0.56	10	Outline erection of affordable units	16/1/14	3/2013/0782	360285 436036	
Land off Henthorn Road Clitheroe	1.49	39	Reserved Matters for erection of affordable units	18/9/15	3/2015/0446	373184 440758	
Land to the South-West of Barrow & West of Whalley Road Barrow	5.47	151	Outline erection of affordable units	20/2/14 22/4/14	3/2012/0630 3/2013/0099	373362 438104	
Land to North of Whalley Road Hurst Green	0.73	9	Erection of affordable units	25/3/14	3/2012/0964	368708 438077	
Land at Higher Standen Farm & Part of Littlemoor Farm Clitheroe	13.57	312	Outline erection of affordable units	17/4/14	3/2012/0942	375069 440720	
Hanson Garden Centre Whalley Road Barrow	0.58	13	Outline erection of affordable units	24/6/14	3/2013/0737	373884 438858	*
Land off Waddington Road Clitheroe	2.78	83	Outline erection of affordable units	6/3/15	3/2014/0597	373869 442205	
Land North Dilworth Lane Longridge	3.03	59	Outline erection of affordable units	31/3/15	3/2015/0065	361324 437385	
15 Parker Avenue Clitheroe	0.26	5	Erection of affordable units	2/4/15	3/2014/0666	373963 440921	
Land at Chatburn Road Clitheroe	0.55	7	Erection of affordable units & 1 care unit	10/7/15	3/2013/0981	375229 443021	
Land off Longsight Road Langho	1.50	5	Erection of affordable units	9/7/15	3/2015/0010	370561 434585	
Former garage adj 1 Swinglehurst Cottage Garstang Road Chipping	0.08	1	Variation of condition 3 of 3/2012/1099 to allow holiday let to be occupied as permanent dwelling with restricted occupation as social low cost unit	10/7/15	3/2014/1066	362123 443039	*

AFFORDABLE HOUSING SITES ~ NOT STARTED

SITE LOCATION	SITE AREA	DW	COMMENTS	DATE OF APPROVAL	APPLICATION NO	NGR	BROWNFIELD SITES
Land off Pimlico Link Road Clitheroe	0.24	6	Outline erection of affordable units	30/9/15	3/2014/0742	374958 443258	
No of Sites 2*	40.36	949					

***NOTE:**

24 sites are included in sites over 0.4ha

1 sites are included in sites of less than 0.4ha with planning permission

2 site all affordable units are included in affordable housing sites - not started



HOUSING LAND AVAILABILITY OCTOBER 2015

MAP 1

This map is reproduced from Ordnance Survey material with the permission of Ordnance Survey on behalf of the Controller of Her Majesty's Stationery Office © Crown Copyright. Unauthorised reproduction infringes Crown copyright and may lead to





HOUSING LAND AVAILABILITY OCTOBER 2015

MAP 2

This map is reproduced from Ordnance Survey material with the permission of Ordnance Survey on behalf of the Controller of Her Majesty's Stationery Office © Crown Copyright. Unauthorised reproduction infringes Crown copyright and may lead to



Scale

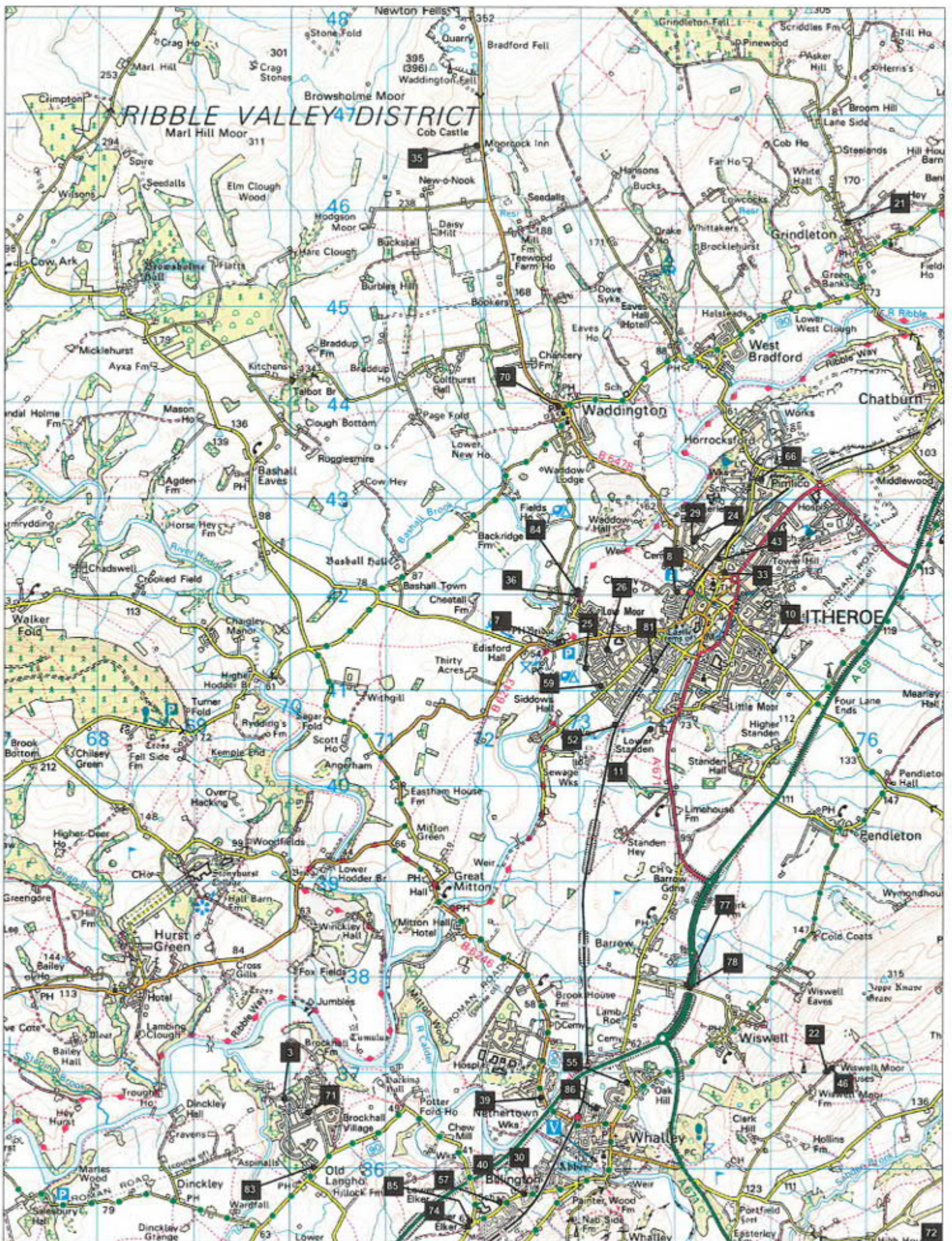

HOUSING LAND AVAILABILITY OCTOBER 2015

MAP 3

This map is reproduced from Ordnance Survey material with the permission of Ordnance Survey on behalf of the Controller of Her Majesty's Stationery Office © Crown Copyright. Unauthorised reproduction infringes Crown copyright and may lead to



Scale



HOUSING LAND AVAILABILITY OCTOBER 2015

MAP 4

This map is reproduced from Ordnance Survey material with the permission of Ordnance Survey on behalf of the Controller of Her Majesty's Stationery Office © Crown Copyright. Unauthorised reproduction infringes Crown copyright and may lead to



Scale



HOUSING LAND AVAILABILITY OCTOBER 2015

MAP 5

This map is reproduced from Ordnance Survey material with the permission of Ordnance Survey on behalf of the Controller of Her Majesty's Stationery Office © Crown Copyright. Unauthorised reproduction infringes Crown copyright and may lead to



Scale



HOUSING LAND AVAILABILITY OCTOBER 2015

MAP 6

This map is reproduced from Ordnance Survey material with the permission of Ordnance Survey on behalf of the Controller of Her Majesty's Stationery Office © Crown Copyright. Unauthorised reproduction infringes Crown copyright and may lead to



Scale